

OFFICE OF THE  
DOUGLAS COUNTY SURVEYOR



C-002  
C-2

27S 6W 22

NAD 577436.10 4148761.27  
83 43°12'52" 123°23'55"

Station: C-2 T 27 S, R 6 W, Sec 22

Set By (Agency): CITY (RSBG)

Date Set: ?

Recovered By JP, RS

Date Recovered 8/24/83

Recovered By RWS SJF

Date Recovered 2000

Recovered By \_\_\_\_\_

Date Recovered \_\_\_\_\_

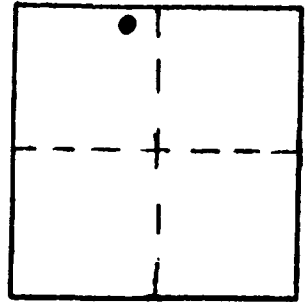

VERTICAL CONTROL NGVD 29 CORPCONG NAVD88 446.96 FT  
Elevation: 443.49 NGS Line # \_\_\_\_\_ USGS Line # \_\_\_\_\_ OSHD Line # \_\_\_\_\_  
Precision: 3RD Agency: DCSO Proj. # 66/38 Date: 2000

HORIZONTAL CONTROL OCS 27  
South Zone State Plane Coordinates: Y(Northing) 577,471.19 X(Easting) 1,227,802.88  
Precision: 1/25,000 Agency: DCSO Proj. # 6012-7 Date: 1977  
Approximate Geographic Position: Latitude 43°12'52.5" Longitude 123°23'50.6"

DESCRIPTION and TO REACH

SKETCH

DESCRIPTION:

A disk stamped "C-2" set in a 9 in. square concrete monument flush with ground.

TO REACH:

From intersection of Calkins Rd. (Co. Rd. #144) and Cloake St. (gravel Rd.) proceed southerly along Cloake Sr. 0.55 miles to monument on left. All in T27S, R6W, Sec.15.

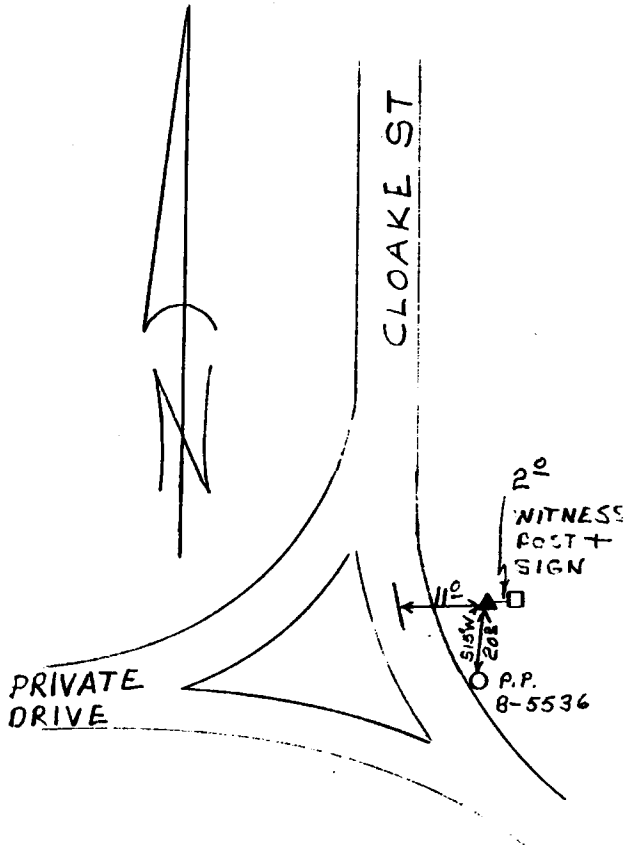

Reference Marks:

Note: For further information, contact the Douglas County Surveyor's Office, Room 205 Douglas County Justice Building, Roseburg, OR 97470. Phone 440-4278. Douglas County residents outside the Roseburg calling area, dial toll free 1-800-452-0991.