

OFFICE OF THE
DOUGLAS COUNTY SURVEYOR

Station: BURKS

T28W R6W Sec. 28

Date Set: 1992

Set By (Agency): RLS #2268

DCSO Designation: B-136

Date Recovered: 3-31-93

Recovered By: SJF RWS

Date Recovered: 9-03

Recovered By: SJF JAP

Date Recovered: _____

Recovered By: _____

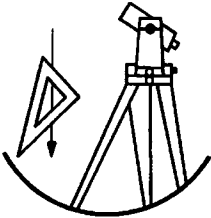
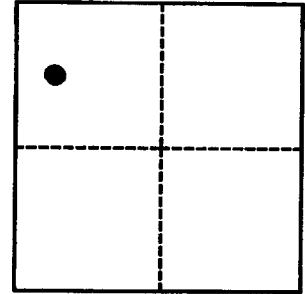

B136

VERTICAL CONTROL NVGD 29

NGVD 29 Elevation: 510.42* FEET

CORCON 6
NAVD 88 Elevation: 513.87 FT - METERS

NGS Line # _____ USGS LINE # _____ OSHD Line # _____ FILE # _____

Precision: 3RD ORDER Agency: RLS #2268 Proj: 1993-0012 A&B Date: 1992

HORIZONTAL CONTROL

O.C.S. 27 Y(Northing): _____ O.C.S. 83 Y(Northing): _____

(South Zone) X(Easting): _____ (South Zone) X(Easting): _____

Precision: _____ Agency: _____ Proj: _____ Date: _____

Approx. O.C.S. 27 Geographic Position: Latitude: _____ Longitude: _____

Approx. O.C.S. 83 Geographic Position: Latitude: _____ Longitude: _____

*** POSSIBLY DISTURBED**

**PLOWING IN AREA
CAP SCARRED**

Found: A 3 inch diameter brass cap set in a 6 inch diameter concrete filled metal tube, flush with the ground. Brass cap stamped "RLS 2268 1992 BURKS".

To Reach: From the intersection of state Hwy 99 and Dillard Garden Rd. (Co. Rd. #101) proceed southwesterly along State Hwy 99 approx. 230 feet to monument on right.

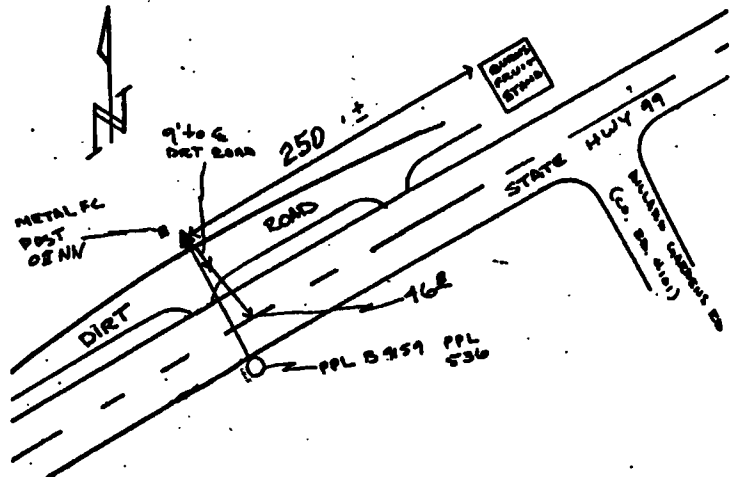

Note: For further information contact the Douglas County Surveyors Office, Room 205 Douglas County Justice Building, Roseburg, OR 97470. Phone 440-4272. Douglas County Residents outside Roseburg calling area, dial toll free 1-800-477-0991.