

OFFICE OF THE  
DOUGLAS COUNTY SURVEYOR

Station: B 747  
 Date Set: 1987  
 Set By (Agency): NGS  
 DCSO Designation: B-131  
 Date Recovered: 8-93  
 Recovered By: SJF RWS  
 Date Recovered: \_\_\_\_\_  
 Recovered By: \_\_\_\_\_  
 Date Recovered: \_\_\_\_\_  
 Recovered By: \_\_\_\_\_

T30W R6W Sec. 24

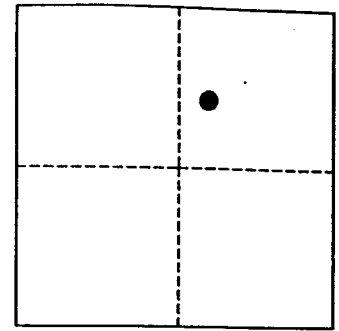
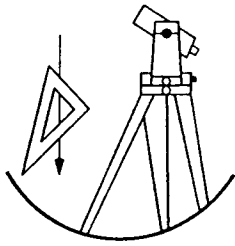

VERTICAL CONTROL

~~NGVD 83~~ <sup>NAVD 88</sup> Elevation: 690.072 FEET      NAVD 88 Elevation: 210.334 METERS  
 NGS Line # 125042      USGS LINE # \_\_\_\_\_      OSHD Line # \_\_\_\_\_      FILE # \_\_\_\_\_  
 Precision: 1ST ORDER      Agency: NGS      Proj: \_\_\_\_\_      Date: 1988

HORIZONTAL CONTROL

~~O.C.S. 27~~ Y(Northing): \_\_\_\_\_      O.C.S. 83 Y(Northing): 481524  
 (South Zone) X(Easting): \_\_\_\_\_      (South Zone) X(Easting): 4156866  
 Precision: GIS SCALED      Agency: DCSO      Proj: \_\_\_\_\_      Date: 2014  
 Approx. O.C.S. 27 Geographic Position:      Latitude: 42°57'06"      Longitude: 123°21'17"  
 Approx. O.C.S. 83 Geographic Position:      Latitude: \_\_\_\_\_      Longitude: \_\_\_\_\_

Found: A 3 - 5/8 inch diameter disk stamped "B 747 1987" set flush in a rock cut bank.

To reach: From the intersection of Main St. (Canyonville-Riddle Rd. (Co. Rd. #21) and First Ave. (Yokum Rd. (Co. Rd. #20A) in T30S R6W Sec24, at Riddle, proceed Northeasterly along First Ave. 0.5 miles to monument on left.

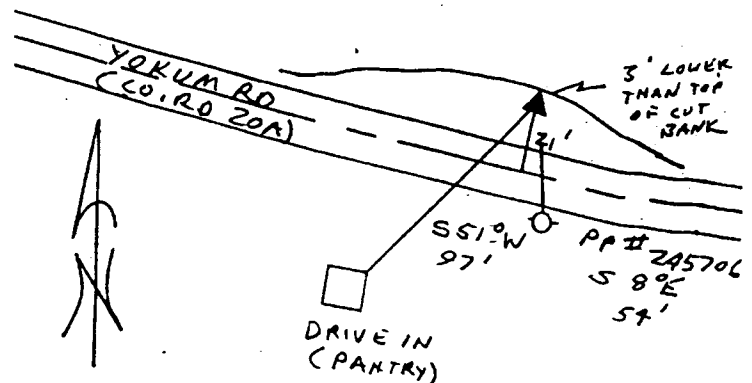

Note: For further information contact the Douglas County Surveyors Office, Room 205 Douglas County Justice Building, Roseburg, OR 97470. Phone 440-4272. Douglas County Residents outside Roseburg calling area, dial toll free 1-800-477-0991.