

OFFICE OF THE  
DOUGLAS COUNTY SURVEYOR

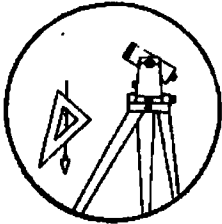

B-113

Station: BEN 26 T 28 S, R 2E, Sec 21  
 Set By (Agency): U.S.G.S.  
 Date Set: 1954  
 Recovered By RWS,SJF  
 Date Recovered Aug. 31, 1987  
 Recovered By \_\_\_\_\_  
 Date Recovered \_\_\_\_\_  
 Recovered By \_\_\_\_\_  
 Date Recovered \_\_\_\_\_

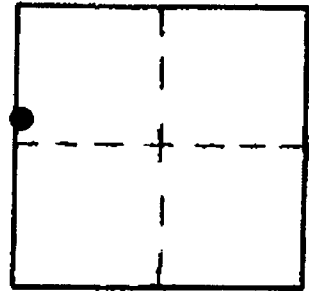

VERTICAL CONTROL NGVD 29 CORPCON 6 NAVD 88 2760.58 FT  
 Elevation: 2756.90 ft. NGS Line # \_\_\_\_\_ USGS Line # 143 OSHD Line # \_\_\_\_\_  
 Precision: 3rd order Agency: USGS Proj. # \_\_\_\_\_ Date: 1965

HORIZONTAL CONTROL  
 South Zone State Plane Coordinates: Y(Northing) \_\_\_\_\_ X(Easting) \_\_\_\_\_  
 Precision: \_\_\_\_\_ Agency: \_\_\_\_\_ Proj. # \_\_\_\_\_ Date: \_\_\_\_\_  
 Approximate Geographic Position: Latitude \_\_\_\_\_ Longitude \_\_\_\_\_

DESCRIPTION and TO REACH

A 3 1/2 inch diameter bronze disk stamped "BEN 26 1954" set in a 6 inch diameter concrete post protruding 4 inches above the ground.

TO REACH:

From the intersection of U.S.F.S. road 28 and spur road 370 in T28S, R2E, Section 21 proceed northwesterly along spur road 370 approximately 1.5 miles to monument on right. Monument is near edge of dirt track road extending beyond end of main graveled road.

Reference Marks:

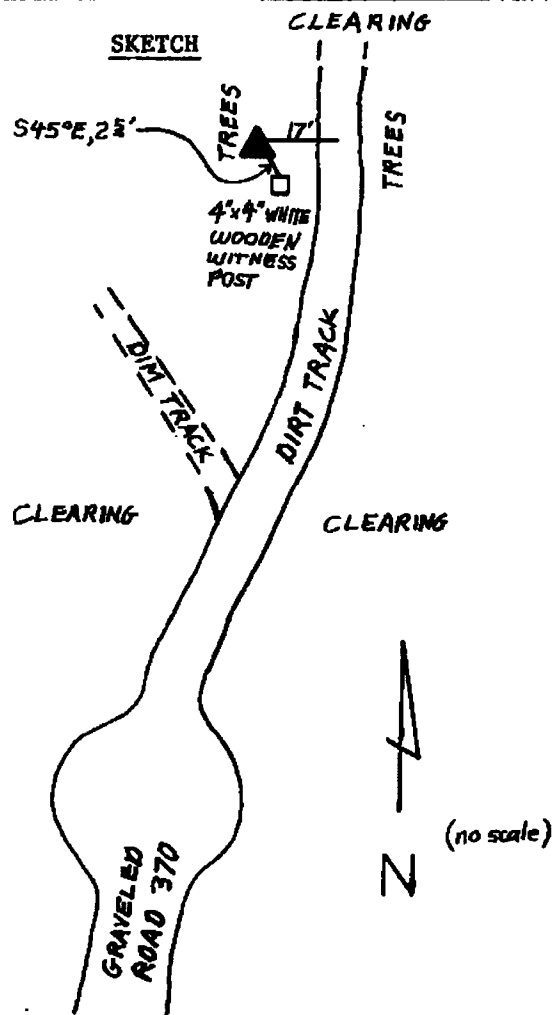

Note: For further information, contact the Douglas County Surveyor's Office, Room 205 Douglas County Justice Building, Roseburg, OR 97470. Phone 440-4278. Douglas County residents outside the Roseburg calling area, dial toll free 1-800-452-0991.