

OFFICE OF THE
DOUGLAS COUNTY SURVEYOR

Station: BRANCH T 28 S, R 5 W, Sec 32

Set By (Agency): DCSO

Date Set: 1974

Recovered By RS, PB

Date Recovered 11/14/83

Recovered By _____

Date Recovered _____

Recovered By _____

Date Recovered _____

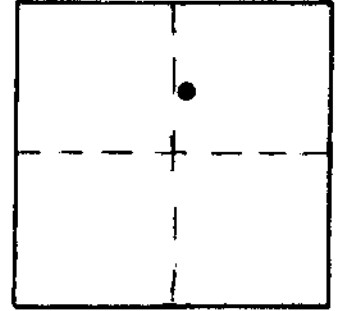

b-088
BRANCH

28S 5W 32

NAD 532908.66 4169658.00
83 43° 5'39" 123°18'53"

VERTICAL CONTROL

Elevation: _____ NGS Line # _____ USGS Line # _____ OSHD Line # _____

Precision: _____ Agency: _____ Proj. # _____ Date: _____

HORIZONTAL CONTROL **OCS 27**

South Zone State Plane Coordinates: Y(Northing) 532,943.90 X(Easting) 1,248,699.95

Precision: 1/25,000 Agency: DCSO Proj. # 2004-5 (CS 56/45) Date: 1974

Approximate Geographic Position: Latitude 43°05'40" Longitude 123°14'48"

DESCRIPTION and TO REACH

SKETCH

DESCRIPTION:

A disk stamped "BRANCH 1974" set flush on a sawed off power pole 8 in. above ground.

TO REACH:

From the intersection of Clarks Branch Rd. (Co. Rd. #105, exit #112) and I-5 in T29S, R6W, Sec.1; proceed easterly along Clarks Branch Rd. 2.8 miles to monument on right.

Reference Marks:

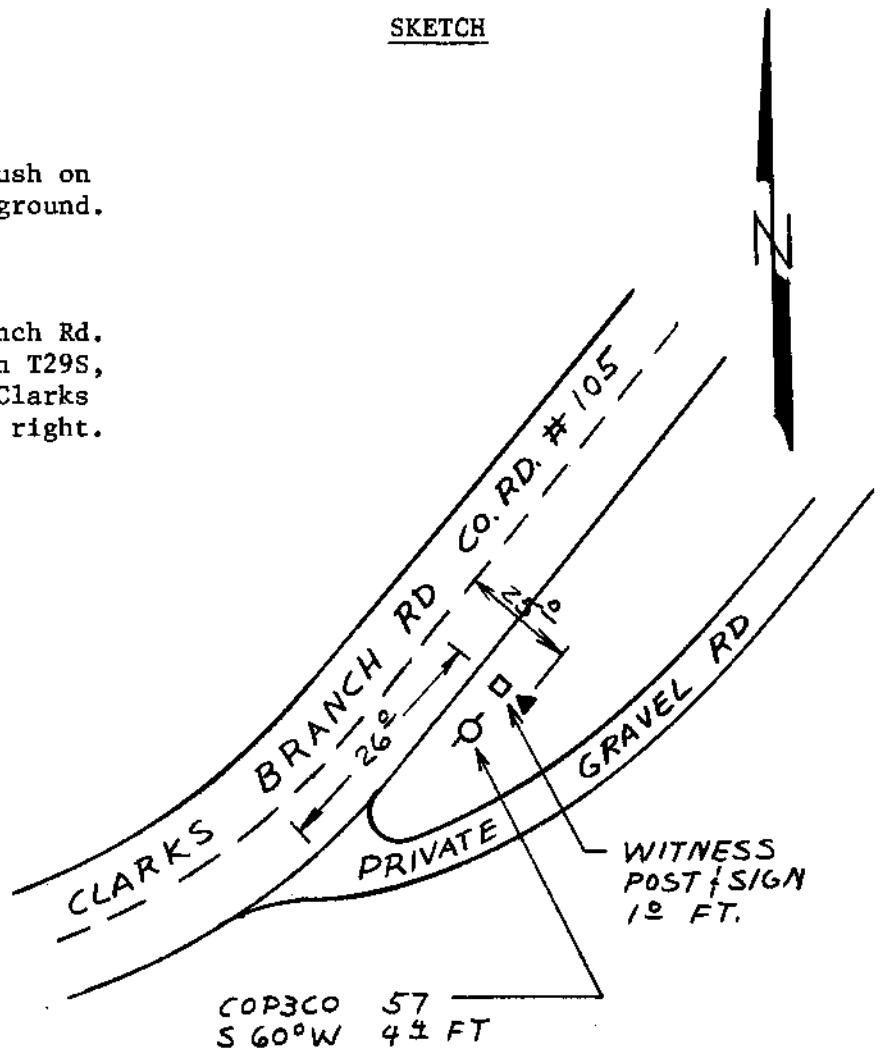

Note: For further information, contact the Douglas County Surveyor's Office, Room 205 Douglas County Justice Building, Roseburg, OR 97470. Phone 440-4278. Douglas County residents outside the Roseburg calling area, dial toll free 1-800-452-0991.