

OFFICE OF THE
DOUGLAS COUNTY SURVEYOR

Station: BOND T 27 S, R 3 W, Sec 11

Set By (Agency): DCSO

Date Set: 1972

Recovered By RWS, SJF

Date Recovered 11/19/84

Recovered By TF

Date Recovered 1/30/92

Recovered By RWS SJF / 1999

Date Recovered _____

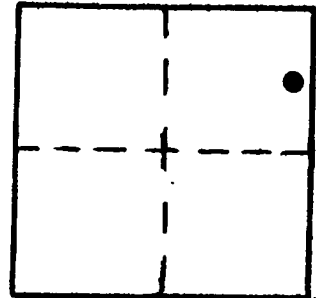

b-078
BOND

27S 3W 11

NAD 582967.90 4252217.48
83 43°14'20" 123° 0'41"

VERTICAL CONTROL NGVD 29 CORPCON 6 NAVD 88 902.93 FT
Elevation: ~~898.8~~ 899.33 NGS Line # _____ USGS Line # _____ OSHD Line # _____
Precision: ~~3rd~~ 3rd Agency: DCSO Proj. # 2000 CS66/56 Date: 1992 1999

HORIZONTAL CONTROL NAD 27
South Zone State Plane Coordinates: Y(Northing) 583,004.10 X(Easting) 1,331,257.68
Precision: 1/25,000 Agency: DCSO Proj. # 2004-1 CS#57/3 Date: 1978
Approximate Geographic Position: Latitude 43°14'20" Longitude 123°00'36"

DESCRIPTION and TO REACH

SKETCH

A DCSO disk stamped "BOND 1972" set in a
8 in. diam. concrete filled belltile.

TO REACH:

Go to the intersection of Little River Rd.
(Co.Rd.#17) and New Bridge Rd. (Co.Rd.#82A)
in T27S,R3W,Sec.11; monument is in southeast
corner of intersection.

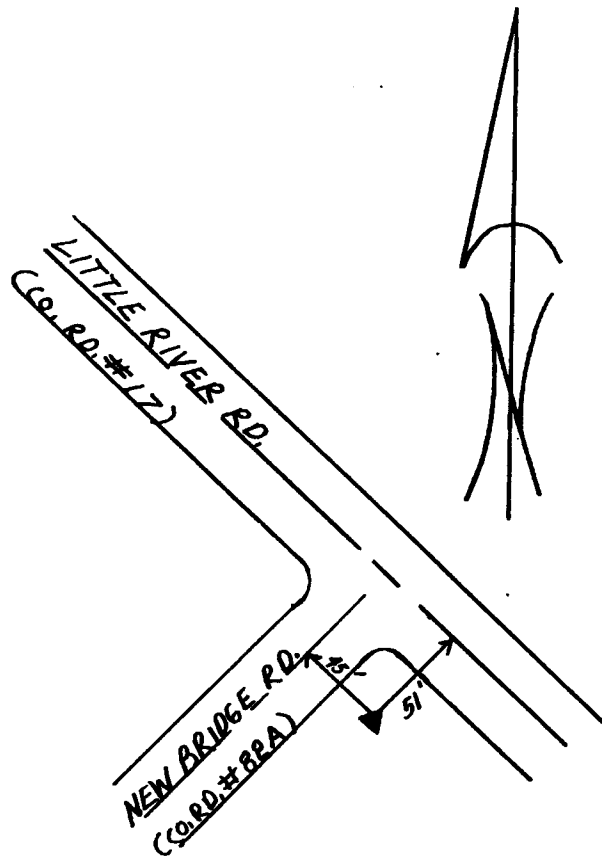

Reference Marks:

Note: For further information, contact the Douglas County Surveyor's Office, Room 205
Douglas County Justice Building, Roseburg, OR 97470. Phone 440-4278. Douglas
County residents outside the Roseburg calling area, dial toll free 1-800-452-0991.