

OFFICE OF THE  
DOUGLAS COUNTY SURVEYOR

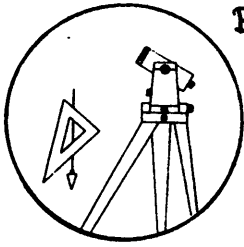

B-074

Station: B.M. WAD. T 30 S, R 6W, Sec 24  
 Set By (Agency): EUGENE A. BLOOM /RLS 492  
 Date Set: 1984  
 Recovered By RSW, SJF  
 Date Recovered JAN. 28, 1985  
 Recovered By \_\_\_\_\_  
 Date Recovered \_\_\_\_\_  
 Recovered By \_\_\_\_\_  
 Date Recovered \_\_\_\_\_

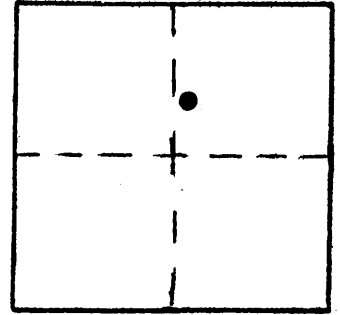

VERTICAL CONTROL NGVD 29

Elevation: 677.00 NGS Line # \_\_\_\_\_ USGS Line # \_\_\_\_\_ OSHD Line # \_\_\_\_\_  
 Precision: 3rd Agency: AA Surveying Proj. # M-97-53 Date: 1984  
 RLS/492

HORIZONTAL CONTROL

South Zone State Plane Coordinates: Y(Northing) \_\_\_\_\_ X(Easting) \_\_\_\_\_  
 Precision: \_\_\_\_\_ Agency: \_\_\_\_\_ Proj. # \_\_\_\_\_ Date: \_\_\_\_\_  
 Approximate Geographic Position: Latitude \_\_\_\_\_ Longitude \_\_\_\_\_

DESCRIPTION and TO REACH

DESCRIPTION:

A 2 3/8" disk stamped "B.M. WAD. ELEV. 677.00 RLS 492 "set in a 1 Ft. dia. bell up concrete filled bell tile, flush with ground.

TO REACH:

From the intersection of First Ave. (Co. Rd. #20A) and Harbor Lane in Riddle T30S, R6W, Sec. 24, proceed easterly along Co. Rd. #20A approx. 500 Ft. to monument on right.

SKETCH

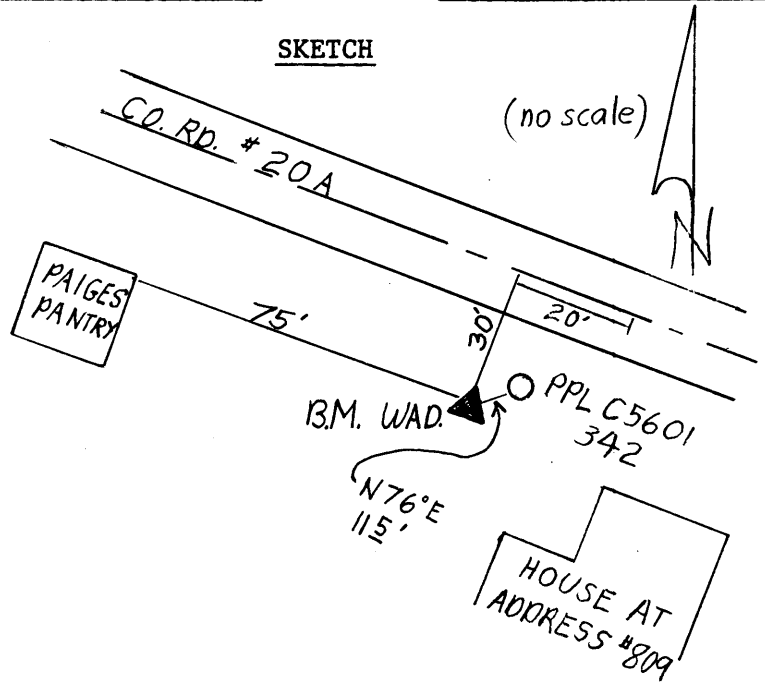

Reference Marks:

Note: For further information, contact the Douglas County Surveyor's Office, Room 205 Douglas County Justice Building, Roseburg, OR 97470. Phone 440-4278. Douglas County residents outside the Roseburg calling area, dial toll free 1-800-452-0991.