

**DOUGLAS COUNTY SURVEYOR'S OFFICE**

Designation: B-072 Station: BM DMB T 28S R 6W S 3 1/4 SE

Date Set: 1980 Set by (Agency): GEE (RLS 1191)

Date Recovered: 1/9/03 Recovered by: RWS, SJF

- |   |                                     |                                    |
|---|-------------------------------------|------------------------------------|
| <input checked="" type="checkbox"/> Found | <input type="checkbox"/> New        | <input type="checkbox"/> Reset     |
| <input type="checkbox"/> Not Found        | <input type="checkbox"/> Referenced | <input type="checkbox"/> Destroyed |

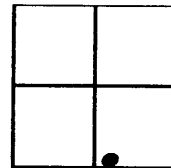

VERTICAL CONTROL

NGVD 29 Elevation: 483.781 Feet File # \_\_\_\_\_  
 Precision: 2nd Agency: DCSO Project: 2013 M84-37 Date: 1985  
 NAVD 88 Elevation: \_\_\_\_\_ Meters File # \_\_\_\_\_  
 Precision: \_\_\_\_\_ Agency: \_\_\_\_\_ Project: \_\_\_\_\_ Date: \_\_\_\_\_  
CS 66/61

HORIZONTAL CONTROL - south zone

N _____	E _____	Datum/Adj.: <u>1927</u>	Precision: <u>SCALED</u>
Lat: <u>43° 09' 23"</u>	Long: <u>123° 23' 27"</u>	Agency: <u>DCSO</u>	File # _____ Date: _____
N _____	E _____	Datum/Adj.: _____	Precision: _____
Lat: _____	Long: _____	Agency: _____	File # _____ Date: _____
N _____	E _____	Datum/Adj.: _____	Precision: _____
Lat: _____	Long: _____	Agency: _____	File # _____ Date: _____
N _____	E _____	Datum/Adj.: _____	Precision: _____
Lat: _____	Long: _____	Agency: _____	File # _____ Date: _____

DESCRIPTION AND TO REACH

DISK STAMPED "BM DMB ELEV. 483.771 1980 PLS 1191" SET IN 7" DIA. CONCRETE FILLED METAL PIPE 6" BELOW GROUND.

GO TO THE INTERSECTION OF AUSTIN RD (CO. RD #207) AND STELLA STREET (CO. RD #246) IN GREEN, T 28S R 6W SEC. 3. MOVEMENT IS OFF ROAD IN NORTHWEST CORNER OF INTERSECTION

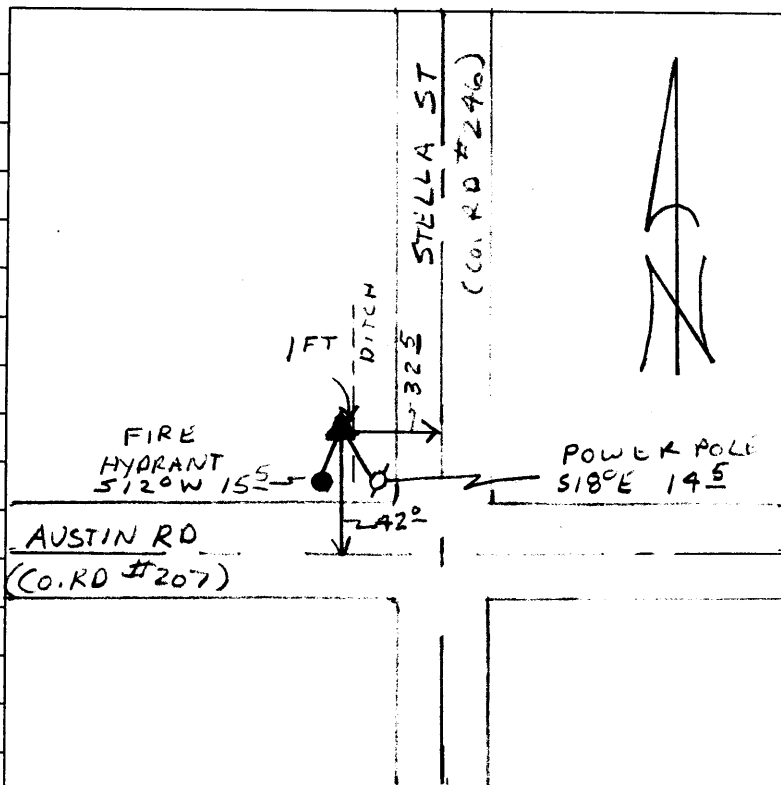

NOTE: PREVIOUSLY REPORTED AS DESTROYED