

OFFICE OF THE
DOUGLAS COUNTY SURVEYOR

B-066

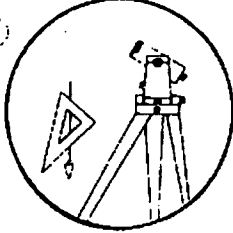

Station: BM 24 0000 T 23 S, R 4 W, Sec 15

Set By (Agency): USC&GS

Date Set: 1917

Recovered By RWS,SJF

Date Recovered 9/87

Recovered By _____

Date Recovered _____

Recovered By _____

Date Recovered _____

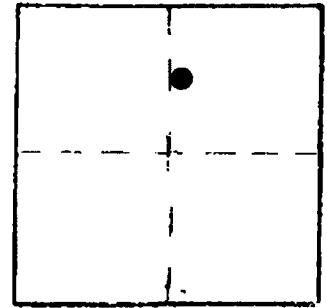

VERTICAL CONTROL CORPCON 6 NAVD 88 959.42 FT

Elevation: 955.72 NGS Line # 205 USGS Line # _____ OSHD Line # _____

Precision: 3rd Agency: USC&GS Proj. # _____ Date: 1947

HORIZONTAL CONTROL

South Zone State Plane Coordinates: Y(Northing) _____ X(Easting) _____

Precision: _____ Agency: _____ Proj. # _____ Date: _____

Approximate Geographic Position: Latitude _____ Longitude _____

DESCRIPTION and TO REACH

A 3 3/4 in. dia. USC&GS disk stamped "955 1917 24" on a 3 in. O.D. iron pipe protruding 10 in. above ground.

From the intersection of Co.Rd.#7 (Elkhead Rd.) and Co.Rd.#8 (Scotts Valley Rd.) in T23S,R4W,Sec.21, proceed northeasterly along Co.Rd.#8 approx. 1.8 miles to monument on left.

SKETCH

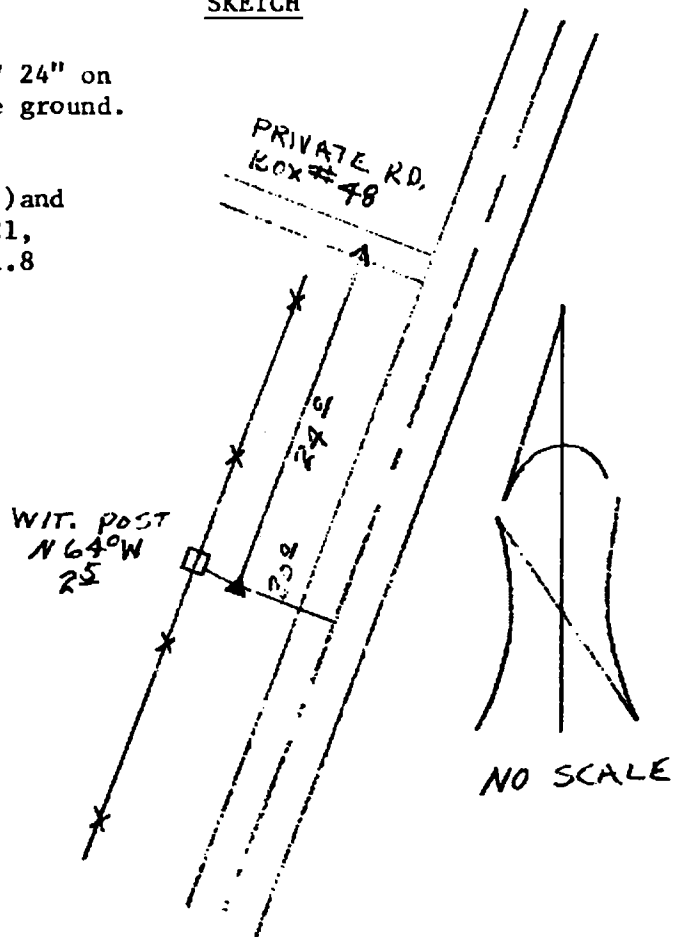

Reference Marks:

Note: For further information, contact the Douglas County Surveyor's Office, Room 205 Douglas County Justice Building, Roseburg, OR 97470. Phone 440-4278. Douglas County residents outside the Roseburg calling area, dial toll free 1-800-452-0991.