

OFFICE OF THE
DOUGLAS COUNTY SURVEYOR

B-028

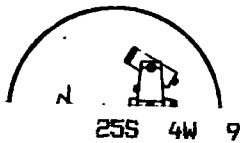

b-028
BANKS

NAD 83 645086.57 4209455.99
43°24'20" 123°10'45"

Station: BANKS T 25 S, R 4 W, Sec 9
Set By (Agency): USC&GS
Date Set: 1971
Recovered By RWS,SJF
Date Recovered 3/6/87
Recovered By _____
Date Recovered _____
Recovered By _____
Date Recovered _____

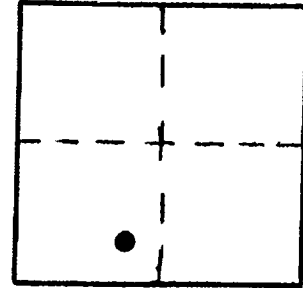

VERTICAL CONTROL NGVD 29 CORPCOM 6 NAVD 88 670.67 FT
Elevation: 667.10 NGS Line # _____ USGS Line # _____ OSHD Line # _____
Precision: 3rd Agency: DCSO Proj. # 2007 Date: 1990

HORIZONTAL CONTROL OC529
South Zone State Plane Coordinates: Y(Northing) 645,121.66 X(Easting) 1,288,495.74
Precision: 1/25,000 Agency: DCSO Proj. # 0002 Date: 1974
Approximate Geographic Position: Latitude 43°24'20" Longitude 123°10'41"

DESCRIPTION and TO REACH

A USC&GS 3 3/4 in. dia. disk stamped "BANKS
1953 1971" set in small rock outcrop flush
with ground.

TO REACH:

From the intersection of Banks Creek Rd.
(Co. Rd. 45) and Nonpariel Rd. (Co. Rd. #19)
in T25S,R4W,Sec.9, proceed westerly along Nonpariel
Rd. 0.15 miles to monument on right.

SKETCH

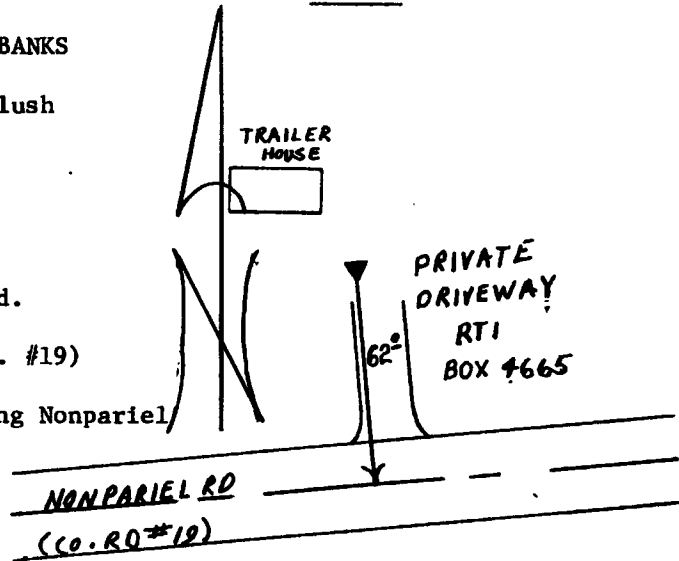

Reference Marks:

Note: For further information, contact the Douglas County Surveyor's Office, Room 205 Douglas County Justice Building, Roseburg, OR 97470. Phone 440-4278. Douglas County residents outside the Roseburg calling area, dial toll free 1-800-452-0991.