

OFFICE OF THE  
DOUGLAS COUNTY SURVEYOR

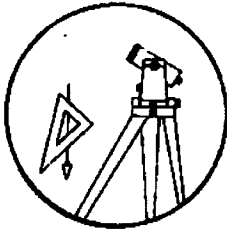

B-015

Station: B 611 T 28 S, R 6 W , Sec 25  
 Set By (Agency): O.S.H.D.  
 Date Set: 1967  
 Recovered By RS, SJF  
 Date Recovered June 20, 1984  
 Recovered By \_\_\_\_\_  
 Date Recovered \_\_\_\_\_  
 Recovered By \_\_\_\_\_  
 Date Recovered \_\_\_\_\_

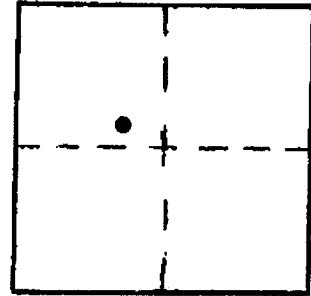

VERTICAL CONTROL **NGVD 29** CORPCONG NAVD88 898.14 FT  
 Elevation: 894.67 NGS Line # \_\_\_\_\_ USGS Line # \_\_\_\_\_ OSHD Line # 369  
 Precision: 3rd Agency: O.S.H.D. Proj. # \_\_\_\_\_ Date: 1977

HORIZONTAL CONTROL  
 South Zone State Plane Coordinates: Y(Northing) \_\_\_\_\_ X(Easting) \_\_\_\_\_  
 Precision: \_\_\_\_\_ Agency: \_\_\_\_\_ Proj. # \_\_\_\_\_ Date: \_\_\_\_\_  
 Approximate Geographic Position: Latitude \_\_\_\_\_ Longitude \_\_\_\_\_

DESCRIPTION and TO REACH

An O.S.H.D. disk stamped "B 611 1967"  
set in a 12"x12" concrete post flush with  
ground.

TO REACH:

From the intersection Clarks Branch Rd.  
( Co. Rd. #105 ) and Interstate Highway 5  
in T29S, R6W, Sec. 1: proceed northwesterly  
along I-5 approximately 2.75 miles to monument  
on right.

SKETCH

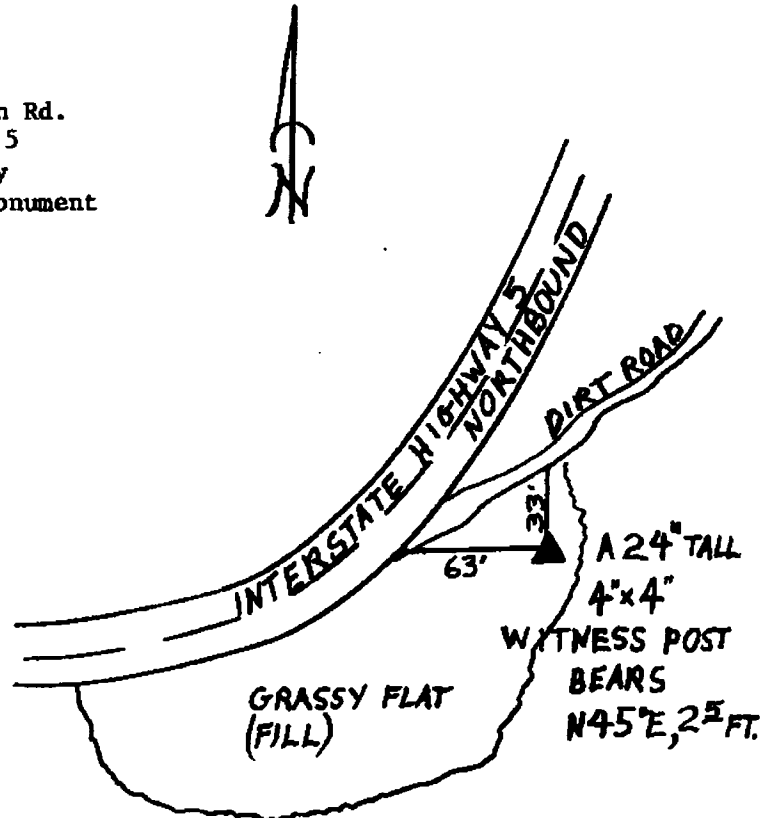

Reference Marks:

Note: For further information, contact the Douglas County Surveyor's Office, Room 205  
Douglas County Justice Building, Roseburg, OR 97470. Phone 440-4278. Douglas  
County residents outside the Roseburg calling area, dial toll free 1-800-452-0991.