

OFFICE OF THE  
DOUGLAS COUNTY SURVEYOR  
B-013

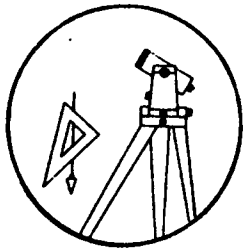

Station: . B 554 T 29 S, R 6 W , Sec 12  
 Set By (Agency): U.S.C. & G.S.  
 Date Set: 1954  
 Recovered By RS, SJF  
 Date Recovered June 19, 1984  
 Recovered By \_\_\_\_\_  
 Date Recovered \_\_\_\_\_  
 Recovered By \_\_\_\_\_  
 Date Recovered \_\_\_\_\_

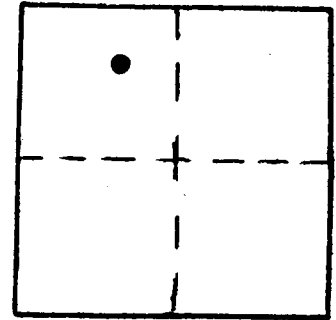

VERTICAL CONTROL CORPSCON6 NAVD88 574.705 FT.

Elevation: 571.265 Ft. NGS Line # 6 USGS Line # \_\_\_\_\_ OSHD Line # \_\_\_\_\_  
 Precision: 1st. Agency: U.S.C. & G.S. Proj. # \_\_\_\_\_ Date: 1957

HORIZONTAL CONTROL

South Zone State Plane Coordinates: Y(Northing) 523499 X(Easting) 4157575  
 Precision: GIS SCALED Agency: DCSO Proj. # \_\_\_\_\_ Date: 2014  
 Approximate Geographic Position: Latitude \_\_\_\_\_ Longitude \_\_\_\_\_

DESCRIPTION and TO REACH

A U.S.C. & G.S. disk stamped "B 554 1954"  
 set flush in the northwest corner of a concrete  
 northerly headwall.

TO REACH:

From the intersection of the Southern  
 Pacific Rail Road tracks and Weigle Road  
 (Co. Rd. #14A) in T29S, R6W, Sec. 12, pro-  
 ceed southeasterly along S.P.R.R. tracks  
 approximately 0.3 miles to monument  
 on left.

SKETCH

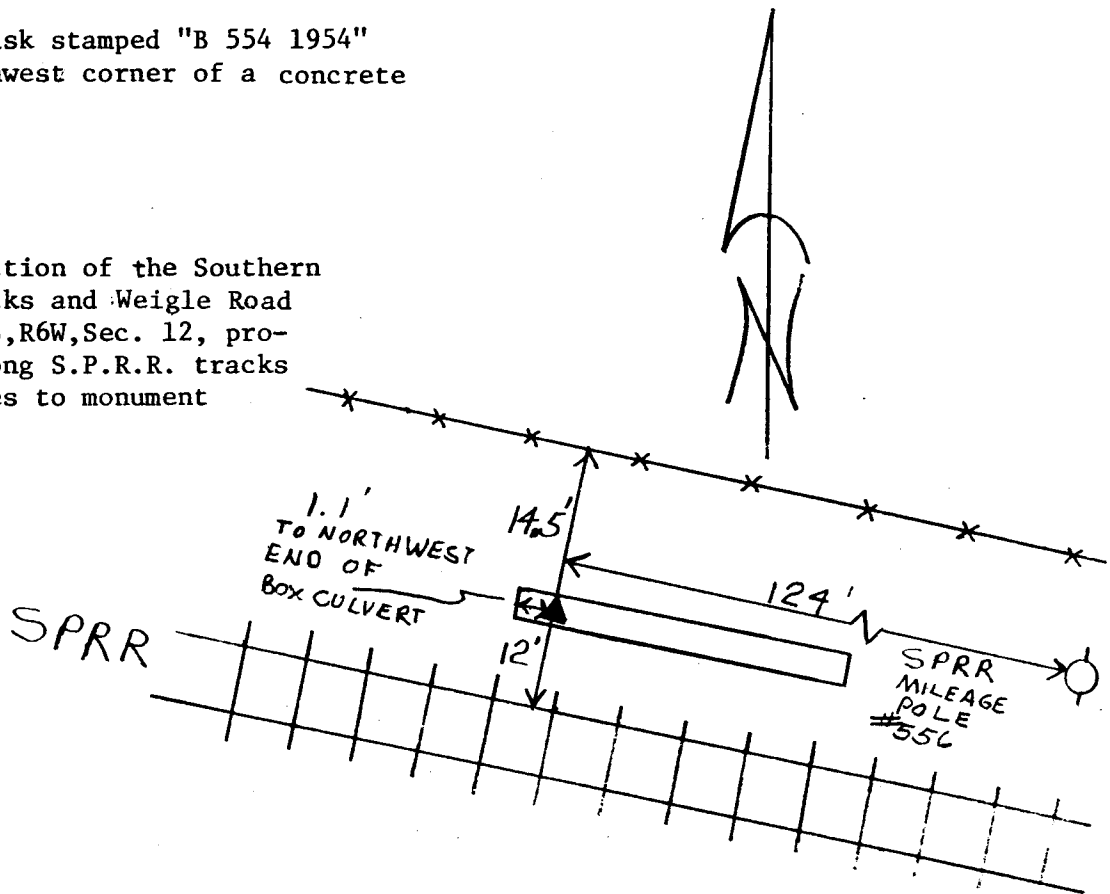

Reference Marks:

Note: For further information, contact the Douglas County Surveyor's Office, Room 205  
 Douglas County Justice Building, Roseburg, OR 97470. Phone 440-4278. Douglas  
 County residents outside the Roseburg calling area, dial toll free 1-800-452-0991.