

OFFICE OF THE
DOUGLAS COUNTY SURVEYOR

Station: B 9 T 27 S, R 6 W, Sec 10

Set By (Agency): CITY(RSBG)

Date Set: 1967

Recovered By JP,RS

Date Recovered 8/12/83

Recovered By _____

Date Recovered _____

Recovered By _____

Date Recovered _____

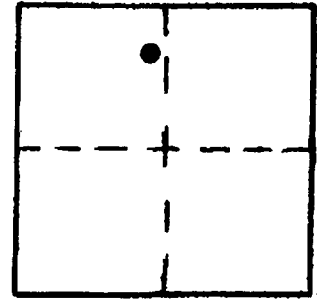

b-005
B 9

27S 6W 10

NAD 587089.82 4149069.21
83 43°14'27" 123°23'55"

VERTICAL CONTROL NGVD 29 CORPCON 6 NAVD 88 432.205 FT

Elevation: 428.762 NGS Line # _____ USGS Line # _____ OSHD Line # _____

Precision: 2nd Agency: DCSO Proj. # 2007 Date: 1990

HORIZONTAL CONTROL OCS 27

South Zone State Plane Coordinates: Y(Northing) 587,124.89 X(Easting) 1,228,110.87

Precision: 1/25,000 Agency: DCSO Proj. # 6012-7,CS 59/33 Date: 1977

Approximate Geographic Position: Latitude 43°14'28" Longitude 123°23'51"

DESCRIPTION and TO REACH

SKETCH

DESCRIPTION:

A disk stamped "B 9" set flush in a 9" square concrete post flush with ground.

TO REACH:

From the intersection of Garden Valley Rd. (Co. Rd. #6), and Melrose Rd. (Co. Rd. #167) proceed westerly along Melrose Rd. approx. 400 ft. to station of left. Station is at the intersection of Melrose Rd. and Jones Rd.

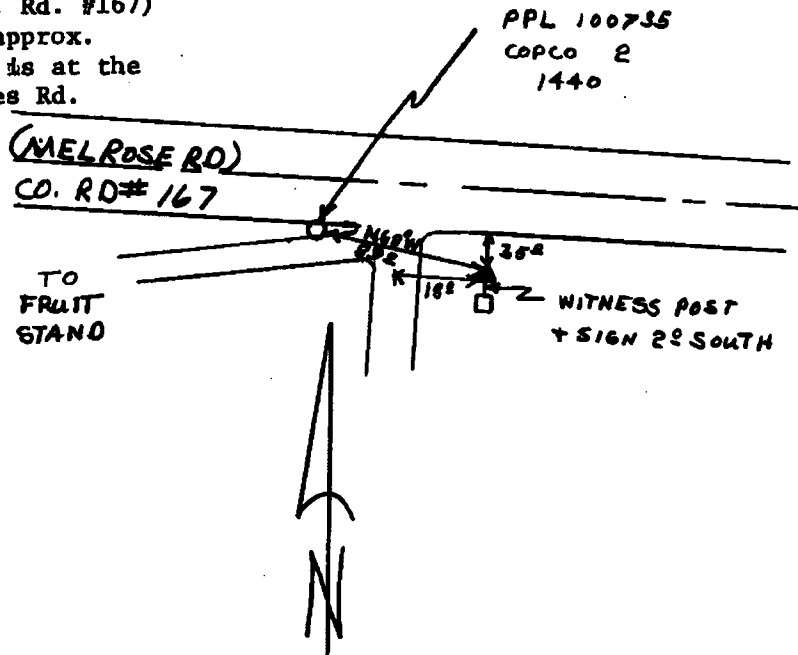

Reference Marks:

Note: For further information, contact the Douglas County Surveyor's Office, Room 205 Douglas County Justice Building, Roseburg, OR 97470. Phone 440-4278. Douglas County residents outside the Roseburg calling area, dial toll free 1-800-452-0991.