

12/3/81

OFFICE OF THE

A-058  
APPY

268 4W 15

DOUGLAS COUNTY SURVEYOR

NAD 607607.78 4211987.55  
83 43°18'10" 123° 9'54"

T 26 S, R 4 W, Sec. 15

Station: APPY

Set By (Agency): DCSSO

Date: 1980

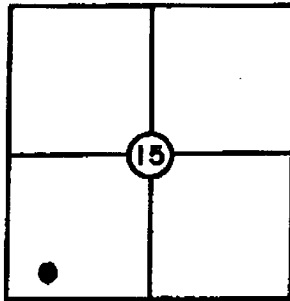

CORPCON 6 NAVD 88  
754.57 FT

VERTICAL CONTROL

NGVD 29

Elevation: 751.01 NGS(USC&GS) Line. # \_\_\_\_\_ USGS Line # \_\_\_\_\_

Order Of Precision 3rd Agency: DCSSO Proj. #: 2007 Date: 1992

HORIZONTAL CONTROL

OCS 27

Oregon State Plane Coordinates: Y(Northing) 607,643.22 X(Easting) 1,291,027.76  
(South Zone)

Order Of Precision 1/10,000 Agency: DCSSO Proj. #: 6012-12 CS#61/13 Date: 1980

Approximate Geographic Position: Latitude= 43°18'11" Longitude=123°09'50"

DESCRIPTION: STATION MARK IS A STANDARD DOUG-

LAS COUNTY SURVEYORS OFFICE BRASS CAP  
STAMPED "APPY 1980". CAP IS SET IN A  
6"x40" CONCRETE BELL TILE FILLED WITH  
CONCRETE, BURIED WITH 6" ABOVE GROUND.

MONUMENT IS SET 4 1/2 FEET NORTH OF N.  
EDGE OF PAVEMENT, 106 FEET WESTERLY OF  
EAST END OF GUARD RAIL ALONG N. EDGE OF  
CO. RD. #4. MONUMENT IS 16 FEET ABOVE  
NORTHERLY R/W FENCE AND 40 1/2 FEET  
SOUTHERLY FROM NORTH'LY R/W FENCE.  
CO. RD. R/W MARKER "679+00 90" BEARS  
N45°W 54 FEET. CENTERLINE OF WHISTLERS  
LANE ROAD IS EASTERLY ABOUT 460 FEET.

VICINITY: 13.2 MILES NE OF ROSEBURG

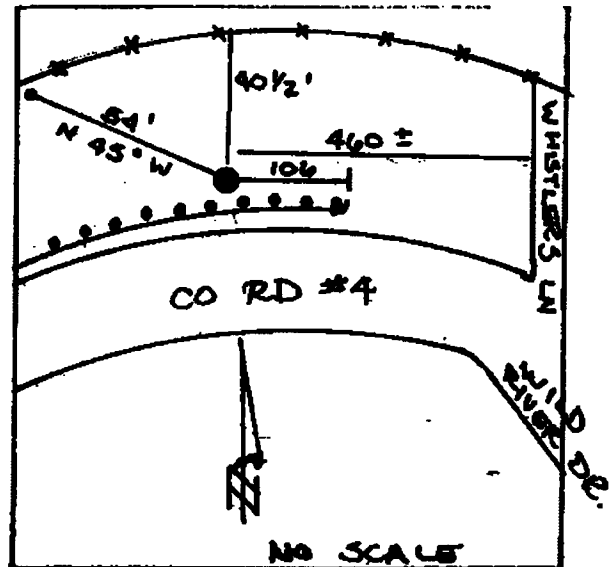

NOTE: For Possible Further Information On This Station, Please Contact The Douglas County Surveyors Office, Rm. 205 Douglas County Justice Bldg., Roseburg, OR. 97470 Phone 672-3311 Ext. 272. Douglas County residents outside the Roseburg calling area dial toll free 1-800-452-0991.