

OFFICE OF THE
DOUGLAS COUNTY SURVEYOR

Station: ANDREA
 Set By (Agency): CITY (RSBG)
 Date Set: ? 82
 Recovered By KR, TP
 Date Recovered 5/82
 Recovered By _____
 Date Recovered _____
 Recovered By _____
 Date Recovered _____

T 27 S, R 6 W, Sec 10

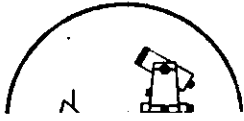

a-04B
ANDREA

NAD 584360.42 4151624.59
 83 43°14' 1" 123°23'19"

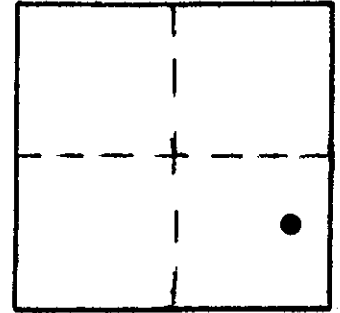

VERTICAL CONTROL

Elevation: _____ NGS Line # _____ USGS Line # _____ OSHD Line # _____
 Precision: _____ Agency: _____ Proj. # _____ Date: _____

HORIZONTAL CONTROL OCS 27

South Zone State Plane Coordinates: Y(Northing) 584,395.51 X(Easting) 1,230,666.24
 Precision: 1/20,000 Agency: DCSO Proj. # 2005-2 Date: 1983
 Approximate Geographic Position: Latitude 43°14'02" Longitude 123°23'15"

DESCRIPTION and TO REACH

SKETCH

DESCRIPTION:

A DCSO disk stamped "ANDREA 1982"
set flush in concrete curb.

TO REACH:

Go to intersection of NW Sunberry Dr.
and NW Andrea Dr.

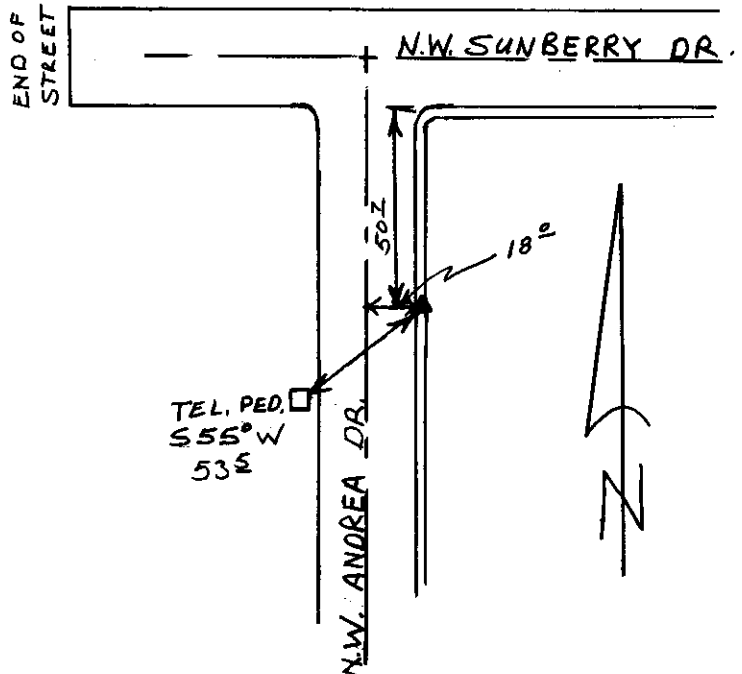

Reference Marks:

Note: For further information, contact the Douglas County Surveyor's Office, Room 205 Douglas County Justice Building, Roseburg, OR 97470. Phone 440-4278. Douglas County residents outside the Roseburg calling area, dial toll free 1-800-452-0991.