

OFFICE OF THE  
DOUGLAS COUNTY SURVEYOR

Station: A-21 T 28 S, R 5 1/2 E, Sec 30 UNS  
30

Set By (Agency): BPR

Date Set: UNKNOWN

Recovered By FLI (DCSO)

Date Recovered 7-25-84

Recovered By Harry Heislein (USFS)

Date Recovered Fall 1985

Recovered By \_\_\_\_\_

Date Recovered \_\_\_\_\_

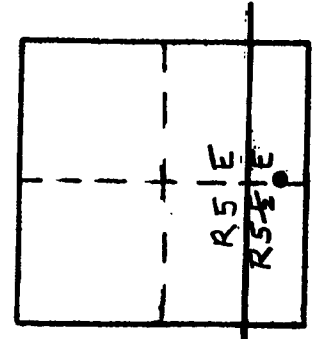

a-008  
A 21  
285 5 1/2 E 30

NAD ~~538524.61~~ ~~4487728.07~~  
83 ~~484 71 94~~ ~~122 07 22~~  
(CHANGED 4/10/2003)

VERTICAL CONTROL NGVD 29 CORPLONG NAVD 88 5240.893 FT  
Elevation: 5236.523 NGS Line # 128 USGS Line # \_\_\_\_\_ OSHD Line # \_\_\_\_\_  
Precision: 2nd Agency: DCSO Proj. # 2004-8 CS57/23 Date: 1974

HORIZONTAL CONTROL OCS 27 (COORD. VALUE CHANGED 4/10/2003)  
South Zone State Plane Coordinates: Y(Northing) 533,562.71 X(Easting) 1,556,766.67  
Precision: 1/25,000 Agency: DCSO Proj. # 2004-8 CS57/23 Date: 1975  
Approximate Geographic Position: Latitude 43°07'<sup>07</sup>09" Longitude 122°07'<sup>09</sup>36"

DESCRIPTION and TO REACH

SKETCH

1.6 miles SW along new Highway  
of new Hwy 138 and new Hwy 230.

Brass cap in concrete post, 67 ft. north of  
edge of pavement.

Monument lies 65 ft. left (northwesterly)  
of station 1172+85.

Shown on USGS Quads: Diamond Lake 15'  
Pumice Desert West  
7 1/2'

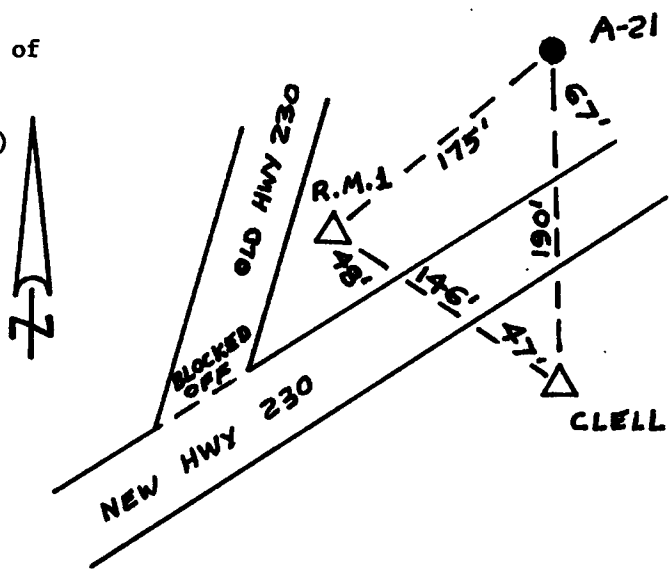

<b>Reference Marks:</b>	<b>CLELL</b>	Brass cap in 6" belltile (El. 5240.775) 533,376.25      1,556,729.67
	<b>CLELL R.M. 1</b>	Brass cap in 6" belltile (El. 5240.096) 533,470.49      1,556,618.27

Note: For further information, contact the Douglas County Surveyor's Office, Room 205 Douglas County Justice Building, Roseburg, OR 97470. Phone 440-4278. Douglas County residents outside the Roseburg calling area, dial toll free 1-800-452-0991.