

OFFICE OF THE
DOUGLAS COUNTY SURVEYOR

Station: A9 T 32 S, R 8 W, Sec 1

Set By (Agency): USC&GS

Date Set: _____

Recovered By RS, PB

Date Recovered 11/30/83

Recovered By _____

Date Recovered _____

Recovered By _____

Date Recovered _____

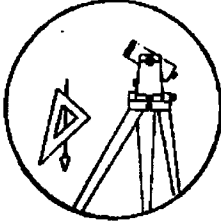
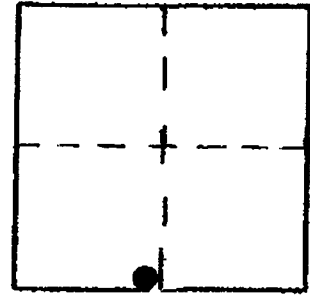

A 002

VERTICAL CONTROL

CORPCON 6 NAVD88 1033.056 FT

Elevation: 1029.657 NGS Line # 6 USGS Line # _____ OSHD Line # _____

Precision: 1st Agency: USC&GS Proj. # _____ Date: 1957

HORIZONTAL CONTROL

South Zone State Plane Coordinates: Y(Northing) _____ X(Easting) _____

Precision: _____ Agency: _____ Proj. # _____ Date: _____

Approximate Geographic Position: Latitude _____ Longitude _____

DESCRIPTION and TO REACH

SKETCH

DESCRIPTION:

A unstamped boat spike set flush in a concrete wing wall of a SPRR bridge.

TO REACH:

From the intersection of Cow Creek Rd. (Co. Rd. #321) and Middle Creek Rd. in T32S, R8W, Sec.1, proceed southerly along Cow Creek Rd. 0.10 miles to SPRR crossing; monument is 64 ft. east along railroad tracks in the NW concrete wing wall of SPRR bridge over Cow Creek.

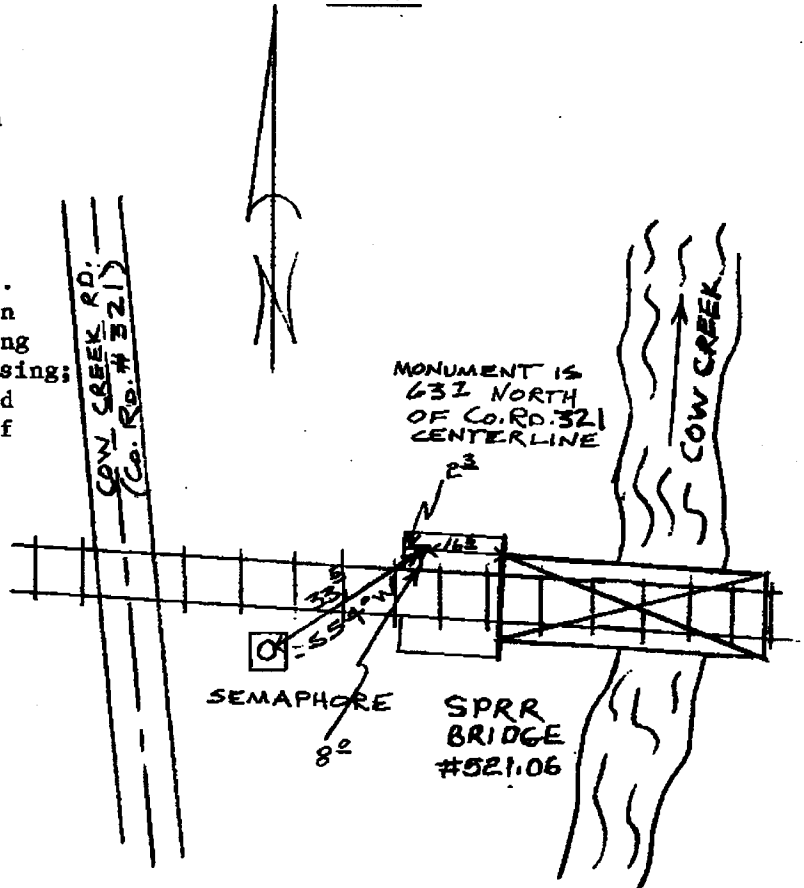

Reference Marks:

Note: For further information, contact the Douglas County Surveyor's Office, Room 205 Douglas County Justice Building, Roseburg, OR 97470. Phone 440-4278. Douglas County residents outside the Roseburg calling area, dial toll free 1-800-452-0991.