

Station: W 1/4 COR S.7 T 32 S, R 4W , Sec 7
 Set By (Agency): DCSO
 Date Set: 1956
 Recovered By RWS,SJF
 Date Recovered 8/21/85
 Recovered By _____
 Date Recovered _____
 Recovered By _____
 Date Recovered _____

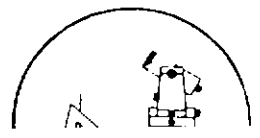
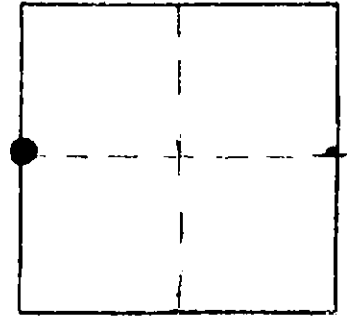

32-04W-07-003 32S 04W 07
W 1/4 CORNER

NAD 426497.75 4189213.52
83 42°48'15" 123°13'42"

VERTICAL CONTROL

Elevation: _____ NGS Line # _____ USGS Line # _____ OSHD Line # _____
 Precision: _____ Agency: _____ Proj. # _____ Date: _____

HORIZONTAL CONTROL

South Zone State Plane Coordinates: Y(Northing) 426,534.05 X(Easting) 1,268,254.74
 Precision: 1/25,000 Agency: DCSO Proj. # 2013 Date: 1985
 Approximate Geographic Position: Latitude 42°48'16" Longitude 123°13'38"

DESCRIPTION and TO REACH

A DCSO disk on an iron pipe, stamped "T32S 1/4S 12 7 R5W R4W 1956", firmly set and protruding 4 in. above ground.

From the intersection of Starveout Rd. (Co. Rd. #95) and Yeust Rd. (Co. Rd. #287), in T32S, R5W, Sec. 12, proceed northeasterly along Yeust Rd. approx. 0.55 miles to a private drive on left. Follow private drive west approximately 700 feet to it's end. Thence proceed west 75' along an east-west fence line to corner.

SKETCH

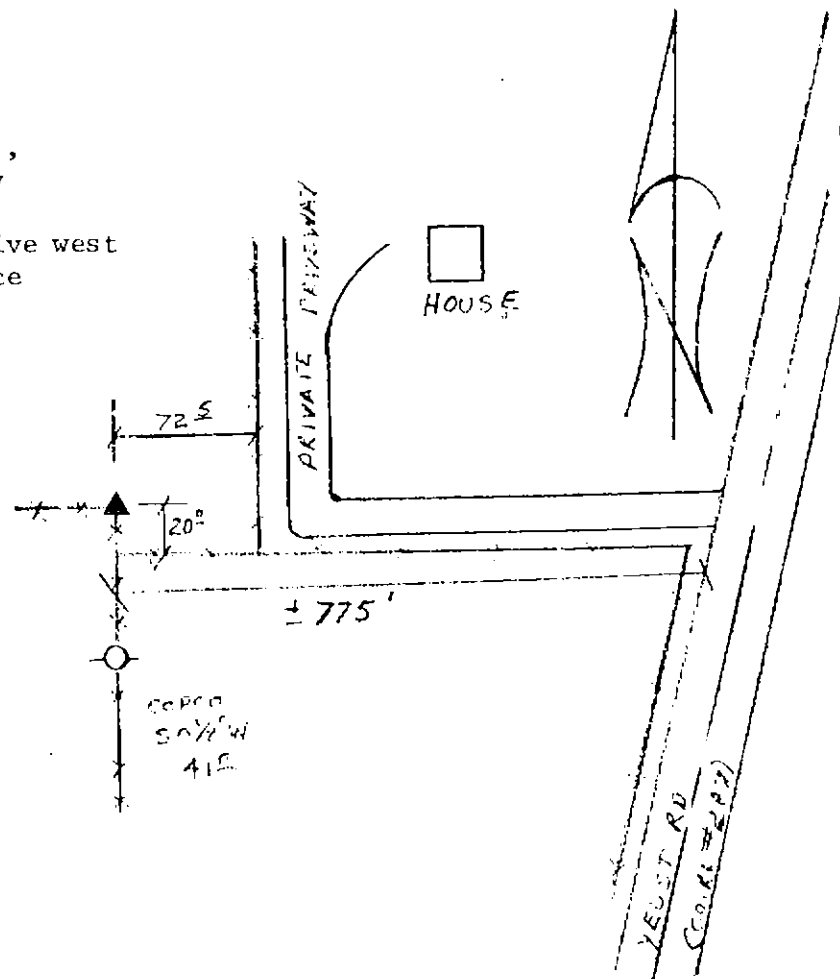

Reference Marks:

NOTE: See also corner renewal records.

Note: For further information, contact the Douglas County Surveyor's Office, Room 205 Douglas County Justice Building, Roseburg, OR 97470. Phone 440-4278. Douglas County residents outside the Roseburg calling area, dial toll free 1-800-452-0991.