

OFFICE OF THE
DOUGLAS COUNTY SURVEYOR

Station: WNW DLC 46 T 29 S, R 7 W , Sec 20

Set By (Agency): Monument origin is uncertain.

Date Set: see DCSO renewal records

Recovered By RS,SJF

Date Recovered June 7, 1984

Recovered By _____

Date Recovered _____

Recovered By _____

Date Recovered _____

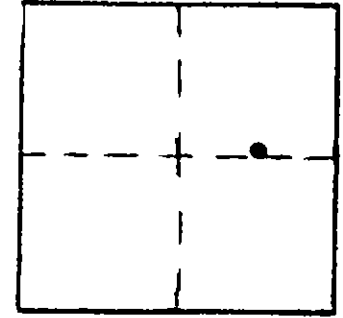

290-07W-20-041 29S 07W 20
WNW DLC 46

NAD 514158.25 4106115.11
83 43° 2' 12" 123° 32' 59"

VERTICAL CONTROL

Elevation: _____ NGS Line # _____ USGS Line # _____ OSHD Line # _____

Precision: _____ Agency: _____ Proj. # _____ Date: _____

HORIZONTAL CONTROL

South Zone State Plane Coordinates: Y(Northing) 514,193.25 X(Easting) 1,185,160.22

Precision: 1/25,000 Agency: D.C.S.O. Proj. # 2010-3 C.S.60/2 Date: 1978

Approximate Geographic Position: Latitude 43°02'13" Longitude 123°32'55"

DESCRIPTION and TO REACH

A 2 inch diameter iron pipe protruding 5 inches from the ground. Pipe is firmly set and leans slightly north. Monument is unmarked. This monument is the most westerly northwest corner of DLC #46, T29S, R7W.

TO REACH:

From the intersection of Upper Olalla Road (Co. Rd. #38) and the gravelled access road to the Berry Creek dam structure (Ben Irving Reservoir) in T29S, R7W, Sec. 20, proceed northwesterly along gravelled access road approximately 400 feet to monument on left. Monument lies approximately 50 feet southwest of access road centerline and approximately 8 feet lower than the road surface. Monument is in a pasture and approximately 40 feet southeast from a fence corner with fences running northwest, southeast and south.

* NOTE: See Douglas County Surveyor's Office Corner Renewal Records.

Also from the intersection of Upper Olalla road (Co. Rd. #38) and Hoover Hill Road (Co. Rd. #125) in T29S, R7W, Sec. 8, proceed southerly along Co. Rd. #38 approx. 2.2 miles to the access road of Berry Creek Dam Structure (see to reach above).

SKETCH

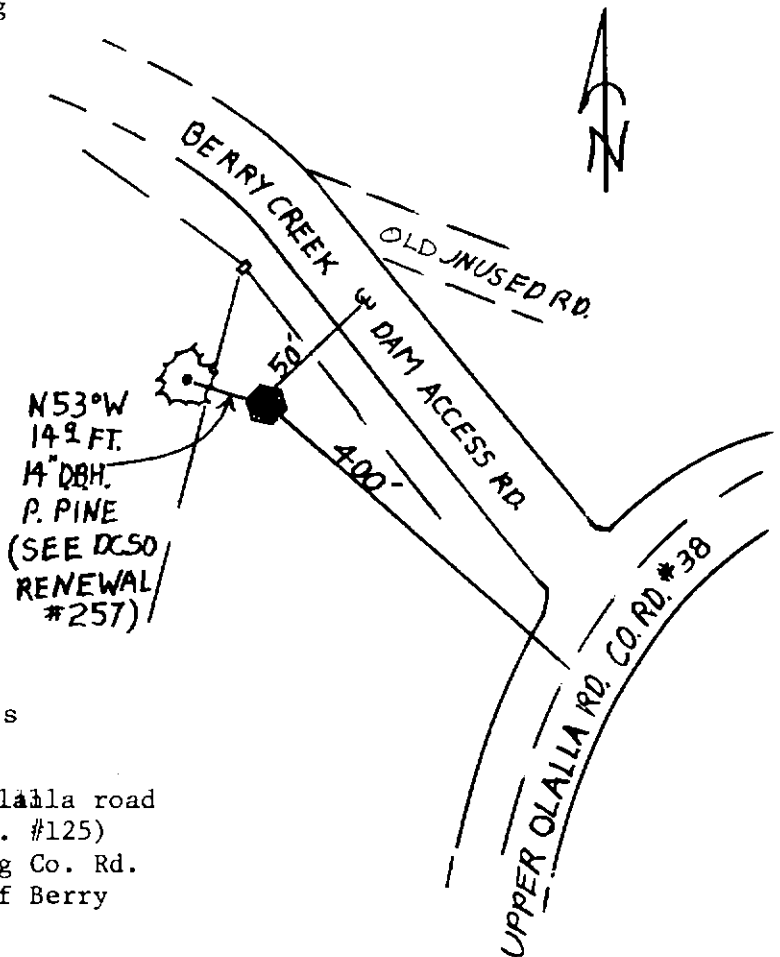

Note: For further information, contact the Douglas County Surveyor's Office, Room 205 Douglas County Justice Building, Roseburg, OR 97470. Phone 440-4278. Douglas County residents outside the Roseburg calling area, dial toll free 1-800-452-0991.