

OFFICE OF THE
DOUGLAS COUNTY SURVEYOR

Station: SW COR. T 28 S, R 8 W, Sec 1
 Set By (Agency): DCSO
 Date Set: 1956
 Recovered By RS, SF
 Date Recovered 8/24/84
 Recovered By _____
 Date Recovered _____
 Recovered By _____
 Date Recovered _____

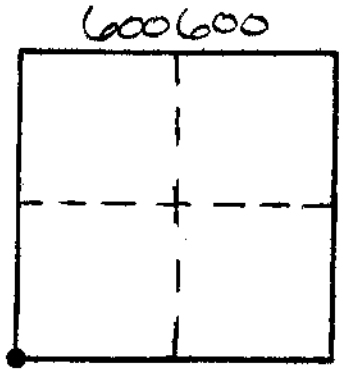

280-08W-01-010 28S 08W 01
 SW CORNER
 NAD 558262.57 4093574.17
 83 43° 9' 23" 123° 36' 10"

VERTICAL CONTROL

Elevation: _____ NGS Line # _____ USGS Line # _____ OSHD Line # _____
 Precision: _____ Agency: _____ Proj. # _____ Date: _____

HORIZONTAL CONTROL OCS 27

South Zone State Plane Coordinates: Y(Northing) 558,296.94 X(Easting) 1,172,615.42
 Precision: 1/5,000 Agency: DCSO Proj. # 2004 Date: 1972
 Approximate Geographic Position: Latitude 43°09'24" Longitude 123°36'06"

DESCRIPTION and TO REACH

SKETCH

DESCRIPTION:

A DCSO disk stamped " COUNTY SURVEYOR OFFICE "
 T28S R8W
 COR $\frac{2}{11} \frac{1}{12}$ SECS.
 1956

on a iron pipe firmly set and protruding 8 in.
 from ground.

TO REACH:

From the intersection of Coos Bay Wagon Rd.(Co.Rd.#112)
 and Reston Rd. (Co.Rd.#5) in T28S,R8W,Sec.14, proceed
 northeasterly along Reston Rd. approx. 1.3 miles to top
 of hill in the northeast corner of T28S,R8W,Sec.12; monument
 lies approx. 300 ft. northwest of County Rd. #5, off right side
 of dim track road.

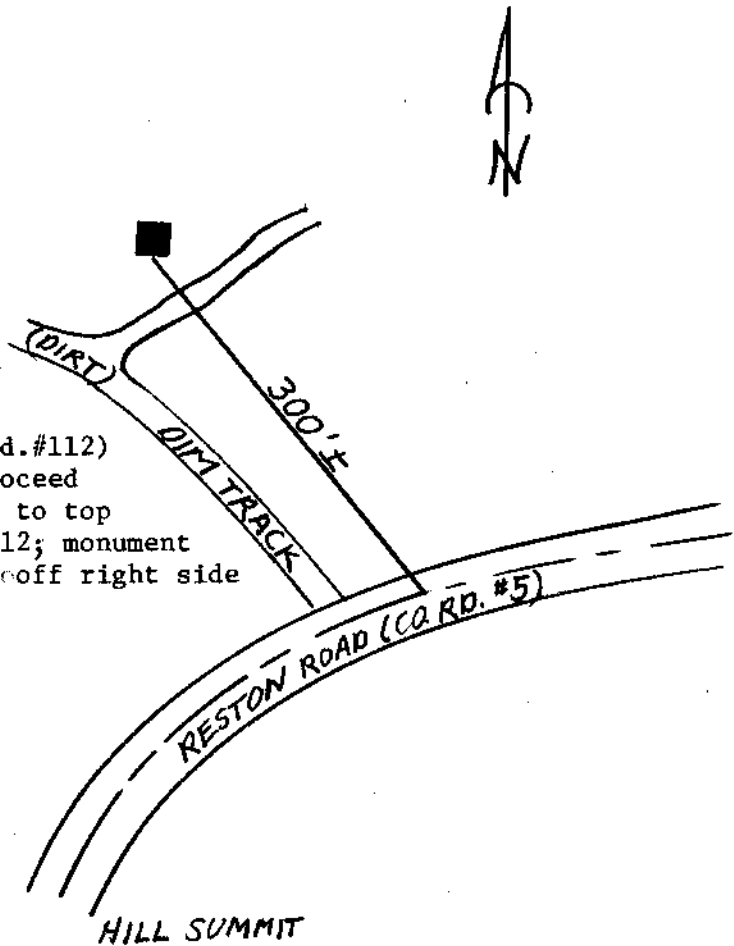

Reference Marks:

See Douglas County renewal records.

Note: For further information, contact the Douglas County Surveyor's Office, Room 205
 Douglas County Justice Building, Roseburg, OR 97470. Phone 440-4278. Douglas
 County residents outside the Roseburg calling area, dial toll free 1-800-452-0991.