

OFFICE OF THE
DOUGLAS COUNTY SURVEYOR

Station: E 1/4 T 22 S, R 12 W, Sec 7

Set By (Agency): Unknown

200540

Date Set: Unknown

Recovered By JRL, S.I.F

Date Recovered August 11, 1986

Recovered By _____

Date Recovered _____

Recovered By _____

Date Recovered _____

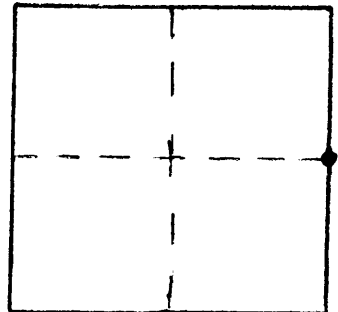

220-12W-07-012 22S 12W 07
E 1/4

NAD 753324.25 3952134.63
89 43°40'32" 124° 9'52"

VERTICAL CONTROL

Elevation: _____ NGS Line # _____ USGS Line # _____ OSHD Line # _____

Precision: _____ Agency: _____ Proj. # _____ Date: _____

HORIZONTAL CONTROL **NAD 27**

South Zone State Plane Coordinates: Y(Northing) 753,359.32 X(Easting) 1,031,173.91

Precision: 1/5,000 Agency: DCSO Proj. # 6009-12, CS 62/43 Date: 1986

Approximate Geographic Position: Latitude 43°40'32" Longitude 124°09'47"

DESCRIPTION and TO REACH

An unmarked 1 inch diameter iron bar protruding approximately 4 1/2 feet from ground and firmly set at edge of swamp.

From the intersection of Ninth Street and U.S. Highway 101 in T22S, R12W, S7 proceed easterly along U.S. Highway 101 approximately 0.3 miles to private drive on left, follow left branch of private northerly and westerly approximately 700 feet to corner on right.

HOUSE

SKETCH

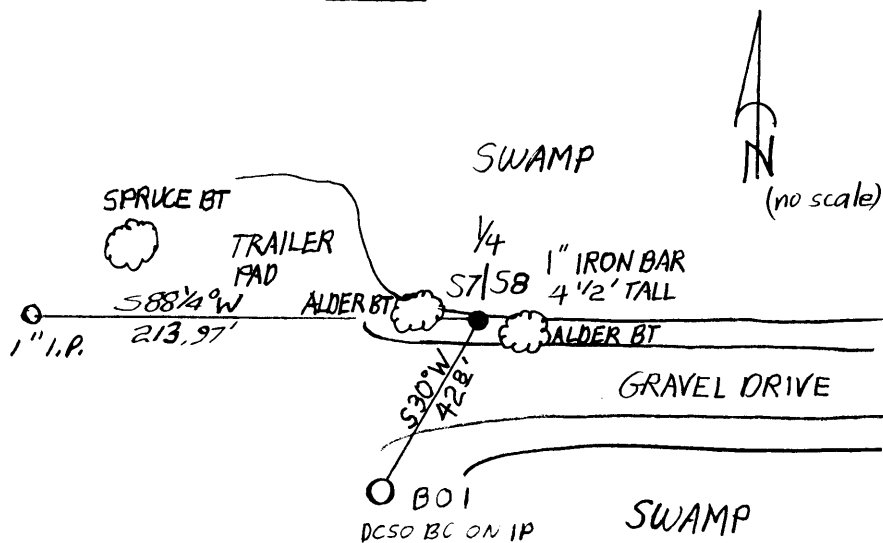

* SEE DCSO CORNER RENEWAL RECORDS FOR BT INFO.

Reference Marks:

3 Bearing trees: see DCSO corner renewal records.

A 2 3/8 inch diameter brass cap stamped " B.O. 1 N30°E 42.8 FT. 1986" on a 1 3/8 inch O.D. iron pipe protruding 4 inches from ground bears S31°48'44"W, 42.78 ft. (grid) from iron bar 1/4 corner monument.

A 1 inch I.P. bears N 89°13'55" W, 213.96 ft. grid (Rec. west 214.01 ft. per M57-53).

Note: For further information, contact the Douglas County Surveyor's Office, Room 205 Douglas County Justice Building, Roseburg, OR 97470. Phone 440-4278. Douglas County residents outside the Roseburg calling area, dial toll free 1-800-452-0991.