

**DOUGLAS COUNTY SURVEYOR'S OFFICE**

Designation: 8-164 Station: 16+32.78 T 27S R 6W S 14 1/4 NE

Date Set: 1990 Set by (Agency): AA SURVEYING

Date Recovered: 9/08 Recovered by: SIF

- Found       New       Reset  
 Not Found       Referenced       Destroyed

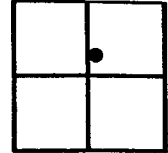

**VERTICAL CONTROL**

NGVD 29 Elevation: 432.41 Feet      File # M 112-20A4B  
 Precision: 3RD ORDER      Agency: L.S. 1651      Project: M 112-20A8B Date: 1990  
 NAVD 88 Elevation: 435.88 <sup>FT</sup> Meters      File # \_\_\_\_\_  
 Precision: CORPCON 6      Agency: \_\_\_\_\_      Project: \_\_\_\_\_      Date: \_\_\_\_\_

**HORIZONTAL CONTROL - south zone**

N <u>580529.86</u>	E <u>4154733.36</u>	Datum/Adj.: <u>NAD 83</u>	Precision: <u>SCALED</u>
Lat: _____	Long: _____	Agency: _____	File # _____ Date: _____
N _____	E _____	Datum/Adj.: _____	Precision: _____
Lat: _____	Long: _____	Agency: _____	File # _____ Date: _____
N _____	E _____	Datum/Adj.: _____	Precision: _____
Lat: _____	Long: _____	Agency: _____	File # _____ Date: _____
N _____	E _____	Datum/Adj.: _____	Precision: _____
Lat: _____	Long: _____	Agency: _____	File # _____ Date: _____

**DESCRIPTION AND TO REACH**

A 2 5/8 INCH DIAM. BRASS CAP  
STAMPED "AA SURVEYING INC", ON  
A 1 1/2 x 36 INCH GALV. IRON PIPE,  
SET BELOW ASPHALT ROAD SUR-  
FACE, UNDER A 7 INCH DIAM.  
ALUMINUM MONUMENT COLLAR  
AND COVER.

GO TO THE INTERSECTION OF  
PRIMROSE LANE AND NW KEASEY  
ST. IN THE NE QUARTER OF  
SECTION 14, T27S, R6W. MON-  
UMENT FALLS JUST NORTH  
OF THE ABOVE INTERSECTION  
NEAR THE 1/4 OF NW KEASEY ST.

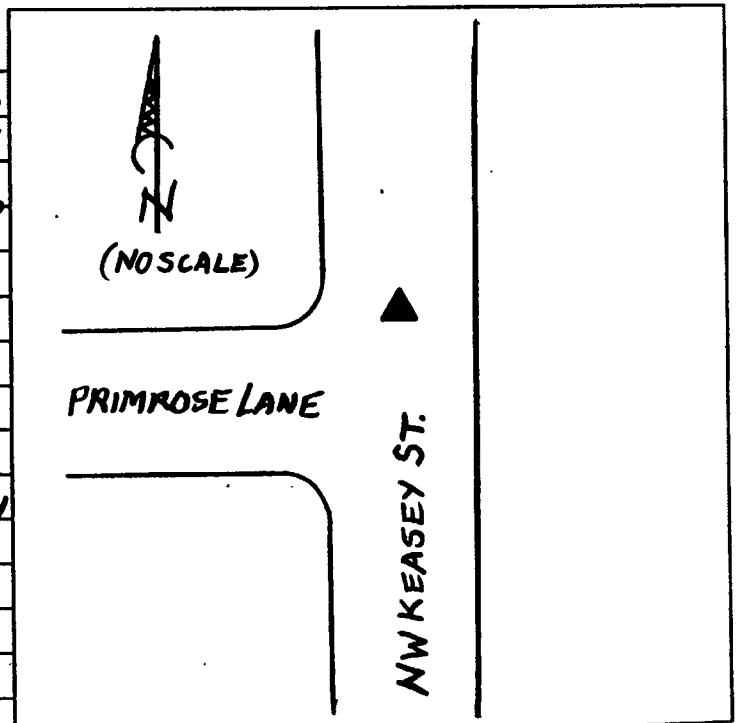

90 164

PHOTO FILE NAME

LOCATION

# 100-1341 (Renamed 90-164  
7/28/09)

~~M092511A~~ BAD FILE

PROCESSED BY: \_\_\_\_\_

DATE: \_\_\_\_\_