

OFFICE OF THE
DOUGLAS COUNTY SURVEYOR

Station: 40-9R T 27 S, R 6 W, Sec 24

Set By (Agency): CITY (RSBG)

Date Set: ?

Recovered By RWS SJF

Date Recovered 6/2000

Recovered By RWS/SJF/2000

Date Recovered _____

Recovered By _____

Date Recovered _____

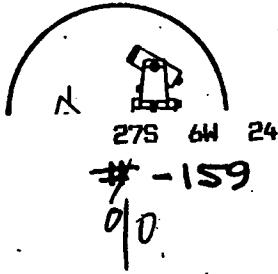
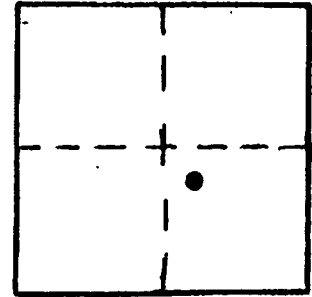

VERTICAL CONTROL NGVD 29 CORPCOM 6 NAVD 88 460.07 FT
Elevation: 456.60 NGS Line # _____ USGS Line # _____ OSHD Line # _____
Precision: 3rd Agency: DCSD Proj. # 66/38 Date: 2000

HORIZONTAL CONTROL
South Zone State Plane Coordinates: Y(Northing) _____ X(Easting) _____
Precision: _____ Agency: _____ Proj. # _____ Date: _____
Approximate Geographic Position: Latitude 43°12'20.6" Longitude 123°21'13.6"

DESCRIPTION and TO REACH

SKETCH

DESCRIPTION:

A 2 in. diam. brass cap stamped "40-9 R"
set flush in concrete curbing.

TO REACH:

Go to intersection of SE Fullerton St.
and SE Micelli St.

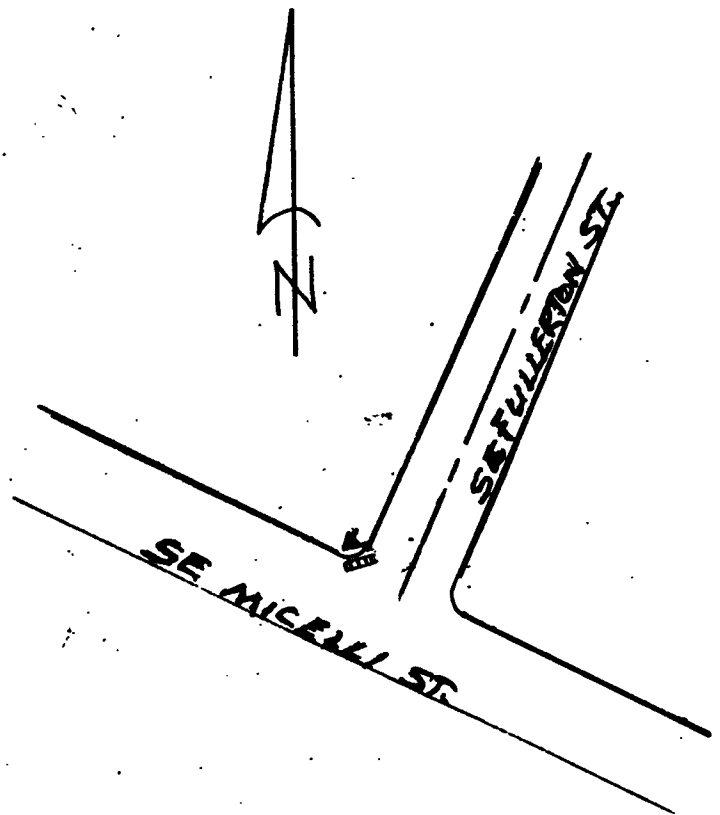

Reference Marks:

Note: For further information, contact the Douglas County Surveyor's Office, Room 205 Douglas County Justice Building, Roseburg, OR 97470. Phone 440-4278. Douglas County residents outside the Roseburg calling area, dial toll free 1-800-452-0991.