

# Douglas County Geodetic Data Sheet

T 30 R 05 S 06

Station: 642 B  
 Date Set: 1903 Set By (Agency): USGS  
 Last Date Recovered: 08/00/1993

Designation: %-145

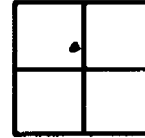

## VERTICAL CONTROL

NGVD 29 Elevation:	643.033 Feet	Project:	Date: 1988
Precision: 1ST ORDER	Agency: USGS	Project:	Date: 1988
NAVD 88 Elevation:	197.043 Meters	Project:	Date: 1988
Precision: 1ST ORDER	Agency: USGS	Project:	Date: 1988
NGS Line #	USGS Line #	OSHD Line #	File #

NAVD 88 646.467 FT

## HORIZONTAL CONTROL

OCS 27	Y(Northing):	X(Easting):	Lat	Long:
Precision:	Agency:	Project:	Date:	
OCS 83	Y(Northing):	X(Easting):	Lat:	Long:
Precision:	Agency:	Project:	Date:	
OCS 83/91	Y(Northing):	X(Easting):	Lat:	Long:
Precision:	Agency:	Project:	Date:	
OCS 27 Scaled Latitude:	42°59'40"	OCS 27 Scaled Longitude:	123°19'58"	

## DESCRIPTION:

A 3.25 INCH DIAMETER USGS DISK STAMPED; 642 B 1903; SET FLUSH IN 12X12 INCH SQUARE TOP OF A CONCRETE POST PROTRUDING APPROX 10 INCHES ABOVE GROUND.

## COMMENTS:

FROM THE INTERSECTION OF I-5 AND WEAVER RD; CO RD 41 AT I-5 EXIT 106 IN T29S R5W SEC 32 PROCEED SOUTHWESTERLY ALONG WEAVER RD APPROX 1.70 MILES TO MONUMENT ON LEFT.

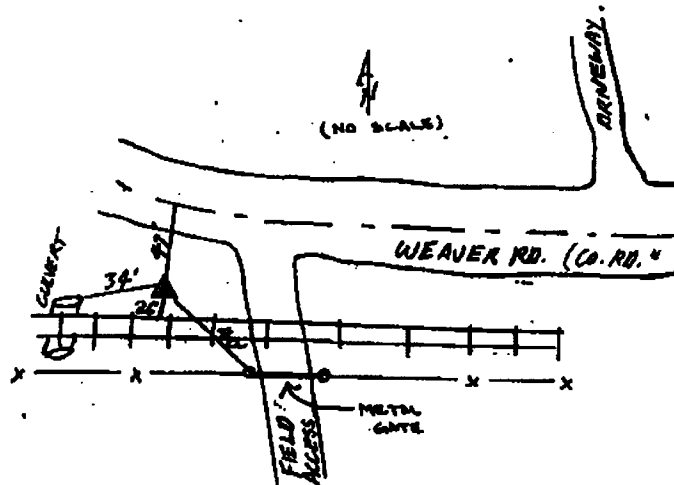

Note: For further information contact the Douglas County Surveyors Office, Room 105A Douglas County Courthouse, Roseburg, OR 97470. Phone 440-4272 or Fax (541)957-8150. Douglas County Residents outside Roseburg calling area, dial toll free 1-800-224-1619.