

OFFICE OF THE
DOUGLAS COUNTY SURVEYOR

90-118

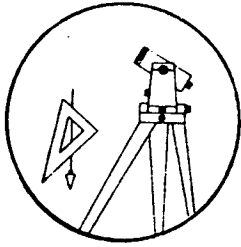

Station: 16-D9 T 31 S, R 2 W, Sec 13
Set By (Agency): BPR
Date Set: 1928
Recovered By R.S., S.J.F.
Date Recovered Feb. 17, 1984
Recovered By _____
Date Recovered _____
Recovered By _____
Date Recovered _____

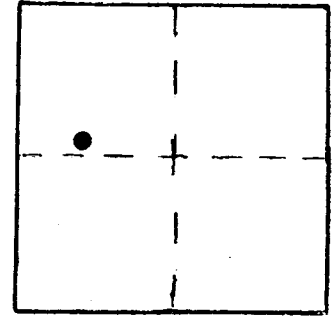

VERTICAL CONTROL CORPSCONG NAVD88 1368.297 FT.
Elevation: 1,364.781 NGS Line # 129 USGS Line # _____ OSHD Line # _____
Precision: 2nd. Agency: USC&GS Proj. # _____ Date: 1956

HORIZONTAL CONTROL
South Zone State Plane Coordinates: Y(Northing) 451569 X(Easting) 4278338
Precision: GIS SCALED Agency: DCSO Proj. # _____ Date: 2014
Approximate Geographic Position: Latitude _____ Longitude _____

DESCRIPTION and TO REACH

A BPR disk stamped "16-D9 1928" set in an 8 inch diameter concrete post protruding 4 inches above the ground.

To Reach:

From the Drew store on State Highway 227 at Drew in T31S, R2W, Sec.14, proceed approximately 0.3 miles southeast along State Highway 227 to monument on left.

SKETCH

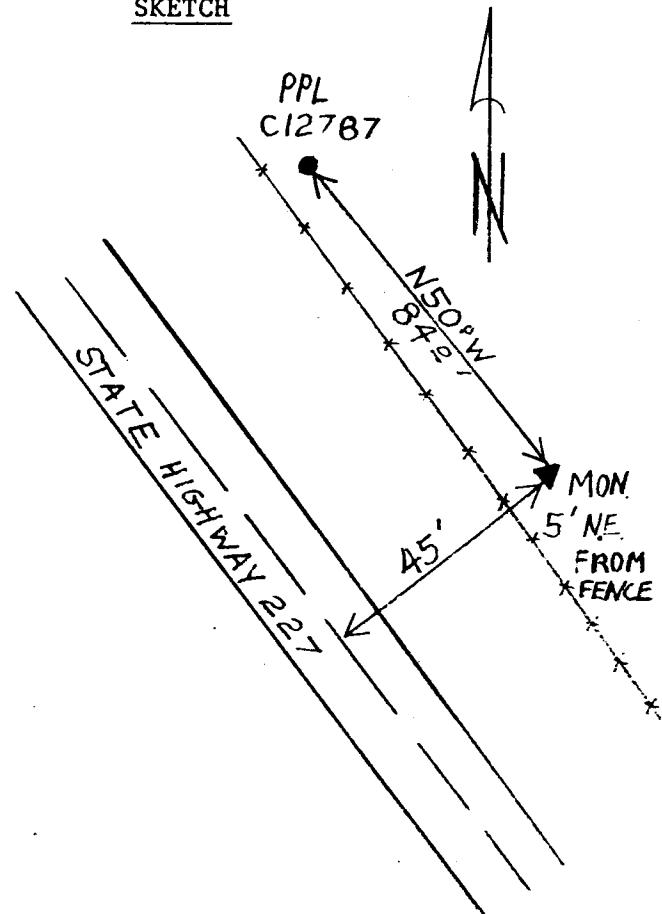

Reference Marks:

Note: For further information, contact the Douglas County Surveyor's Office, Room 205 Douglas County Justice Building, Roseburg, OR 97470. Phone 440-4278. Douglas County residents outside the Roseburg calling area, dial toll free 1-800-452-0991.