

9-108

OFFICE OF THE  
DOUGLAS COUNTY SURVEYOR

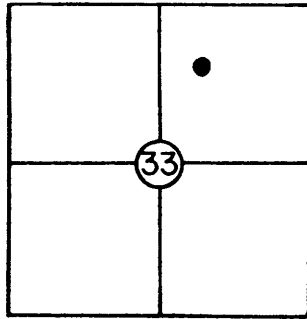

T 30 S, R 2 W., Sec. 33

Station: 1 OSHD RESET

Set By (Agency): Lyle Riggers (NGS)

Date: 1980

VERTICAL CONTROL CORPSCON 6 NAVD 88 FT

Elevation: 1,042.747 NGS(USC&GS) Line # 130 USGS Line # \_\_\_\_\_

Order  
Of Precision 2nd Agency: NGS Proj. #: \_\_\_\_\_ Date: 1980  
Lyle Rigger

HORIZONTAL CONTROL

Oregon State Plane Coordinates: Y(Northing) 469707 X(Easting) 4266029  
(South Zone)

Order GIS  
Of Precision SCALED Agency: DCSO Proj. #: \_\_\_\_\_ Date: 2014

Approximate Geographic Position: Latitude= \_\_\_\_\_ Longitude= \_\_\_\_\_

DESCRIPTION: Brass cap in 10" concrete cylinder

flush w/ ground. Approx. in center of  
Tiller Ranger Sta. compound, 92 ft. NNW of a  
3 ft diam. cedar, 43 ft. W of SW corner of  
shop building, 12 ft. W of  $\odot$  of road through  
compound, 2 ft. S of row of mailboxes.

SKETCH

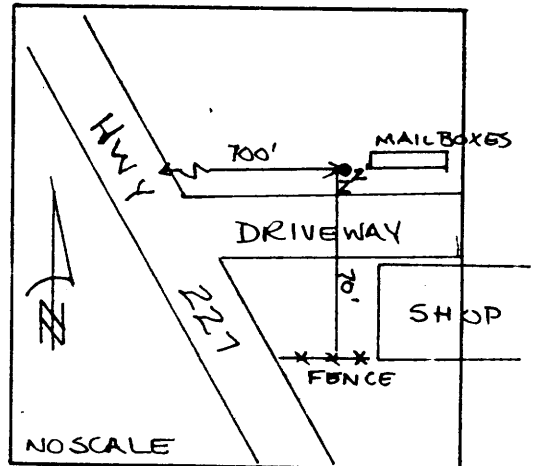

VICINITY: Tiller Ranger Station.

NOTE: For Possible Further Information On This Station, Please Contact The Douglas County Surveyors Office, Rm. 205 Douglas County Justice Bldg., Roseburg, OR. 97470 Phone 672-3311 Ext. 272. Douglas County residents outside the Roseburg calling area dial toll free 1-800-452-0991.