

T 27 S, R 6W, Sec.14

OFFICE OF THE
DOUGLAS COUNTY SURVEYOR

o/o
#072

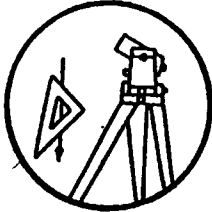

Station: 26-2
Date Set: _____
Set By (Agency): RSBG CITY
DCSO Designation: #-072
Date Recovered: 9\92
Recovered By: SJF TF
Date Recovered: EW/SJF-2000
Recovered By: _____
Date Recovered: _____
Recovered By: _____

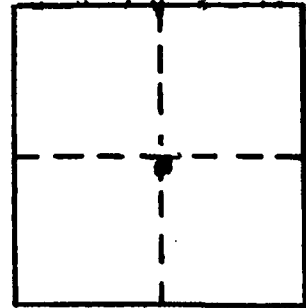

VERTICAL CONTROL NGVD29
Elevation: ~~436.78~~ 436.93 CORCON 6 NAVD 88 440.40 FT
Precision: 3rd Order Agency: ~~RSBG CITY~~ DCSD Proj. # 66/38 OSHD Line # Date: 2000

HORIZONTAL CONTROL
O.C.S. 27 Y(Northing): 579,954.05 O.C.S. 83 Y(Northing): 579,918.92
South Zone X(Easting): 1,233,992.82 South Zone X(Easting): 4,154,951.17
Precision: 1/20000 Agency: DCSD Proj. # 2005-2 Date: 1983
Approx. Geographic Position: Latitude 43°13'19" Longitude 123°22'28.2"

Found: A disk stamped "26.2" set in a 6" square concrete monument flush with the ground.

To reach: At the intersection of Stewart Parkway and NW Harvey Ct. near SW corner of tennis courts.

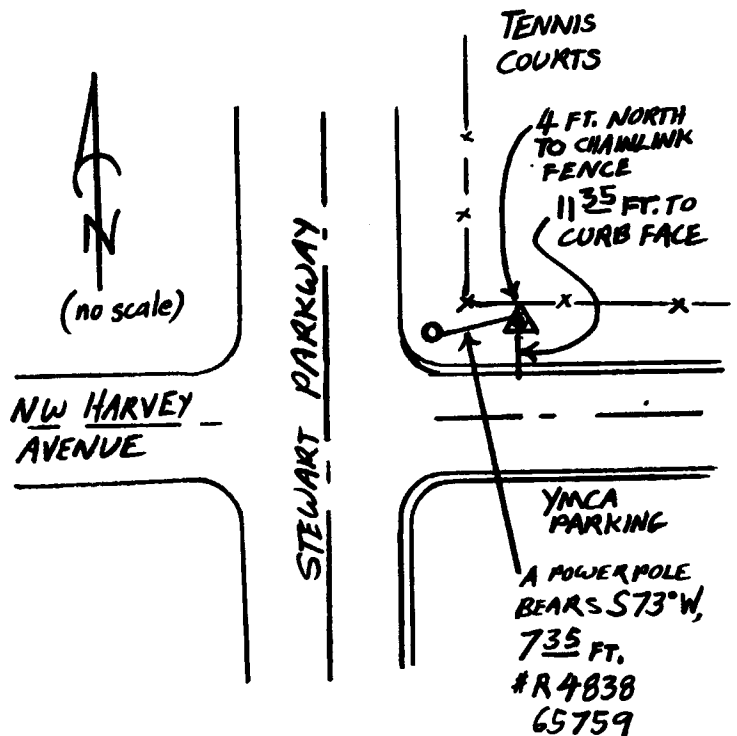

Note: For possible further information contact the Douglas County Surveyors Office, Room 205 Douglas County Justice Building, Roseburg, OR 97470. Phone 440-4272. Douglas County residents outside the Roseburg calling area, dial toll free 1-800-477-0991.