

OFFICE OF THE  
DOUGLAS COUNTY SURVEYOR

Station: 17-6. T 27 S, R 6 W , Sec 14

Set By (Agency): CITY (RSBC)

Date Set: ?

Recovered By TP, KR

Date Recovered 5/82

Recovered By RWS-SJF

Date Recovered 2000

Recovered By \_\_\_\_\_

Date Recovered \_\_\_\_\_

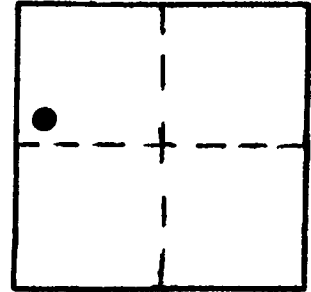

#-065  
17-6

27S 6W 14

NAD 580399.85 4153003.22  
83 43°13'23" 123°22'59"

VERTICAL CONTROL NGVD 29 CORPCON 6 NAVD 88 432.64 FT  
Elevation: 429.7 NGS Line # \_\_\_\_\_ USGS Line # \_\_\_\_\_ OSHD Line # \_\_\_\_\_  
Precision: 3rd Agency: CITY (RSBC) Proj. # 46/38 Date: 2000

HORIZONTAL CONTROL OCS 27 DCSO  
South Zone State Plane Coordinates: Y(Northing) 580,434.96 X(Easting) 1,232,044.86  
Precision: 1/20,000 Agency: DCSO Proj. # 2005-2 Date: 1983  
Approximate Geographic Position: Latitude 43°13' 23.2 Longitude 123°22' 54.7

DESCRIPTION and TO REACH

SKETCH

DESCRIPTION:

A 0.10 ft. disk stamped "17-6"  
set in concrete post flush with  
ground.

TO REACH:

Go to intersection of NW Garden St.  
and NW Riverview Dr., proceed westarly  
along NW Riverview Dr. approx. 146 ft.  
to monument on left.

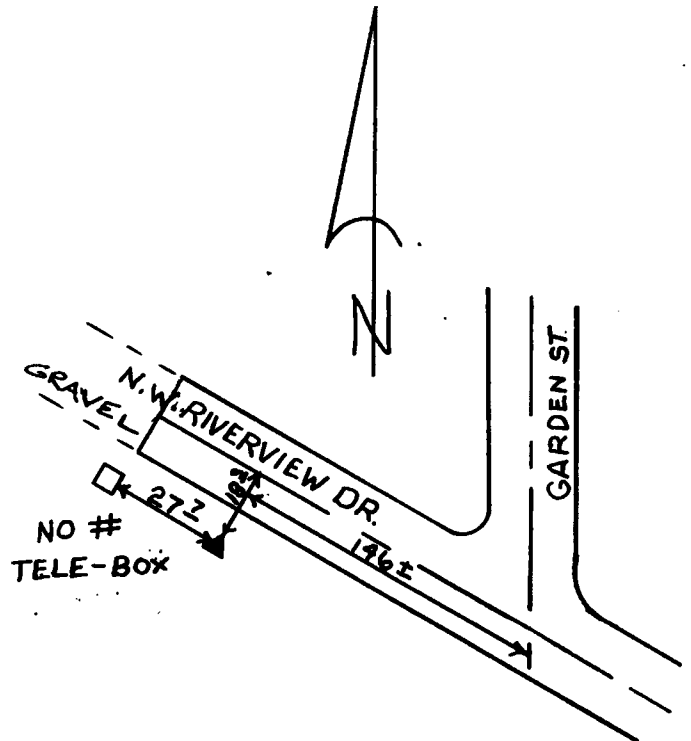

Reference Marks:

Note: For further information, contact the Douglas County Surveyor's Office, Room 205 Douglas County Justice Building, Roseburg, OR 97470. Phone 440-4278. Douglas County residents outside the Roseburg calling area, dial toll free 1-800-452-0991.