

OFFICE OF THE  
DOUGLAS COUNTY SURVEYOR

Station: 17-3 T 27 S, R 6 W, Sec 14  
 Set By (Agency): CITY (RSBG)  
 Date Set: ?  
 Recovered By KR, TP  
 Date Recovered 5/82  
 Recovered By RWS-SJT  
 Date Recovered 2000  
 Recovered By \_\_\_\_\_  
 Date Recovered \_\_\_\_\_

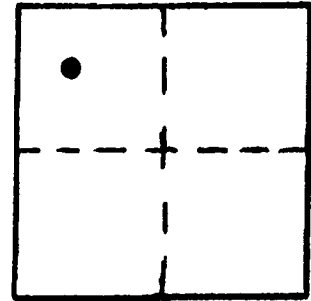

010  
 #063  
 17-3  
 27S 6W 14  
 NAD 581199.97 4153405.24  
 83 43°13'31" 123°22'54"

VERTICAL CONTROL NGVD 29 CORCON 6 NAVD 08 430,37 FT  
 Elevation: ~~426.88~~ 426<sup>90</sup> NGS Line # \_\_\_\_\_ USGS Line # \_\_\_\_\_ OSHD Line # \_\_\_\_\_  
 Precision: 3rd Agency: CITY (RSBG) Proj. # 66/38 Date: \_\_\_\_\_

HORIZONTAL CONTROL OCS 27  
 South Zone State Plane Coordinates: Y(Northing) 581,235.09 X(Easting) 1,232,446.89  
 Precision: 1/20,000 Agency: DCSO Proj. # 2005-2 Date: 1983  
 Approximate Geographic Position: Latitude 43°13'31.3" Longitude 123°22'49.6"

DESCRIPTION and TO REACH

SKETCH

DESCRIPTION:  
 A disk stamped "17-3" set in concrete curbing.  
 TO REACH:  
 Go to intersection of NW Whipple St. and NW Jefferson St.

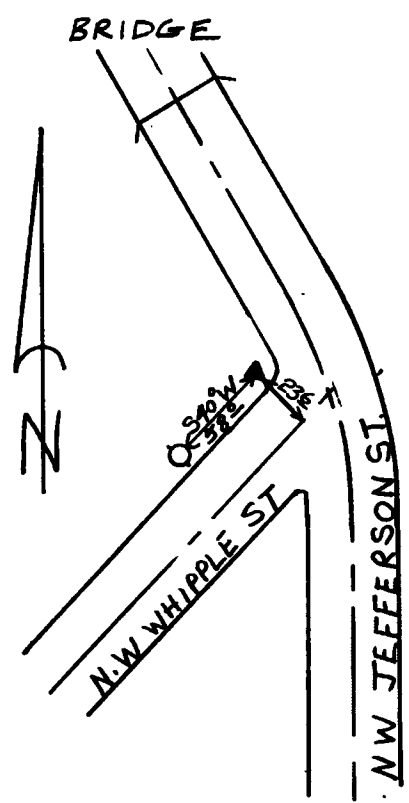

Reference Marks:

Note: For further information, contact the Douglas County Surveyor's Office, Room 205 Douglas County Justice Building, Roseburg, OR 97470. Phone 440-4278. Douglas County residents outside the Roseburg calling area, dial toll free 1-800-452-0991.