

OFFICE OF THE  
DOUGLAS COUNTY SURVEYOR

Station: 27-3 T 27 S, R 6 W, Sec 11

Set By (Agency): CITY(RSBG)

Date Set: ?

Recovered By TP, KR

Date Recovered 5/82

Recovered By RWS-STF

Date Recovered 2000

Recovered By \_\_\_\_\_

Date Recovered \_\_\_\_\_

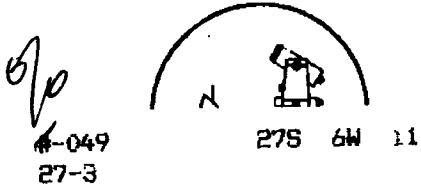
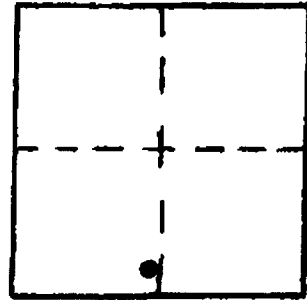

NAD 83 582725.69 4154743.65  
43°13'46" 123°22'37"

VERTICAL CONTROL NGVD 29 CORPCON 6 NAVD88 454.60 FT  
Elevation: 451.18 451.13 NGS Line # \_\_\_\_\_ USGS Line # \_\_\_\_\_ OSHD Line # \_\_\_\_\_  
Precision: 3rd Agency: CITY(RSBG) Proj. # 66/38 Date: 2000  
DCSO

HORIZONTAL CONTROL OC5 27  
South Zone State Plane Coordinates: Y(Northing) 582,760.81 X(Easting) 1,233,785.31  
Precision: 1/20,000 Agency: DCSO Proj. # 2005-2 Date: 1983  
Approximate Geographic Position: Latitude 43°13'46" Longitude 123°22'32"

DESCRIPTION and TO REACH

SKETCH

DESCRIPTION:

A 0.10 ft. diam. disk stamped "27-3"  
set in a concrete post set flush with  
ground.

TO REACH:

Go to intersection of NW Beaumont Ave.  
and NW Keasey St.

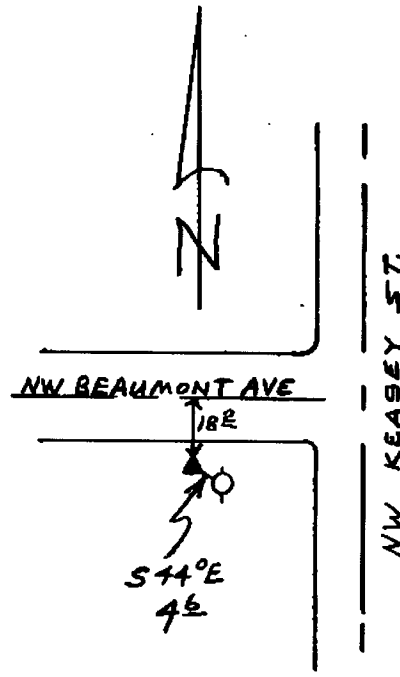

Reference Marks:

Note: For further information, contact the Douglas County Surveyor's Office, Room 205  
Douglas County Justice Building, Roseburg, OR 97470. Phone 440-4278. Douglas  
County residents outside the Roseburg calling area, dial toll free 1-800-452-0991.