

OFFICE OF THE
DOUGLAS COUNTY SURVEYOR

Station: 16-4 T 27 S, R 6 W, Sec 11
 Set By (Agency): CITY (RSBG)
 Date Set: ?
 Recovered By KR, TP
 Date Recovered 5/82
 Recovered By RWS-SJF
 Date Recovered _____
 Recovered By _____
 Date Recovered _____

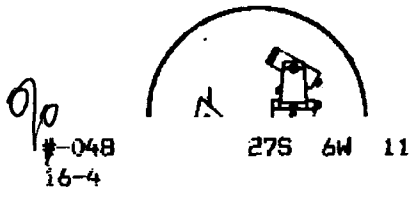
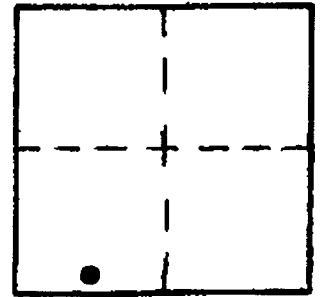

NAD 83 582745.12 43°13'46" 4153849.68 123°22'49"

VERTICAL CONTROL NGVD 29 CORPCOM 6 NAVD 88 446.86 FT
 Elevation: ~~443.41~~ 443³⁹ NGS Line # _____ USGS Line # _____ OSHD Line # _____
 Precision: 3rd Agency: ~~CITY (RSBG)~~ DCSO Proj. # 66/38 Date: 2000
HORIZONTAL CONTROL OCS 27
 South Zone State Plane Coordinates: Y(Northing) 582,780.23 X(Easting) 1,232,891.34
 Precision: 1/20,000 Agency: DCSO Proj. # 2005-2 Date: 1983
 Approximate Geographic Position: Latitude 43°13'46.7" Longitude 123°22'44.4"

DESCRIPTION and TO REACH

SKETCH

DESCRIPTION:

A 0.1 ft. diam. disk stamped "16-4"
set flush in concrete curbing.

TO REACH:

Go to intersection of NW Beaumont Ave.
and NW Kline St.

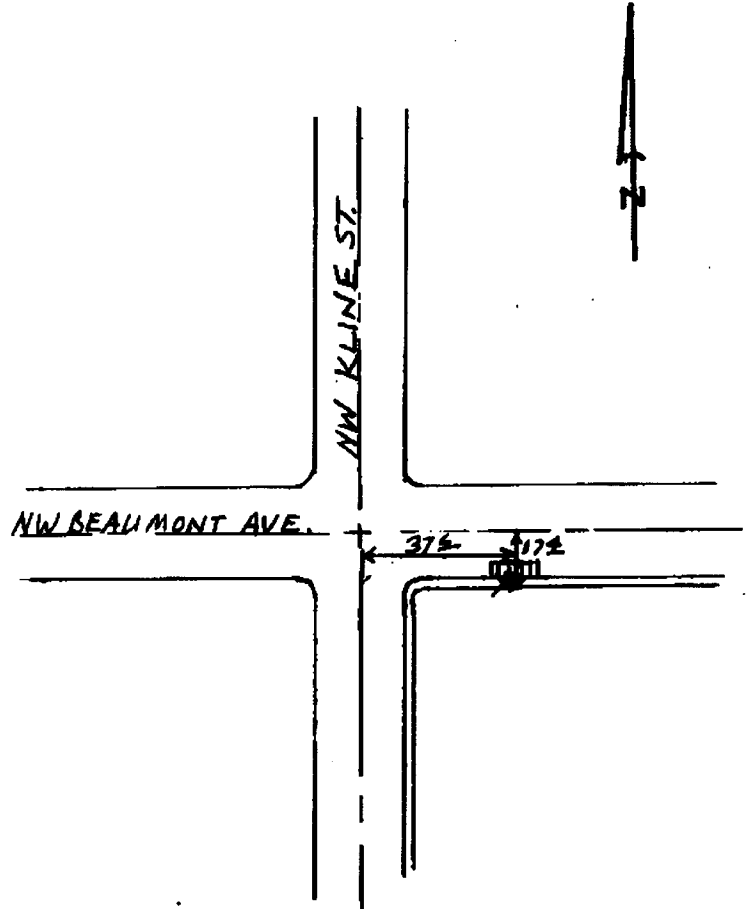

Reference Marks:

Note: For further information, contact the Douglas County Surveyor's Office, Room 205 Douglas County Justice Building, Roseburg, OR 97470. Phone 440-4278. Douglas County residents outside the Roseburg calling area, dial toll free 1-800-452-0991.