

OFFICE OF THE
DOUGLAS COUNTY SURVEYOR

Station: 51-8 T 27 S, R 5 W, Sec 19

Set By (Agency): CITY (RSBG)

Date Set: ?

Recovered By KR, TP

Date Recovered 5/82

Recovered By _____

Date Recovered _____

Recovered By _____

Date Recovered _____

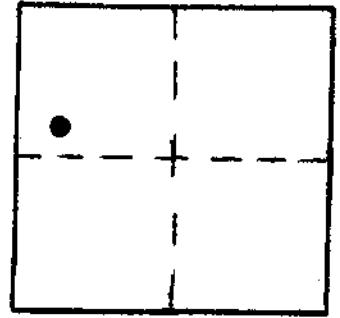

#-030
51-8 27S 5W 19

NAD 575416.88 4163136.25
83 43°12'37" 123°20'40"

VERTICAL CONTROL

Elevation: _____ NGS Line # _____ USGS Line # _____ OSHD Line # _____

Precision: _____ Agency: _____ Proj. # _____ Date: _____

HORIZONTAL CONTROL **NAD 27**

South Zone State Plane Coordinates: Y(Northing) 575,452.09 X(Easting) 1,242,177.93

Precision: 1/20,000 Agency: DCSO Proj. # 2005-2 Date: 1983

Approximate Geographic Position: Latitude 43°12'37" Longitude 123°20'36"

DESCRIPTION and TO REACH

SKETCH

DESCRIPTION:

A 2 in. diam. brass cap stamped "51-8"
set flush in concrete curbing.

TO REACH:

Go to intersection of SE Washington Ave.
and SE Rose St.

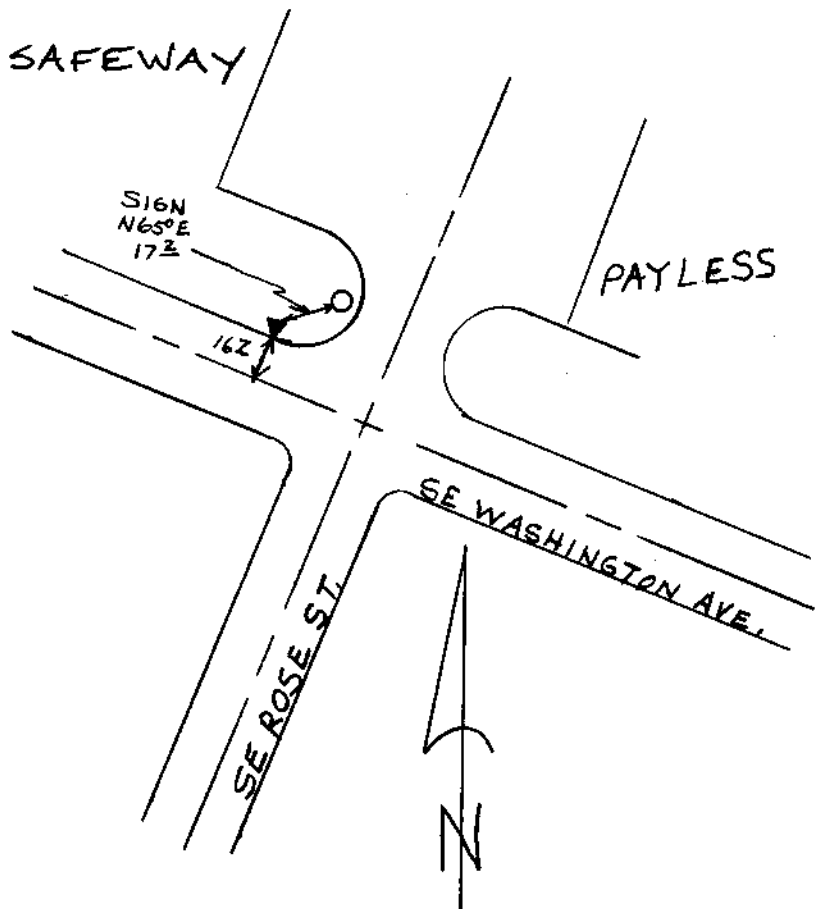

Reference Marks:

Note: For further information, contact the Douglas County Surveyor's Office, Room 205 Douglas County Justice Building, Roseburg, OR 97470. Phone 440-4278. Douglas County residents outside the Roseburg calling area, dial toll free 1-800-452-0991.