

OFFICE OF THE
DOUGLAS COUNTY SURVEYOR

Station: 51-1 T 27 S, R 5 W, Sec 19

Set By (Agency): CITY (RSBG.)

Date Set: ?

Recovered By LEM, TP

Date Recovered 9/81

Recovered By RWS-SJF

Date Recovered 2000

Recovered By _____

Date Recovered _____

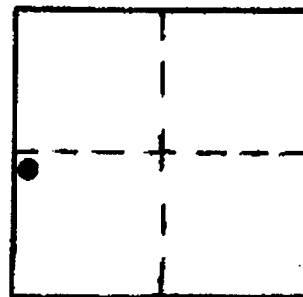

o/p #-023
51-1

27S 5W 19

NAD 574067.31 4162431.33
83 43°12'23" 123°20'49"

NGVD 29
VERTICAL CONTROL 493.74 CORPCONG NAVD 88 497.21 FT

Elevation: 493.09 NGS Line # _____ USGS Line # _____ OSHD Line # _____

Precision: 3rd Agency: CITY (RSBG.) Proj. # 66/38 Date: 2000

HORIZONTAL CONTROL OCS 27 DCSO

South Zone State Plane Coordinates: Y(Northing) 574,102.51 X(Easting) 1,241,473.00

Precision: 1/20,000 Agency: DCSO Proj. # 2005-2 Date: 1983

Approximate Geographic Position: Latitude 43°12'24" Longitude 123°20'45"

DESCRIPTION and TO REACH

SKETCH

DESCRIPTION:

A disk stamped "51-1" set flush in concrete sidewalk.

TO REACH:

Go to intersection of SE Rose St. and SE Mosher Ave.

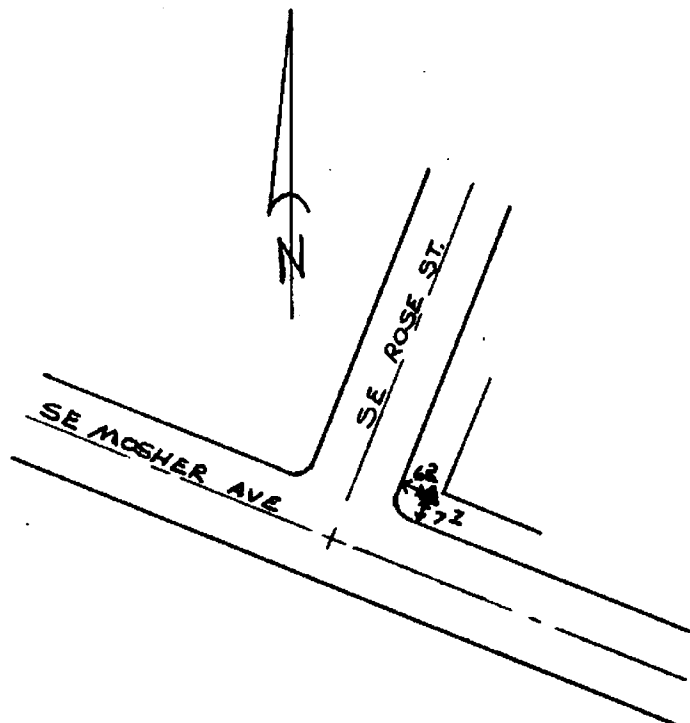

Reference Marks:

Note: For further information, contact the Douglas County Surveyor's Office, Room 205 Douglas County Justice Building, Roseburg, OR 97470. Phone 440-4278. Douglas County residents outside the Roseburg calling area, dial toll free 1-800-452-0991.