

OFFICE OF THE
DOUGLAS COUNTY SURVEYOR

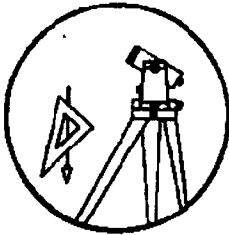

9/01-009

Station: 200-12.04 T 26 S, R 4W, Sec 8
 Set By (Agency): ?
 Date Set: ?
 Recovered By Beecroft
 Date Recovered 3/82
 Recovered By _____
 Date Recovered _____
 Recovered By _____
 Date Recovered _____

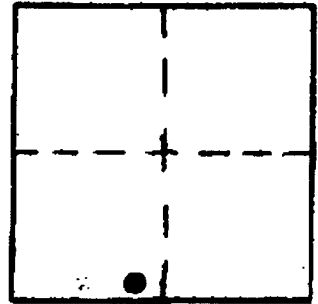

VERTICAL CONTROL NGVD 29 CORCON 6 NAVD 88 642.39 FT
 Elevation: 638.847 NGS Line # _____ USGS Line # _____ OSHD Line # _____
 Precision: 2nd Agency: DGPWD Proj. # 2013 Date: 1982

HORIZONTAL CONTROL
 South Zone State Plane Coordinates: Y(Northing) _____ X(Easting) _____
 Precision: _____ Agency: _____ Proj. # _____ Date: _____
 Approximate Geographic Position: Latitude _____ Longitude _____

DESCRIPTION and TO REACH

SKETCH

DESCRIPTION:

Monument is a 2½ inch brass cap stamped "200-12.04 1982" set in the wing wall of bridge.

TO REACH:

From the intersection of Hwy 99 and Co. Rd. 200 (North Bank Rd.) in T26S,R5W,Sec.18; proceed easterly along Co. Rd.200 approx. 12.0 mi. to monument on left.

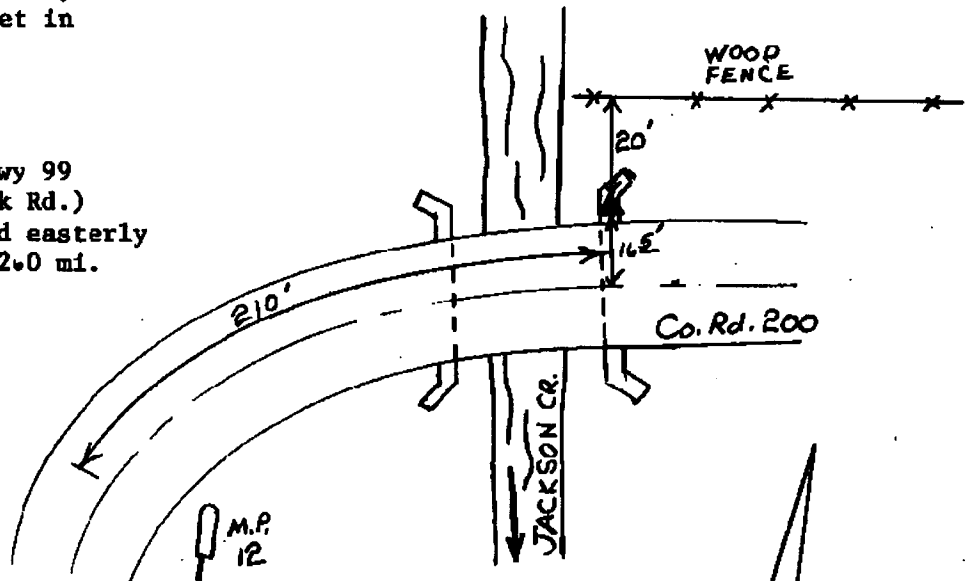

Reference Marks:

Note: For further information, contact the Douglas County Surveyor's Office, Room 205 Douglas County Justice Building, Roseburg, OR 97470. Phone 440-4278. Douglas County residents outside the Roseburg calling area, dial toll free 1-800-452-0991.