

OFFICE OF THE
DOUGLAS COUNTY SURVEYOR

Station: 7M T 26 S, R 2 W, Sec 13
Set By (Agency): USGS
Date Set: 1935
Recovered By RWS,SJF
Date Recovered 11/21/84
Recovered By _____
Date Recovered _____
Recovered By _____
Date Recovered _____

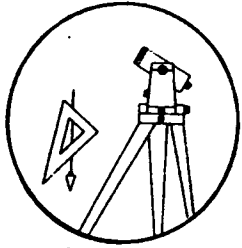

70 - 007

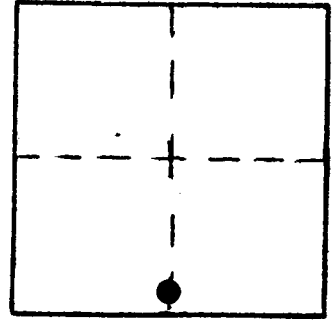

VERTICAL CONTROL

Elevation: 1100.378 NGS Line # 94 USGS Line # _____ OSHD Line # _____
Precision: 1st Agency: USC&GS Proj. # _____ Date: 1961

HORIZONTAL CONTROL CORPSCON6 NAVD88 1104.064 FT.

South Zone State Plane Coordinates: Y(Northing) 604358 X(Easting) 4287060
Precision: GIS SCALED Agency: DCSO Proj. # _____ Date: 2014
Approximate Geographic Position: Latitude _____ Longitude _____

DESCRIPTION and TO REACH

SKETCH

A USC&GS disk stamped "7M 1935" set flush in top of a 2'X2'X3' tall boulder.

TO REACH:

From the intersection of North Umpqua Highway (State Highway #138) and Boundary Road (Co.Rd.#4B.6) in T26S,R2W,Sec.14, proceed easterly along Boundary Road approximately 1.0 miles to crossing of Cole Creek; monument lies approximately 45 ft. north of road and 16 ft. east of main creek flow.

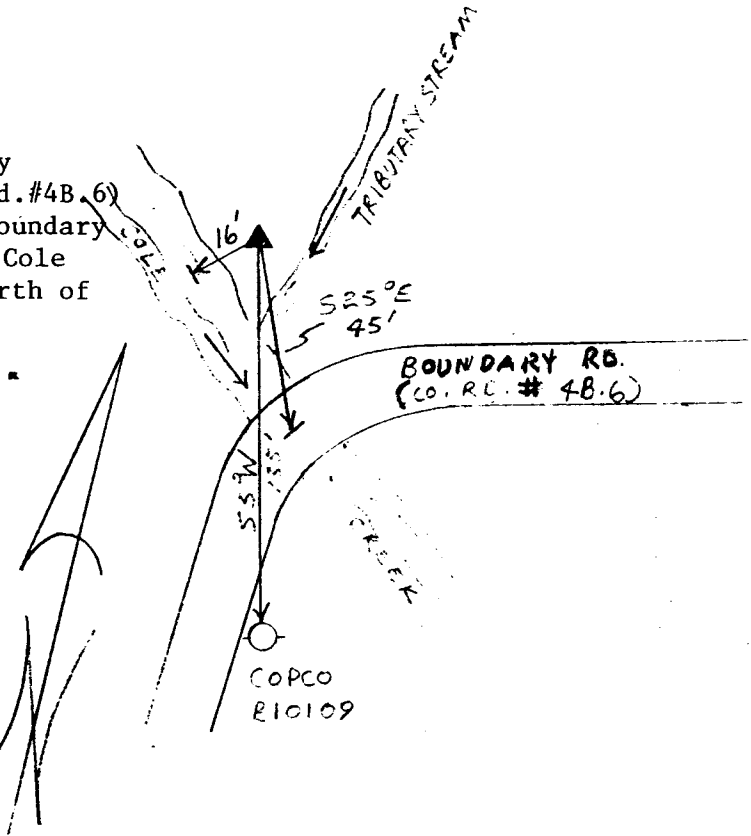

Reference Marks:

Also known as BM 7M; desig. # B-064

Note: For further information, contact the Douglas County Surveyor's Office, Room 205 Douglas County Justice Building, Roseburg, OR 97470. Phone 440-4278. Douglas County residents outside the Roseburg calling area, dial toll free 1-800-452-0991.