

EDGEWATER ESTATES CONDOMINIUM Plat Amendment to PHASE III

BEING A PORTION OF GOVERNMENT LOT 4 IN THE NW 1/4 OF SECTION 1 TOWNSHIP 22 SOUTH RANGE 11 W.W.M. DOUGLAS COUNTY OREGON **Unit 12**

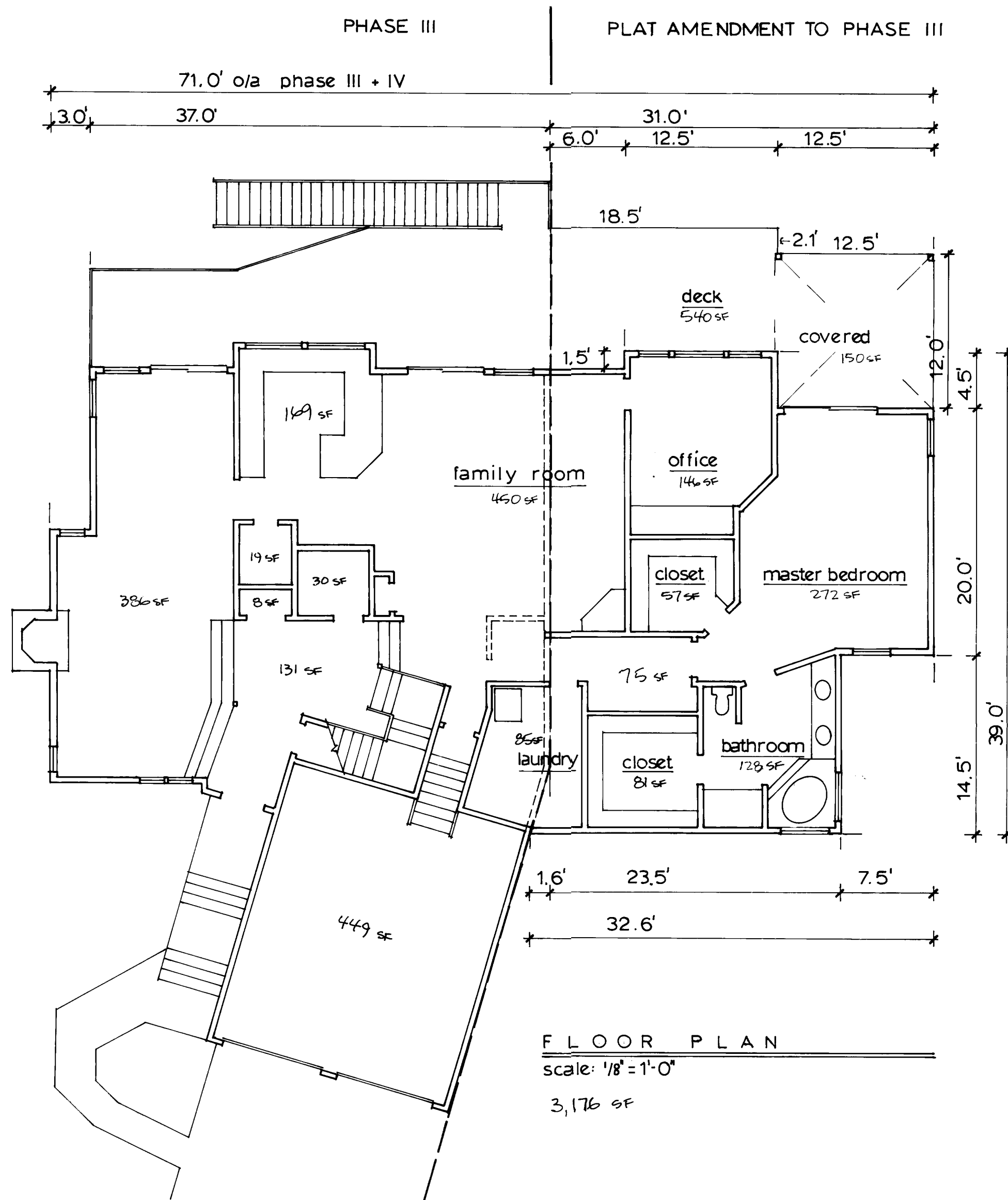

PREPARED BY
MICHAEL L. DADO SURVEYING INC.
2047 GRANT STREET
NORTH BEND, OR. 97459
(541) 756-2281

2000-20084

2000-20084

2000-20084
SHEET 3 OF 4
00-06-333