

BRANDY BAR LANDING

PHASES IV, V, VI & VII - A CONDOMINIUM

LYING IN GOVERNMENT LOTS 8, 9 AND 10 IN S1/2, SECTION 6, T22S, R10W, W.M.

STATE OF OREGON) ss
COUNTY OF DOUGLAS)

I, Donald A. Bentz, being duly sworn, depose and say that I am the surveyor who made the survey and prepared the final map of "BRANDY BAR LANDING, PHASES IV, V, VI, & VII" and that the foregoing tracing is an exact copy of the map thereof.

Donald A. Bentz

Donald A. Bentz, L.S. #834

Subscribed and sworn to before me this 12-16 day of 1980

Doris L. Wadsworth
County Clerk

STATE OF OREGON) ss
COUNTY OF DOUGLAS)

I, Doris Wadsworth, County Clerk of Douglas County, Oregon, do hereby certify that the within copy of plat has been by me compared with the original thereof and that it is an exact copy of the whole thereof as the same appears on file in my office and custody.

Witness my hand and seal this 16th day of Dec., 1980.

Doris L. Wadsworth
County Clerk

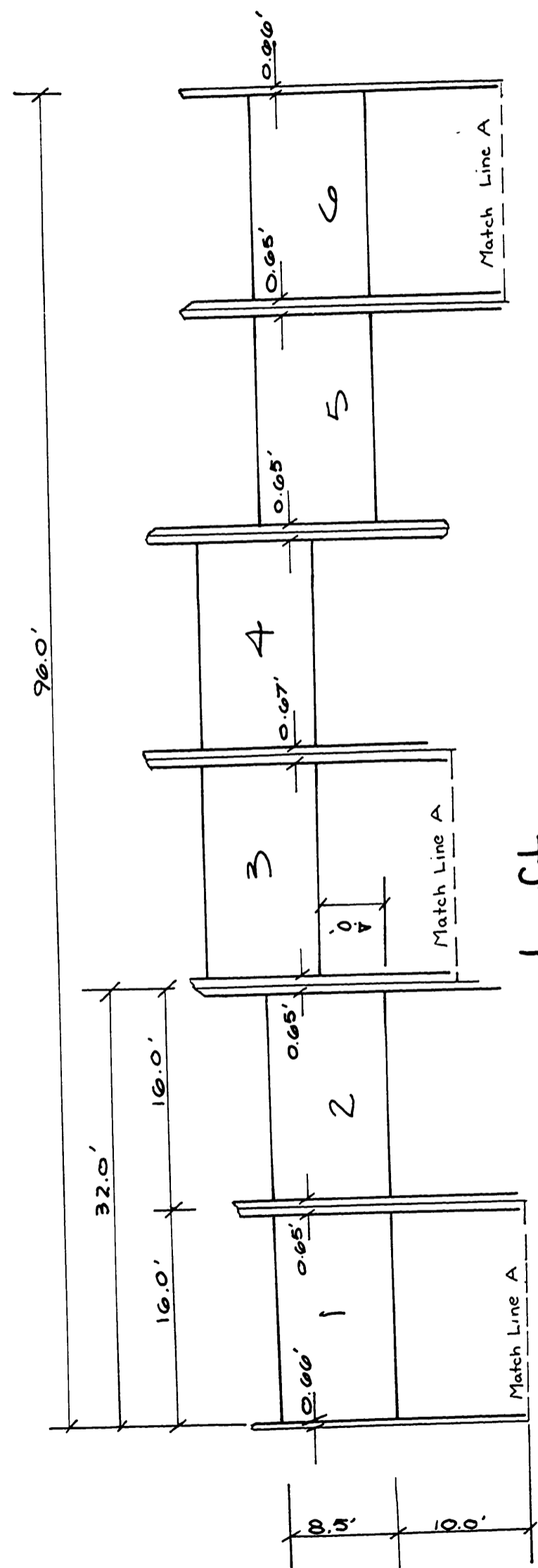

Loft

Scale 1" = 10'

Dimensions shown hereon are to determine unit size only; configuration of the units as shown on page 1 hereof. Exterior dimensions shown are to the centerline of the studs.

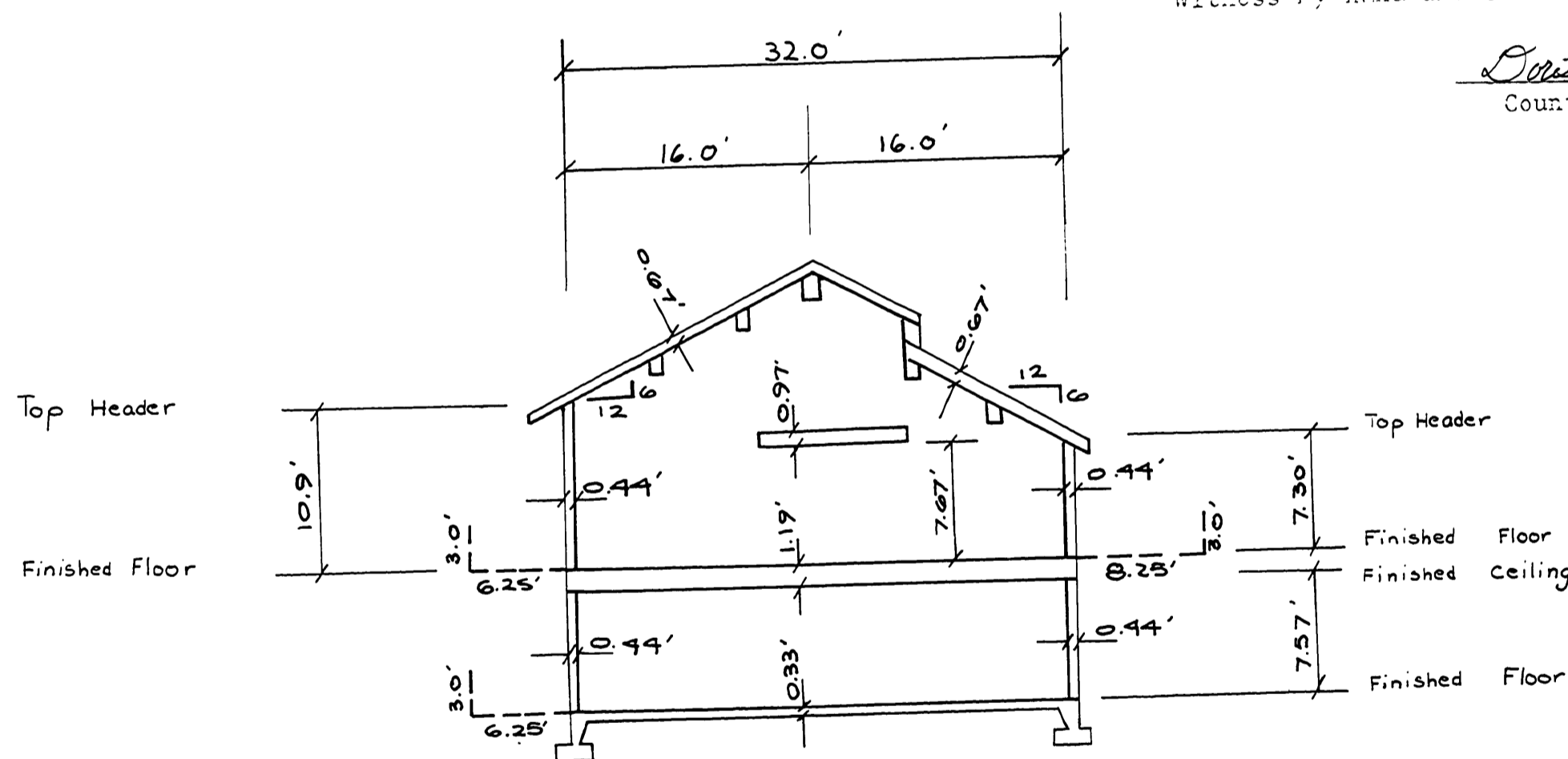

Typical Side View

Scale 1" = 10'
Exterior dimension are to centerlines of studs unless otherwise noted.

VOL. 1 PAGE 7D

VOL. 1 PAGE 7D