

BRANDY BAR LANDING

PHASES I, II & III
A CONDOMINIUM

LYING IN GOVERNMENT LOTS 8, 9 AND 10 IN S 1/2, SECTION 6, T22S, R10W, W.M.

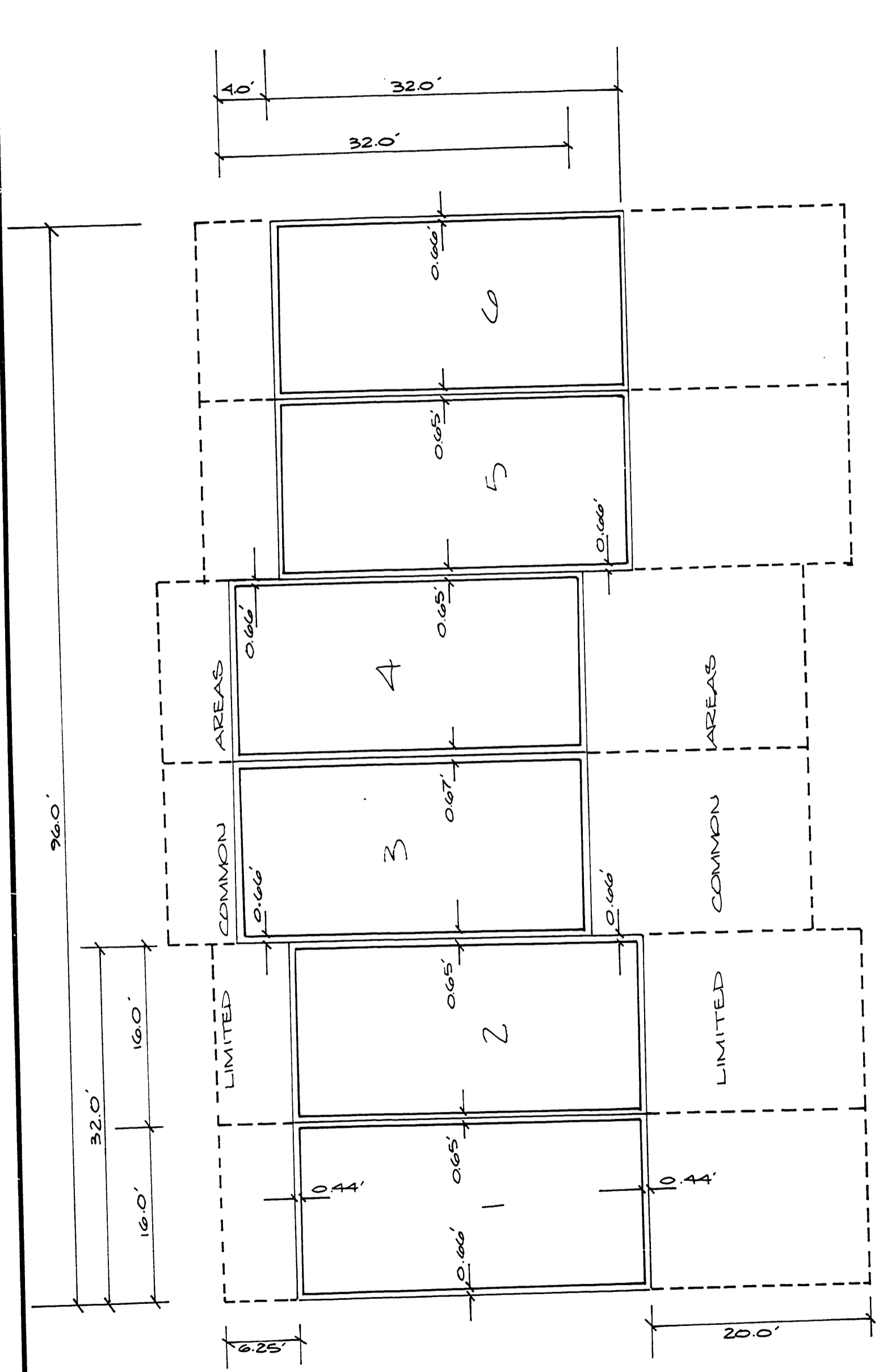

FIRST FLOOR
- TYPICAL BUILDING CONSISTING OF 6 UNITS -
SCALE: 1" = 10'

DIMENSIONS SHOWN HEREON ARE TO DETERMINE UNIT SIZE ONLY; CONFIGURATION OF THE UNITS AS SHOWN ON PAGE 1 HEREOF. EXTERIOR DIMENSIONS SHOWN ARE TO THE CENTERLINE OF THE STUDS.

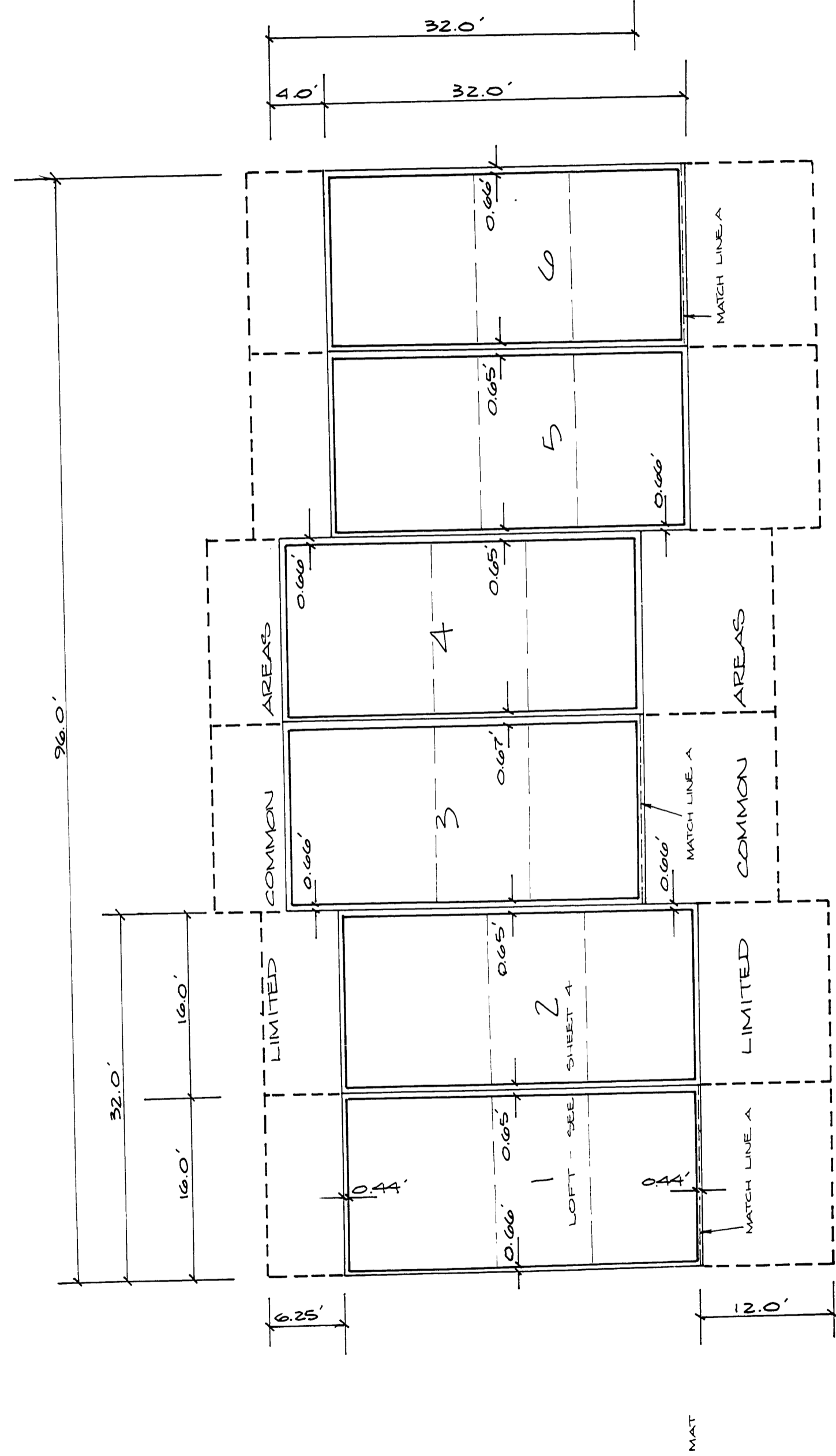

SECOND FLOOR
- TYPICAL BUILDING CONSISTING OF 6 UNITS -
SCALE: 1" = 10'

DIMENSIONS SHOWN HEREON ARE TO DETERMINE UNIT SIZE ONLY; CONFIGURATION OF THE UNITS AS SHOWN ON PAGE 1 HEREOF. EXTERIOR DIMENSIONS SHOWN ARE TO THE CENTERLINE OF THE STUDS.

STATE OF OREGON }
COUNTY OF DOUGLAS } SS

I, DORIS L. WADSWORTH, COUNTY CLERK OF DOUGLAS COUNTY, OREGON, DO HEREBY CERTIFY THAT THE WITHIN COPY OF THE PLAT HAS BEEN COMPARED BY ME WITH THE ORIGINAL THEREOF, AND THAT IT IS AN EXACT COPY OF THE WHOLE THEREOF, AS THE SAME APPEARS ON FILE IN MY OFFICE AND CUSTODY.

WITNESS MY HAND AND OFFICIAL SEAL THIS 26th DAY OF Aug. 1980

Doris L. Wadsworth