

DOUGLAS COUNTY OREGON

AS CONSTRUCTED GRADING & SURFACING CARY STREET CO-OPERATIVE PROJECT AUGUST, 1963

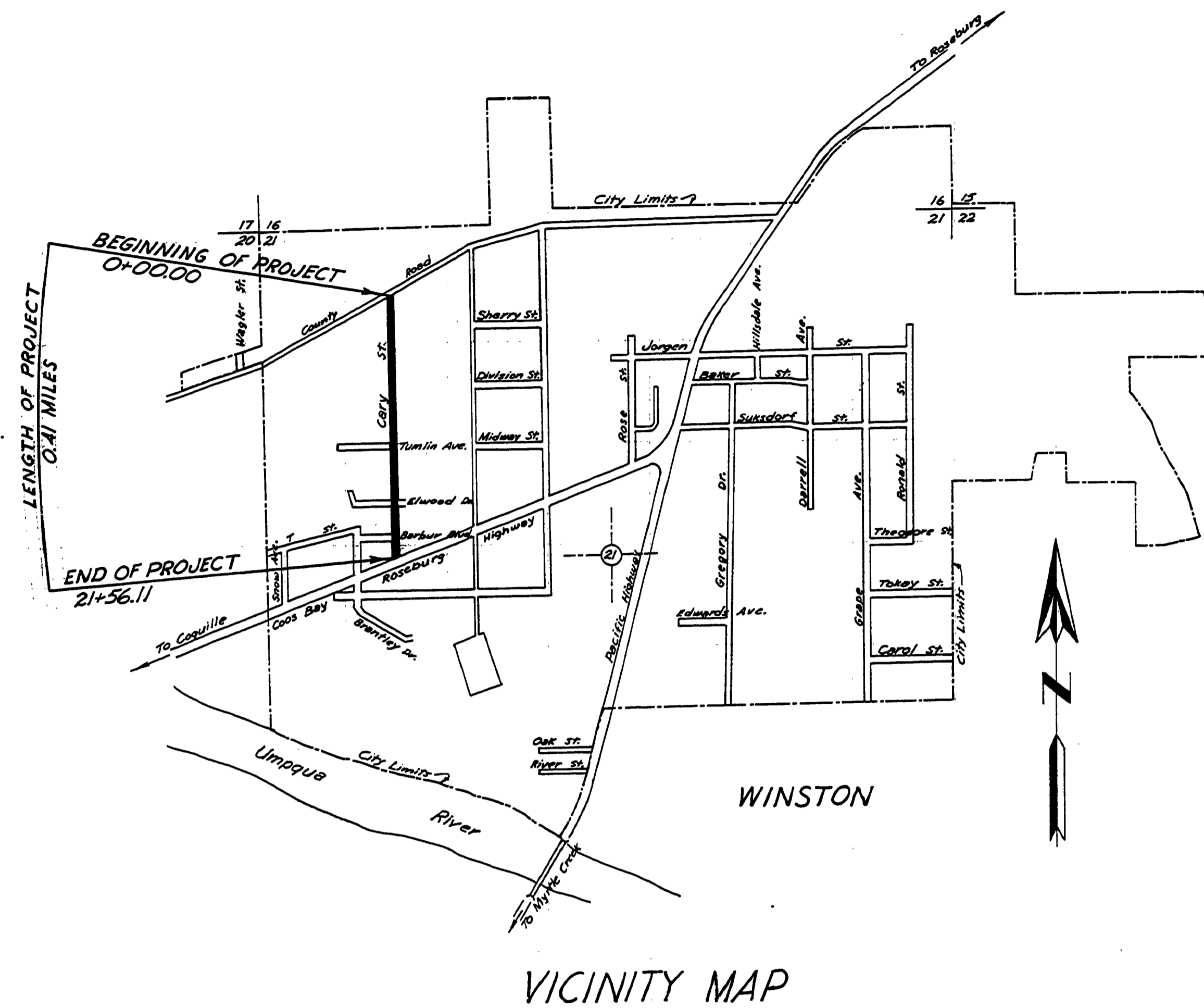

TYPICAL SECTIONS

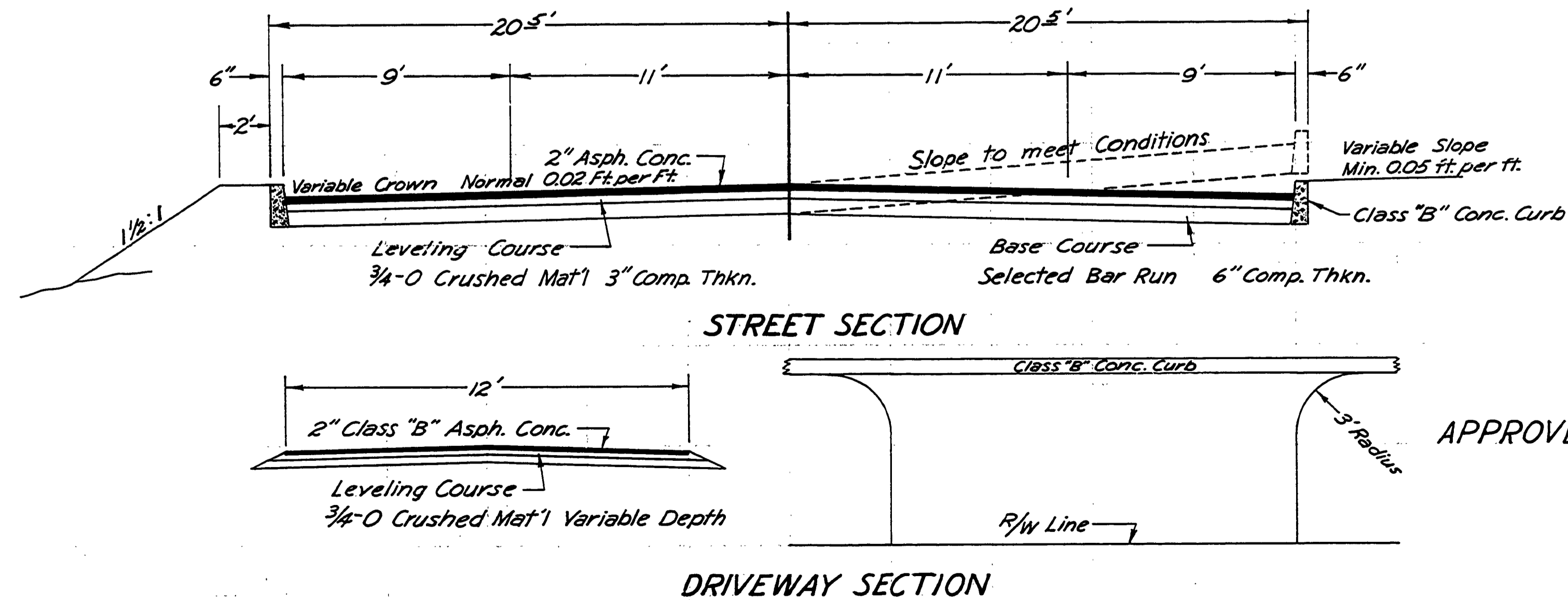

APPROVED *Al. H. May* DATE Aug 9, 1963
County Engineer



FILED
RECEIVED
DEC 11 1963
COUNTY SURVEYOR
DOUGLAS COUNTY, ORE.