

SECS. 23, 14 T 27S R 6W W.M.

PLAN	DATE
SUGGESTED	BY
ALIGNED	BY
CHECKED	BY
NO. OF WAYS CHECKED	
NO.	

PROFILE	DATE
SURVEYED	BY
PLOTTED	BY
CHECKED	BY
NO. OF WAYS CHECKED	
NO.	

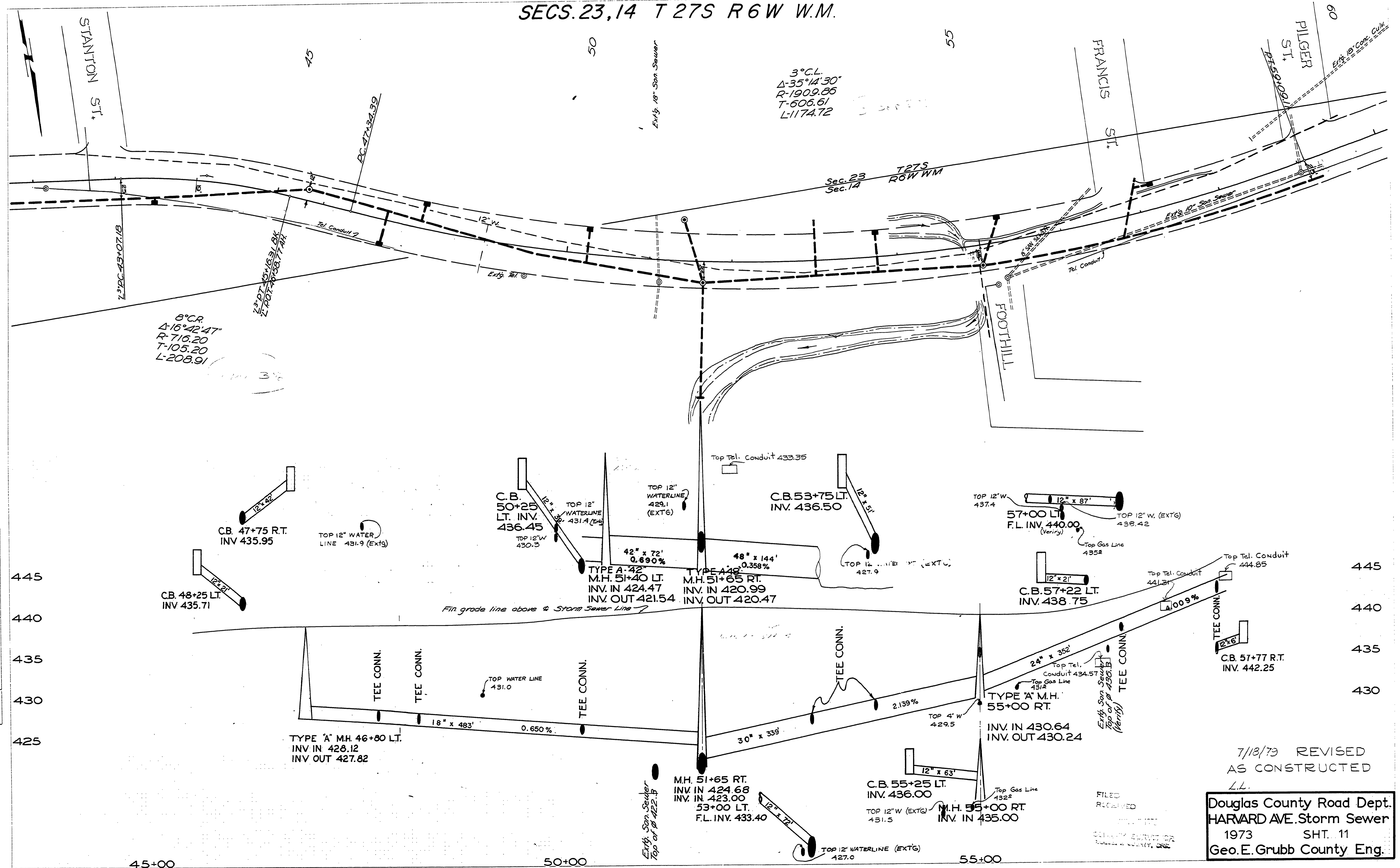

7/18/79 REVISED
AS CONSTRUCTED
L.L.

FILED
RECEIVED

Douglas County Road Dept.
HARVARD AVE. Storm Sewer
1973 SHT. 11
Geo. E. Grubb County Eng.