

PLAN
 SURVEYED...
 PLOTTED...
 CHECKED...
 DATE...
 BY...
 NO.

PROFILE
 SURVEYED...
 PLOTTED...
 CHECKED...
 DATE...
 BY...
 NO.

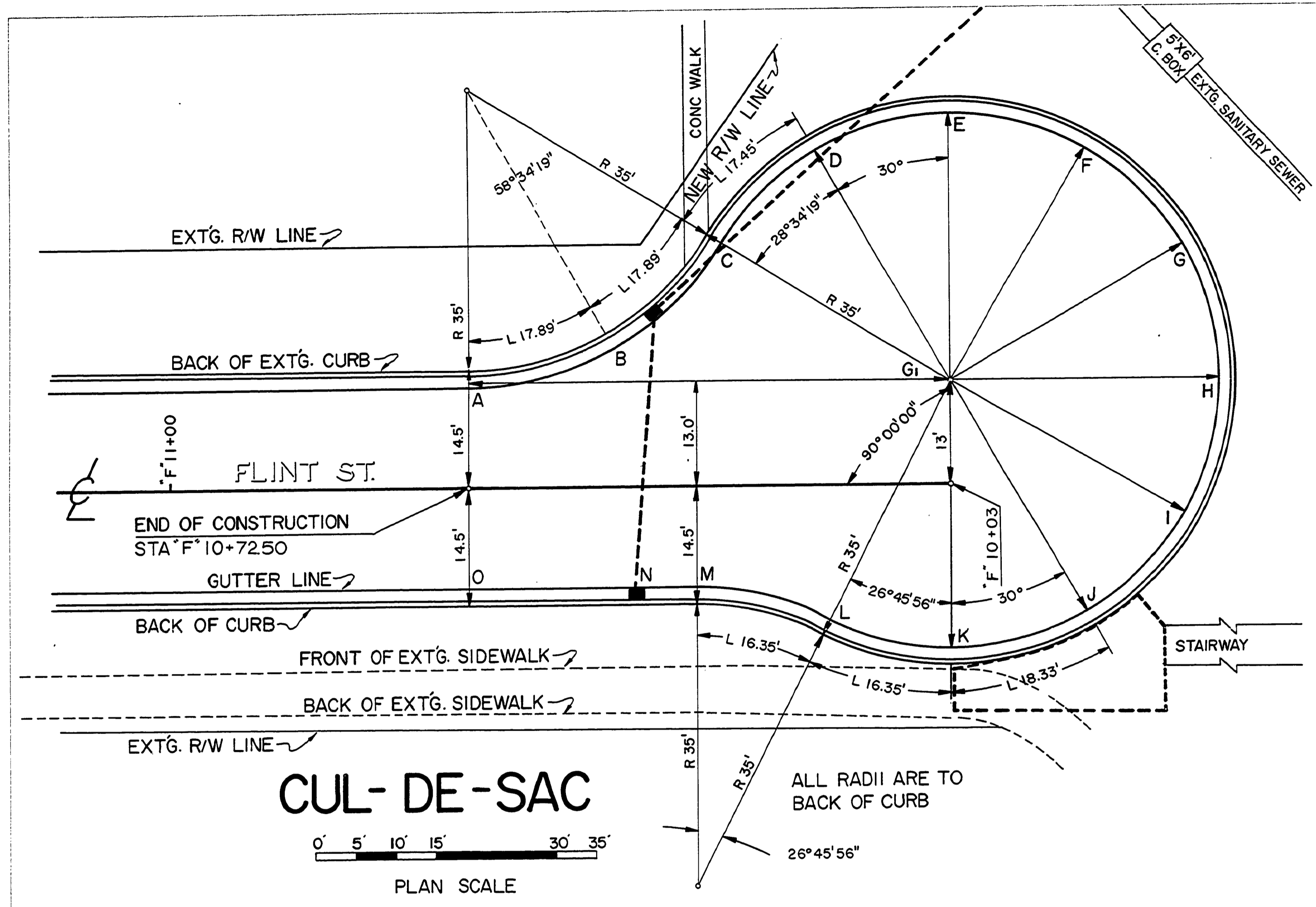

A	B	C	D	E	F	G	H	I	J	K	L	M	N	O	G ₁
446.00	445.85	445.89	446.01	446.14	446.26	446.39	446.43	446.36	446.22	446.07	445.93	445.81	445.79	445.94	446.89

NOTE: CURB, GUTTER AND A.C. PAVEMENT BY OTHERS.

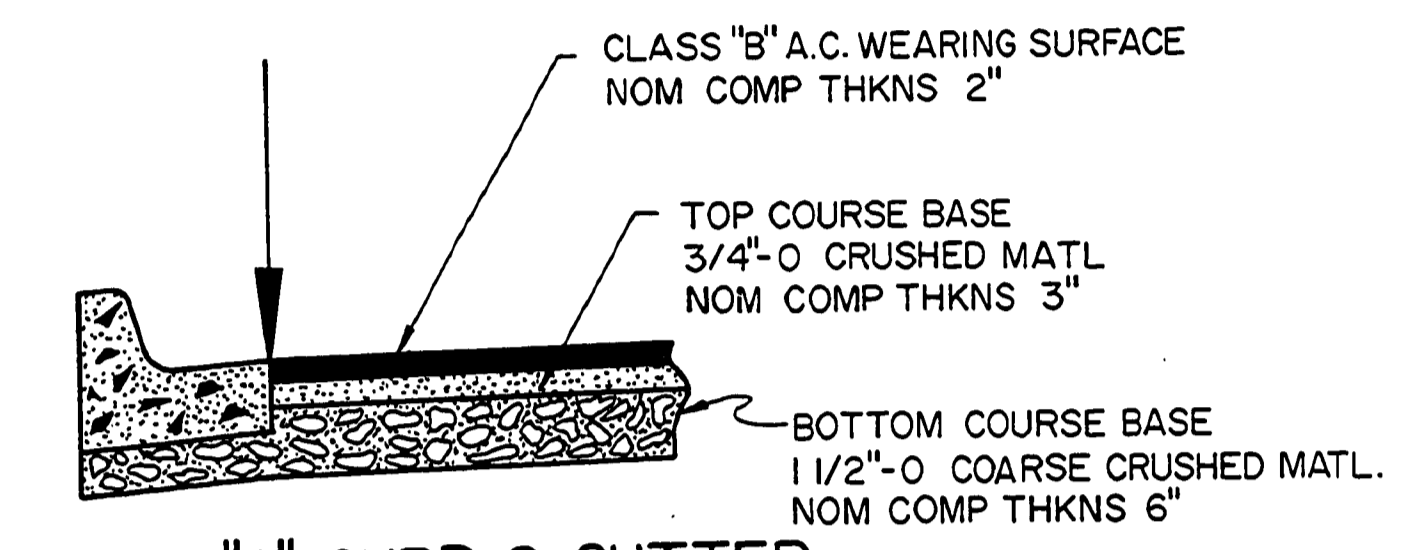

TYPE "B" CURB & GUTTER

ELEVATIONS LISTED CORRESPOND TO LOCATIONS SHOWN

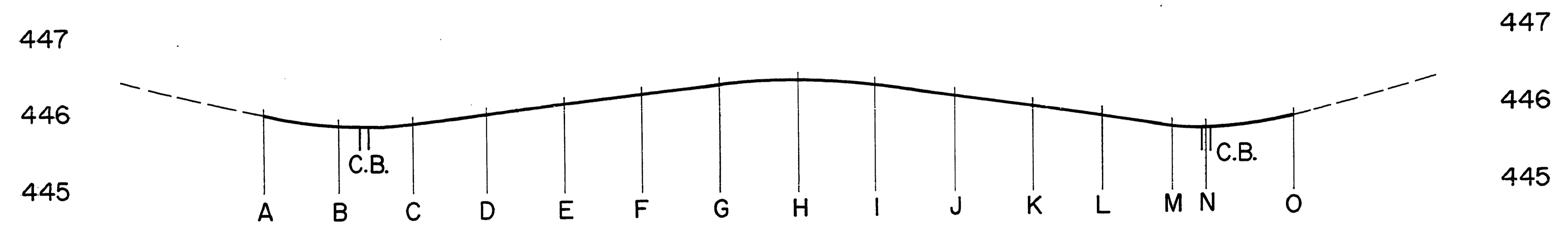

8-22-74 FILE DATE
 REVISED AS BUILT P.H.
 DOUGLAS COUNTY ROAD DEPT
 OAK AVENUE BRIDGE PROJ.
 1972 SHT 11
 GEORGE E. GRUBB COUNTY ENGR.