

RETAINING WALL FOR TRAVELODGE MOTEL

NOTE: ALL VISIBLE SURFACES TO HAVE EXPOSED AGGREGATE FINISH.

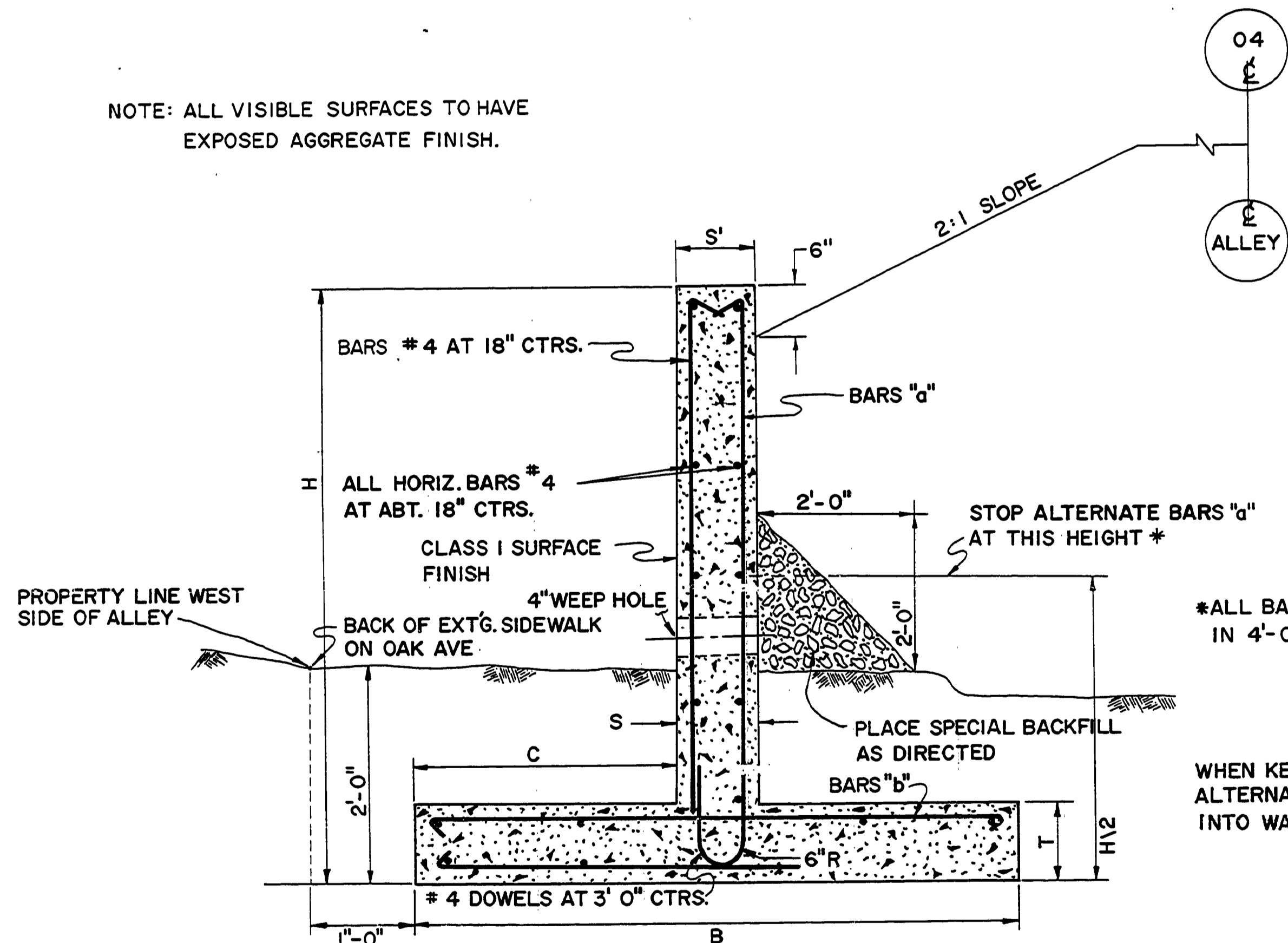

RETAINING WALL FOR APARTMENT HOUSE

LOCATION - WEST SIDE OF ALLEY & SOUTH SIDE OF OAK AVE

H	B	C	S'	S	T	BAR "a"		BAR "b"	
						SIZE	SPACING	SIZE	SPACING
4'-0"	3'-0"	1'-6"	9"	9"	9"	# 4	12"	# 4	12"
6'-0"	4'-4"	1'-7"	9"	9"	9"	# 4	9"	# 4	12"
8'-0"	5'-8"	2'-2"	9"	9"	9"	# 4	9"	# 4	12"
10'-0"	7'-0"	2'-9"	9"	9"	9"	# 5	7"	# 4	12"

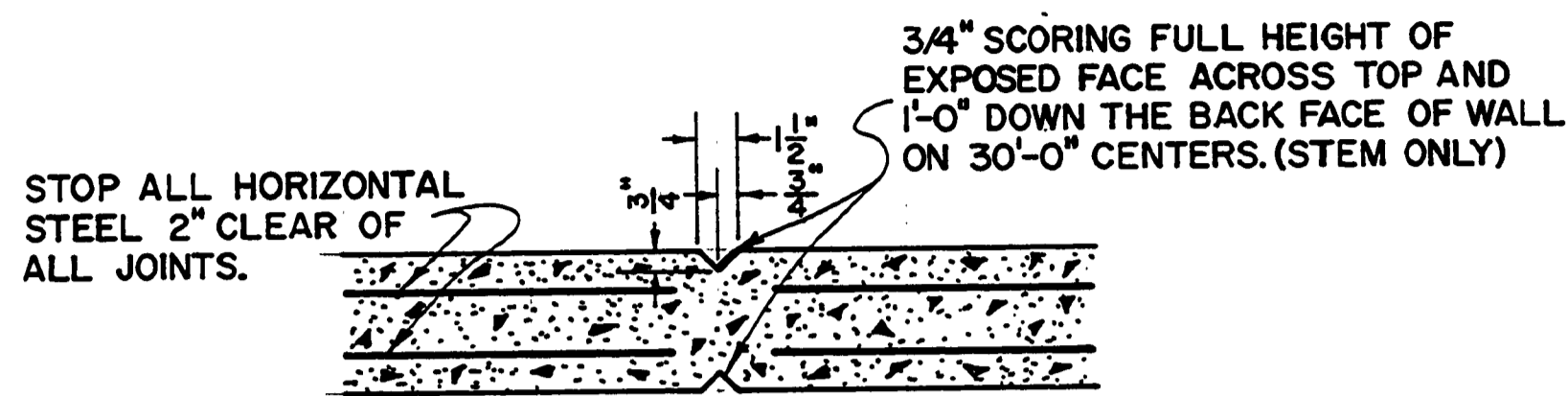

CONTRACTION JOINT

GENERAL NOTES:  
 ALL BARS 1/2" CLEAR OF NEAR FACE.  
 BATTER WALL 1/16" TO COMPENSATE FOR WALL ROTATION.  
 PROVIDE WEEP HOLES NEAR NATURAL GROUND AT 25' INTERVALS.  
 PROVIDE KEY, FOOTING TO STEM, IF SEPERATE POUR.  
 LAP ALL BARS 20 DIAMETERS.  
 REQUIRED EARTHWORK TO BE INCIDENTAL TO RETAINING WALL CONSTRUCTION.  
 LENGTH AND HEIGHT OF WALL TO BE DETERMINED IN FIELD.

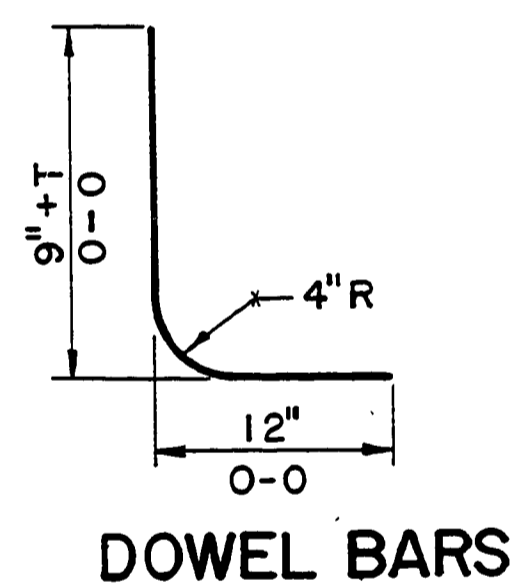

DOWEL BARS

\*ALL BARS ARE FULL HEIGHT IN 4'-00" WALL

WHEN KEY WALL REQD. BEND ALTERNATE BARS "b" INTO WALL

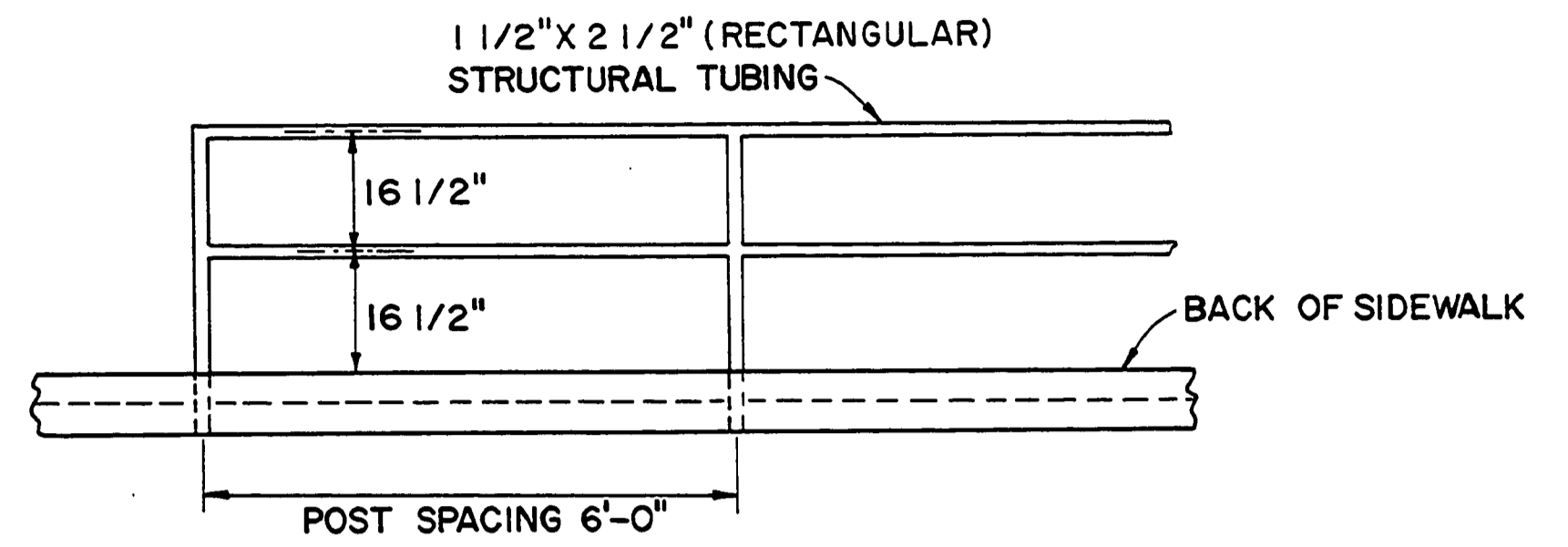

HANDRAIL

LT. SIDE, STA. 0+9+75 TO END OF BRIDGE

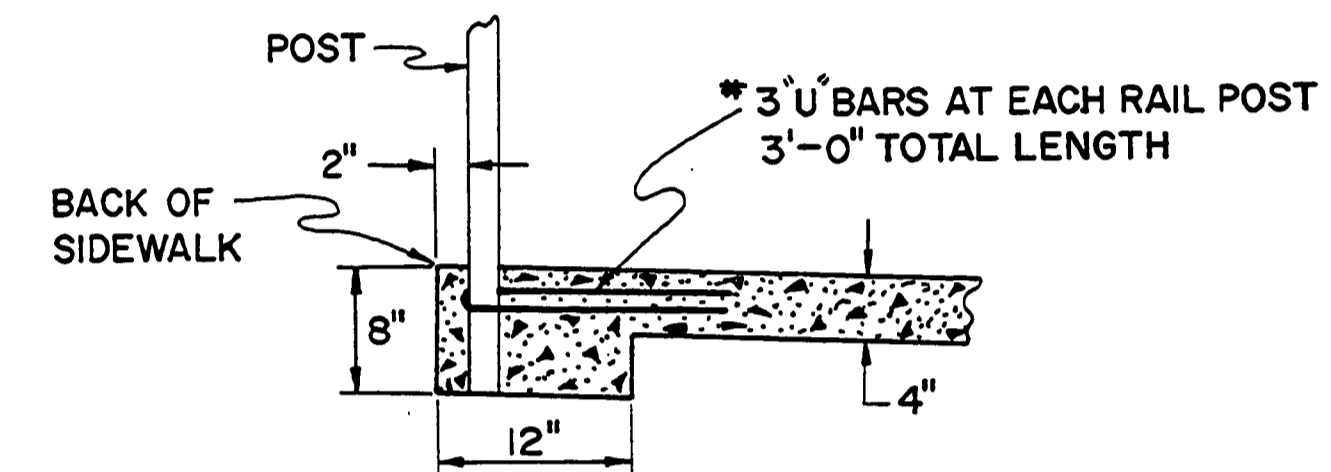

DETAIL OF SIDEWALK & POST IN HANDRAIL SECTION

NOTE: ALL HANDRAIL TO BE HOT-DIP GALVANIZED

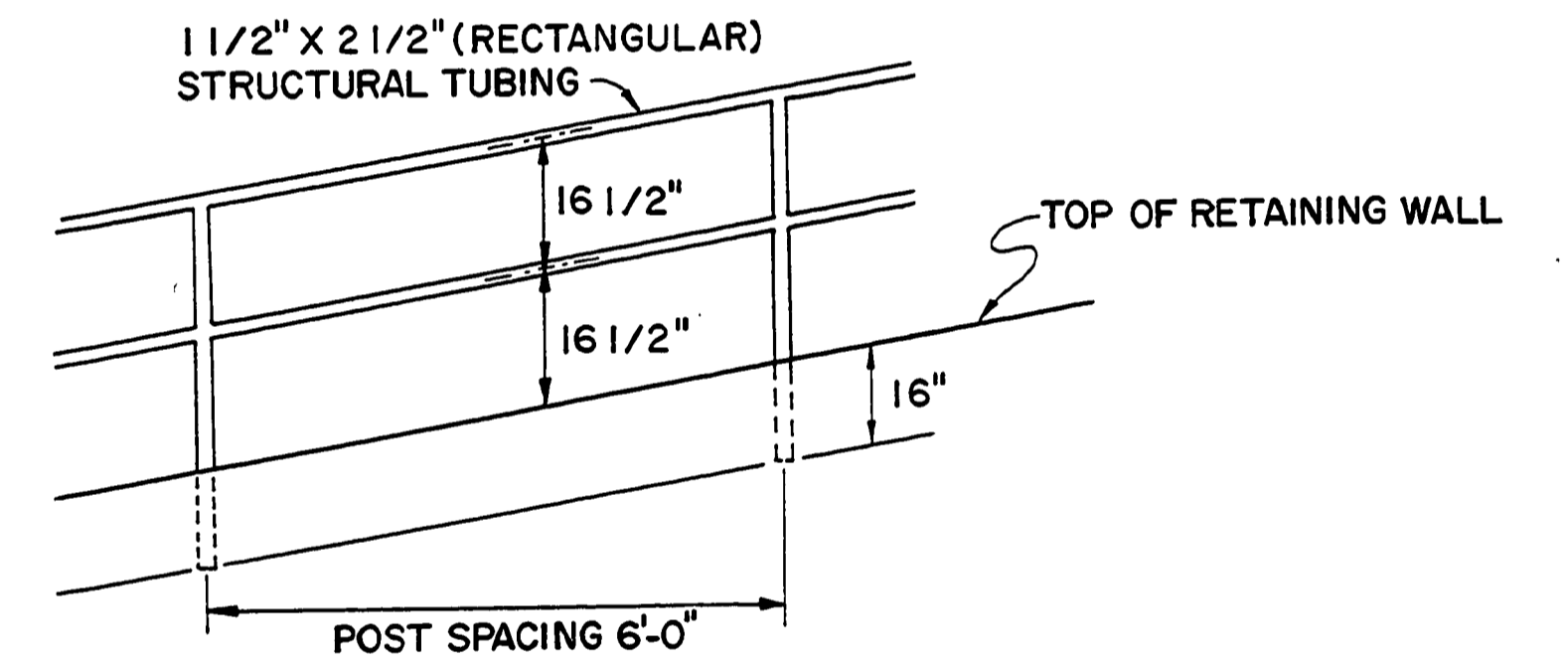

HANDRAIL

TOP OF RET. WALL WEST SIDE OF ALLEY

DOUGLAS COUNTY ROAD DEPT.  
 OAK AVENUE BRIDGE PROJ.  
 1972 SHT 6  
 GEORGE E. GRUBB COUNTY ENGR.