

TOWNSHIP 26S RANGE 6W SEC. 28

PLSS # 300200

Date: 3/19/26 By: ke  
This survey consists of:

DOUGLAS COUNTY OREGON

DATE 3-13-26

Map: \_\_\_\_\_  
Narrative: \_\_\_\_\_  
Corner Rpt: CS 07/02-22

Corner Designation

W.C. SEC COR 29/28  
32/33

DOUGLAS COUNTY  
SURVEYOR

Monument(s) Found: (Condition and Source)

2 1/2" DCSO BRASS CAP  
BURIED 2.0 FT Below  
Ground

Previous Renewals

DCSO 1956 CS 47/67  
DCSO 1964 CS 52/87-43  
Bentz 1985 M 98-51 also M102-24  
DCSO 1987 CS 62/50-10  
DCSO 1988 CS 62/50-10  
Bentz 1991 M 114-52  
See BACK

- Condition report
- Not Found
- Renewed
- Unrecorded
- Surveyed In

MONUMENT DETAIL

COUNTY SURVEYORS  
OFFICE  
T26S R4W  
S29/S28  
S32/S33  
W.C. COR  
13.4 EAST  
TO CORNER

Accessories Found

Rotted SAWN 36" X 1 1/2 FT D. FIR STUMP S43°W  
124.0 FT All Evidence Gone

5/8" I. Rod with yellow 1 1/2 Eng plastic CAP Flush  
N78°W 73.6 FT PER MLP 2001-0074 MOST  
NEW CORNER UNIT 2

5/8" I. Rod with DC Rd. Dept Alum. CAP 1"  
Above Ground S52°W 93.7 FT D.C ROAD #6  
STA 57+01.35 P.T 40' RT

Monument Set (Procedure and Description)

MONUMENT DETAIL

Previous Renewals

- De Groot 1996 P.P 1996-0045
- Rogers 1999 P.P 1999-0021
- Hibbs 2001 P.P 2001-0074
- DCSO-G.I.S Visit 2005 Typed 2011
- De Groot 2006 M151-56

New Accessories

5/8" x 30" I. Rod with DCSO Plastic Cap  
S11°E 13.0 FT proj 2"

5/8" x 30" I. Rod with DCSO Plastic Cap  
S88 1/2° W 7.5 FT proj 2"

5/8" x 30" I. Rod with DCSO Plastic Cap N11°W  
11.0 FT proj 2"

Sketch of Monument, Accessories, and General Area

Location & Comments

BRASS CAP IS 7 FT WEST OF  
VINEYARD DEER FENCE AND 32  
FT SOUTH FROM N.W CORNER OF  
SAME FENCE

MON APPROX 35 FT EAST OF  
E OLD GARDEN VALLEY ROAD

OCRS - POSITION Cottage  
Grove - Canyonville zone

43° 16' 21.61650" N  
123° 25' 34.93157" W

Comp. Decline. 14/19° E  
 Agency DCSO  
 Party Chief S. Krause  
 Note keeper  
 Witnesses J. Larson

CS 07/02-22

pg 2/5

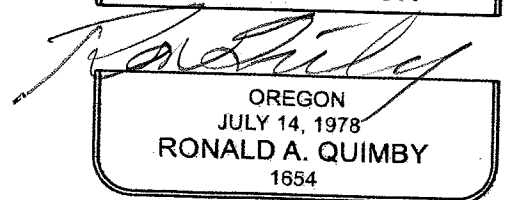
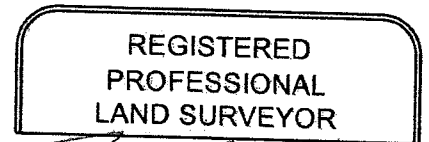

EXPIRES: 12/31/2026

TOWNSHIP 26 RANGE 06 POINT IDENTIFIER # 300200

PRIMARY CORNER DESCRIPTION WC Sec. Cor. for 28, 29, 32 and 33

Alias _____	Description _____
Alias _____	Description <u>DCRS CANYONVILLE COTTAGE GROVE POSITION</u>
Alias _____	Description _____
Alias _____	Description <u>43°16'21.61650"N</u>

123°25'34.93157"W

Original - Elder & Gile, Contract #31 dated April, 1853

-----

Set post cor. to Secs. 28, 29, 33 and 32, from which

- A Y.Oak 14" dia. bears S.38 3/4°E., 92 lks.
- A Y.Oak 16" dia. bears S.35 1/2°W., 128 lks.
- A Y.Oak 14" dia. bears N.6 1/2°E., 556 lks.
- A W.Oak 8" dia. bears N.82 3/4°W., 189 lks.

James W. Byron, Deputy Co. Surveyor - March 9-22, 1956  
C.S. file 47/67

-----  
No trace of orig. BTs found. Corner renewed by traverse from N.W. Corner Lot 4, Plat E, R.H.O.T. using Tract tie. Corner falls in orchard.

Set - An Iron pipe with brass cap for witness corner at County Road R/W mkd. "Wit. Cor. 13.4 ft. East to Section corner 29|28 T26S R6W  
32|33

County Surveyors Office, 1956.

Blazed & Scribed:

- 12" B.Oak N.85 1/2°W., 84.6 ft. mkd. Wit Cor S 29 CS BT.
- 24" R.Fir S.43°W., 125.9 ft. mkd. Wit cor. S 32 CS BT.

No other trees available.

Milo E Godfrey, Deputy - Mike Stone - June 1964 C.S. 52/87-43

-----

Found - Brass cap set by Byron, 1956.  
24" D.Fir S.43°W., 125.9 ft Still in good condition Scar healed over.

The B.Oak to the NW is dead and down.  
New BT - 8" B.Oak N.73°W., 113.2 ft. mkd. "W.C. S28 CS BT".

Found OK, April 1985, D. Bentz, M 98-51. Also M 102-24

DECLINATION 14'14"E

RENEWED 3/13/26

Douglas Co. Surveyors Office - Randall Smith; Stephen Flause  
April 13, 1987 - C.S. File 62/50-10

NOW 2 FT. BELOW GROUND

-----  
Found - A DCSO brass cap on an I.P. set 6" below ground. Date on cap appears to be 1966, should be 1956  
Corner set by survey using Plat E RHOT date 1909 tie to section corner.

NOW ROTTED 36" x 1 1/2 FT TALL 24" SAWN STAMP, ALL BLZ, EVIDENCE GONE GONE NO EVIDENCE

24" now 32" D.Fir with a fully healed double blaze bears S.43°W., 124.0 ft. (Rec. S.43°W., 125.9'

12" now 12" dia. down 7 rotted B.Oak, no blazes or scribing found, bears N.85 1/2°W., 84.6 ft. to root hole. (agrees w/record)

(Cont next Page)

CS 67/62-22 pg 3/5

TOWNSHIP 26 RANGE 06 POINT IDENTIFIER # 300200

PRIMARY CORNER DESCRIPTION Sec. Cor. for 28, 29, 32 and 33

Alias _____	Description _____
Alias _____	Description _____
Alias _____	Description _____
Alias _____	Description _____

~~GONE NO EVIDENCE~~ 8" now 11" dia. B.Oak with a fully healed single blaze bears ~~N.73°W., 113.2 ft.~~ (per record)

New Accessories: (bearings & distances taken to alum. nail at base of trees) (Reference points)

12" dia. Apple with alum. nail at base, bears N.75¾°E., 18.0 ft.

24" dia. Walnut with alum. nail at base bears N.87°E., 75.1 ft.

20" dia. Walnut with alum. nail at base bears S.41½°E., 112.8 ft.

Witness corner lies at west edge of a walnut orchard approx. 27 ft. east of centerline to Co. Rd. #6 (Garden Valley Rd.)

Witness Corner may be disturbed by Road construction in near future.

Dougl. Co. Surveyors Office - S.J. Flause; R.W. Smith  
Feb. 12, 1988 - C.S File 62/50-10

CORNER REPORT ONLY (SEE 1987 RENEWAL FOR DETAILS) 2 FT.  
Found - Brass cap monument as described in 1987 but now 12" below ground surface having been buried some by new road fill.

Found all accessories as described in 1987 with the exception of S.43°W., D.Fir; this is now a 1½ ft. tall 40" dia. Fir stump with part of the upper blaze & the entire lower blaze remaining intact. Both blazes remain fully healed

Found BC WC Donald Bentz, Oct. 1991, M 114 - 52  
Fd. OK by DeGroot, May 1996 - 1996-0045  
Fd. Ok by Wayne Rogers 2/1999 - 1999-0021  
Fd. OK by N. Hibbs, Jan. 2001 - 2001-0074

DCSO-GIS Corner visitation - 10/4/2005 - Typed: 1/26/2011 - C.S. File 67/33-1

Monument - BC/IP 1¼" IP (WC)  
Comment - OK

Fd. Ok by K. DeGroot -10/2006 - M151-56

**FND. TIED SURVEY MONUMENTS:**

A 5/8" I.R. / YELLOW "I.E. ENG" PLASTIC CAP SET WITH TOP FLUSH WITH GROUND. MONUMENT IS FROM SURVEY FILED AS M132-29 AND IS THE MOST NE'LY CORNER OF UNIT 1 BEARS N78°W, 73.6 FT. DIST AS PER MLP 2001-0074.

A 5/8" I.R. / DC RD. DEPT. ALUMINUM CAP SET PROT. 1" ABOVE GROUND. MONUMENT IS FROM DOUGLAS COUNTY 1987 PROJECT ON COUNTY ROAD 6A. MONUMENT IS FIRST SHOWN TIED TO ABOVE "I.E. IRON ROD IN MAP 132-29. THIS MONUMENT BEARS S52°W, 93Z FT DIST. AGREES WITH COMPUTED TIE USING MLP'S 2001-0074 AND 2005-0016.

OVER →

GONE NO EVIDENCE  
ORCHARD REPLACED  
BY VINEYARD

ROAD REALIGNED

pg 4/5

CS 67162-22

ADDITIONAL REFERENCES TO HELP FIND BURIED WITNESS CORNER;

A 5/8" x 30" I.R. / DC SO YELLOW SET PROT 2"; BEARS S 11° E, 13° FT, DISTANT  
PLASTIC CAP  
" " " ; BEARS S 88 1/2° W, 7 1/2 " "  
" " " ; BEARS N 11° W, 11° " "

BRASS CAP MONUMENT IS 7 FT. WEST FROM A VINEYARD DEER FENCE AND  
32 FT. SOUTH FROM A NW CORNER OF SAME FENCE.

MONUMENT IS APPROX 35 FT. EAST FROM THE  $\Phi$  OF OLD GARDEN VALLEY RD.