

GOVERNMENT CORNER RESTORATION FORM

FILED

TOWNSHIP 245 RANGE 2W SEC. 28

PLSS # 30020

Date: 1/28/20 By: KE  
This survey consists of:

DOUGLAS COUNTY OREGON

DATE 1-20-20

Map: \_\_\_\_\_

Narrative: \_\_\_\_\_

Corner Rpt: CS 67/62-01

Corner Designation

Sec Cor 529/528  
532/533

DOUGLAS COUNTY  
SURVEYOR

Monument(s) Found: (Condition and Source)

2 1/2" GLO BRASS CAP  
Proj 15"

\_\_\_ Condition report

\_\_\_ Not Found

Renewed

\_\_\_ Unrecorded

\_\_\_ Surveyed In

Previous Renewals

GLO Survey 1893 Vol 7 pg 2913  
BLM Resurvey 1951-1963  
Vol 32 pg 13299  
Mc Chesney 1970 CS 53/110-15  
RICE 2012 CS 65/77-37  
BAKER 2018 CS 65/103-2

MONUMENT DETAIL

T 245 R 2W  
529/528  
532/33  
1951

Accessories Found

BURNED - DEAD 28" D. FIR N 45° E 26.7 FT  
(REC 27.7) Fully Healed Single BLAZE

BURNED - DEAD 18" D FIR S 18° E 21.6 FT  
Fully Healed Single BLAZE

BURNED - DEAD 30" D. FIR S 75° W 8.9 FT  
(REC 9.0 FT) Fully Healed Single BLAZE

BURNED - DEAD 20" D. FIR N 70° W 19.3 FT  
(REC N 61° W 20.0 FT) Fully Healed Single  
BLAZE

Steel Post 1 ft South

Weyerhaeuser 1 1/4" I.D. IP Proj 18" S 57° E  
13.2 FT CS 53/110-15

New Accessories

ADD Rough mound of stone AROUND MON.

ADD 3 1/2" MAG NAIL RIGHT SIDE CENTER TO ALL TREES

Sketch of Monument, Accessories, and General Area

Location & Comments

MON IS APPROX 20 FT INSIDE BURNED FOREST TO SOUTH LARGE CLEARCUT TO NORTH

MON IS APPROX 400' SOUTH FROM END OF GRAVE SPIR

AREA BURNED 9/2020

Trimble Geo XT position AB. 44440615 N 122.95029237 W

Comp. Decline. 14'14"E Agency DCSO Party Chief S. Fause Note keeper Witnesses J. Loring

CS 67162-01

pg 2/4

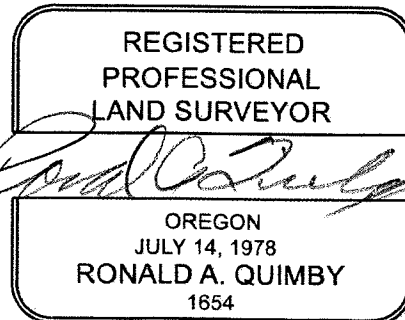

EXPIRES: 12/31/2026

PRIMARY CORNER DESCRIPTION Cor. Secs. 28, 29, 32, & 33

Alias _____	Description _____
Alias _____	Description _____
Alias _____	Description _____
Alias _____	Description _____

MINI GIS  
43.44439  
122.95027

GLO survey by John. A. McQuinn, Deputy Surveyor, under Contract #466 dated April 1883 - (DCSO recs Vol. 7 Page 2886)

-----  
Set a cedar post, 4 ft. long, 4" sq. 24" in the ground, for cor. to secs. 28, 29, 32, & 33, marked T24S S28 on NE, R2W S33 on SE, S32 on SW, S29 on NW faces, with 1 notch on S & 4 notches on E edges; from which

- A fir, 5" dia. bears N.70°E., 20 lks. mkd: T24S R2W S28 BT
- A fir, 8" dia. bears S.20°W., 10 lks. mkd: T24S R2W S33 BT
- A fir, 5" dia. bears S.60°W., 18 lks. mkd: T24S R2W S32 BT
- A fir, 10" dia. bears N.15°W. 22 lks. mkd: T24S R2W S29 BT

Fd. & used on GLO Survey by Henry L. Chandler, U.S. Deputy Surveyor, under Contract #619 dated June 5, 1893 - (DCSO records Vol. 7 Page(s) 2913)

BLM dependent resurvey Levi E Tallett, Cadastral Engineer (1951) and C. Albert White, Cadastral Surveyor (1963), under Group # 294, surveyed May 1951 - Aug 1963 - (DCSO records Vol. 32 Page(s) 13299)

-----  
Point for the cor. of secs. 28, 29, 32 & 33, at proportionate distance; there is no remaining evidence of the orig. corner. Set an iron post, 36" long, 2" dia., 24" in the ground to solid rock, and in a mound of stone, 4 ft. base to top, with brass cap marked:

T24S	R2W
S 29	S 28
S 32	S 33
1951	

from which

- A fir, 11" dia. bears N.46°E. 42 lks. mkd: T24S R2W S28 BT
- A fir, 14" dia. bears S.19°E. 33 lks. mkd: T24S R2W S33 BT
- A fir, 16" dia. bears S.75°W. 15 lks. mkd: T24S R2W S32 BT
- A fir, 12" dia. bears N.7°W. 30 lks. mkd: T24S R2W S29 BT

FD. ok by Glenn McChesney, WEYCO, 4/8/1970 - C.S. File 53/110-15 - Added "W" nail & plate.

Ron Rice, NW Land Surveying - Jason Collver - Sept. 6, 2012 - C.S. File 65/77-37

*2 1/2" B.C. MARKED AS DESCR 351-63 BLM PRDT. 15"*

Found - 2" dia. Iron post with BLM brass cap dated 1951  
A fir, 11" dia. bears N.46°E., 42 lks. mkd: T24S R2W S28 BT (Fd 26" D. Fir with healed face)  
A fir, 14" dia. bears S.19°E. 33 lks. mkd: T24S R2W S33 BT (Fd 18" D. Fir with healed face)  
A fir, 16" dia. bears S.75°W. 15 lks. mkd: T24S R2W S32 BT (Fd 29" D. Fir with healed face) cont.

TOWNSHIP 24 RANGE 02 POINT IDENTIFIER # 300200

PRIMARY CORNER DESCRIPTION Cor Secs 28, 29, 32, & 33

Alias _____	Description _____
Alias _____	Description <u>TRIMBLE GEO XT POSITION</u>
Alias _____	Description _____
Alias _____	Description <u>43.44440618</u>
	<u>122.95029237</u>

Note- A fir, 12" dia. bears N.7°W. 30 lks. mkd: T24S R2W S29 BT (Fd 18" D.Fir with healed face)  
 Corner has steel post adjacent to it. All BTs have orange painted bands and yellow tags.  
 Declination 16° East

Dan Baker - For: Weyerhaeuser Co. - 12/2018 - C.S. 65/103-2

*RENEWED 1/20/26*

Found - ~~2 1/2"~~ <sup>MARKED AS DESCRIBD 51-63</sup> GLO brass cap "1951" on 2" iron post (up 0.6 ft) *PROT. 15"*

*BURNED DEAD - 28" 27" D. Fir ✓ N.48° E., 27.26' to spike side/center-1951 REC. SIDE SPIKES ARE GONE*  
*BURNED DEAD - 18" 18" D. Fir ✓ S.18° E., 21.0' to spike side/center-1951 ALL B.T.'S NOW HAVE 3 1/2" MAG NAIL SET R.S.C.*  
*BURNED DEAD 30" 32" D. Fir ✓ S.75° W., 8.8' to spike side/center-1951 GLO BT (Record = S.75° W., 15 lks. + 9" FHSB)*  
*BURNED DEAD 20" 18" D. Fir ✓ N.07° W., 19.2' to spike side/center-1951 GLO BT (Record = N.7° W., 30 lks. ✓ FHSB)*

*FOUND STEEL LATH SOUTH 1 FT. FROM 1948 WEYERHAEUSER SURVEY A 1/4" I.D.I.P. PROT. 18" BEARING S57° E 13 1/2 FT. DISTANT (SEE C.S. 53/110-15)*  
*ADD ROUGH MOUND OF STONE AROUND B, C. MON.*

*B, C. MON IS ON MODERATELY STEEP EAST SLOPE APPROX. 20 FT INSIDE BURNED FOREST EXTENDING SOUTH, VERY LARGE CLEARCUT TO NORTH.  
 MON. IS APPROX. 400 FT. SOUTH FROM END OF GRAVELLED SPUR ROAD.*