

TOWNSHIP 24S RANGE 2W SEC. 34 PLSS # 500140

Date: 11/2/20 By: ke
This survey consists of:

DOUGLAS COUNTY OREGON

DATE 12-18-25

Map: _____

Narrative: _____

Corner Rpt: CS 671161-55

Corner Designation

1/4 COR 34/35

DOUGLAS COUNTY
SURVEYOR

Monument(s) Found: (Condition and Source)

Condition report

Not Found

Renewed

Unrecorded

Surveyed In

None

Cut bank shd. away to
MON

Previous Renewals

BLM Resurvey 1951-1963 Vol

32 pg 13232-3

EDWARDS 2008 M156-7

MONUMENT DETAIL

Accessories Found

Burned - dead 27" D. FIRE N10 1/2° W 79.2 FT
(REC 146 LKS 96.4 FT) Fully Healed Single
BLAZE

BURVED DEAD 27" D. FIRE S83° E 44.2 FT
FULLY HEALED SINGLE BLAZE

Galvanized Steel Post is Set 1 Foot
North of Monument

Monument Set (Procedure and Description)

MONUMENT DETAIL

5/8" x 30" Iron Rod with
1 1/2" Douglas Co. Surveyor
Alum Cap protruding 8" Above
Ground. Mon Location Determined
By GPS Survey TIEING INTO
M 156-7. THIS POSITION AGREES

New Accessories

with record bearing and distance to
S.E. bearing tree bearing to N.W. tree
agrees with record the distance appears
to be erroneous.

New BTS BRNG & DIST by G.P.S

5/8" x 60" Iron Rod with DCSO yellow Plastic
Cap S 13° 07' 29" W 58.9 FT CAP PROJ. 8"

5/8" x 60" Iron Rod with DCSO yellow Plastic
Cap S 86° 52' 51" W 60.8 FT PROJ 10"

Both I. Rod ARE IN NARROW WEST SHOULDER
OF GRAVEL ROAD

Sketch of Monument, Accessories, and General Area

Location & Comments

CORNER MONUMENT IS NEAR
TOP OF STEEP CUTBANK ON
EAST SIDE OF GRAVEL ROAD
BURNED OLD GROWTH TO
EAST LARGE RECENT CLEARCUT
TO WEST

OARS COORDINATE SYSTEM
COTTAGE GROVE - CANYONVILLE
ZONE

N 222117.831
E 278937.760

AREA BURST
9/2020
Comp. Decline. 14/14° E
Agency DCSO
Party Chief S. F. HAUSE
Note keeper
Witnesses J. LORSUNG

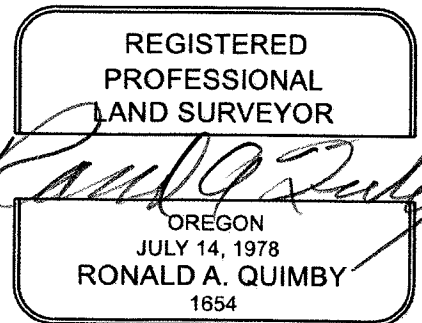

EXPIRES: 12/31/2026

MINOR COBBLE CRK. ON RIGHT
UP SIDE RD. ABOVE RD.

TOWNSHIP 24 RANGE 02 POINT IDENTIFIER # 500140

PRIMARY CORNER DESCRIPTION 1/4 Cor. Secs. 34 & 35

Alias _____	Description _____
Alias _____	Description <u>TRIMBLE GEO XT POSITION</u>
Alias _____	Description _____
Alias _____	Description <u>43.</u> <u>122.</u>

MIN 1019
43.44/192
122.912/10

GLO Survey by Henry L. Chandler, U.S. Deputy Surveyor, under Contract #619 dated June 5, 1893 - (DCSO records Vol. 7 Page(s) 2902)

Set a basalt stone 10x9x8" 7" in the ground for 1/4 sec. cor. marked 1/4 on W face, from which
A pine, 8" dia., bears S.39°E., 42 lks., mkd: 1/4 S BT.
A chinquapin, 5" dia., bears N.56°W., 7 lks., mkd: 1/4 S BT.

BLM dependent resurvey Levi E Tallett, Cadastral Engineer (1951) and C. Albert White, Cadastral Surveyor (1963), under Group # 294, surveyed May 1951 - Aug 1963 - (DCSO records Vol. 32 Page(s) 13292-3)

DECLINATION 14 1/4 °E ----- RENEWED 12/18/25
The 1/4 sec. cor. of secs. 34 & 35, monumented with a basalt stone, 10x9x8"; firmly set, marked 1/4 on W face, from which the orig. BTs:

NO EVIDENCE

A chinquapin, 5" dia., bears N.71°W., 7 lks., with blaze rotted out. (In 1951) (Rec. bearing, N.56°W.) This tree has disappeared by 1963
A pine, 14" dia., bears S.39 1/4°E., 42 lks., blaze partially healed & has been cut open, with scribe mark 4 visible. (Rec. bearing S.39°E.)

ONE PINE ROOT NEAR B&D

At the corner point
Set an iron post, 36" long, 1" dia., 28" in the ground, with brass cap mkd:

CUT BANK SLID AWAY B.C. MONUMENT AND STONE NOT FOUND

S 34 | S 35
1951

from which
fir, 15" dia., bears N.10 1/2°W., 46 lks., mkd: 1/4 S34 BT. (1963 BT) FHSB

BURNED DEAD 27" AD

27" AD fir, 14" dia., bears S.83°E., 67 lks., mkd: 1/4 S35 BT. (1951 BT, 20" dia., with blaze healed in 1963) FHSB
Bury the orig. corner stone alongside the iron post.

FD BC & 2 BTs, D. Edwards 5/2008 - M156-7

LOCATION OF CORNER MONUMENT IS DETERMINED BY GPS SURVEY TIEING INTO THE DAVID EDWARDS SURVEY M156-7. THIS CORNER POSITION AGREES WITH RECORD BEARING AND DISTANCE TO SE BEARING TREE. BEARING TO NW TREE AGREES WITH RECORD BUT THE RECORD DISTANCE WOULD APPEAR TO BE ERRONEOUS. AT THE DETERMINED CORNER POSITION IS SET A 5/8" X 30" IRDN ROD WITH A 1/2" DIA. DOUGLAS CO. SURVEYOR ALUMINUM CAP, PROTRUDING 8" ABOVE GROUND. A GALVANIZED STEEL LATH IS SET 1 FOOT NORTH FROM I.R./ALL. MONUMENT
TWO NEW ACCESSORIES ARE ESTABLISHED AND THEIR POSITIONS RELATIVE TO THE CORNER MONUMENT ARE DETERMINED (OVER) →

UTILIZING OCRS CANYONVILLE, COTTAGE GROVE COORDINATES
BEARINGS AND DISTANCES TO THE NEW ACCESSORIES ARE OCRS INVERSES.

A 5/8" X 60" IRON ROD WITH A D.C.S.O. YELLOW PLASTIC CAP SET PROT. 8 INCHES;
BEARS S15°07'24"W, 58⁹ FT. DISTANT.

A 5/8" X 60" IRON ROD WITH A D.C.S.O. YELLOW PLASTIC CAP SET PROT 10 INCHES;
BEARS S86°52'51"W, 60⁸ FT. DISTANT

BOTH I.R.S ARE IN THE NARROW WEST SHOULDER OF A GRAVEL RD.

CORNER MONUMENT IS NEAR TOP OF STEEP CUTBANK ON EAST SIDE OF A
GRAVEL RD. BURNED OLD GROWTH FOREST TO EAST, VERY LARGE RECENT CLEARCUT
TO WEST.

OCRS N - 222117.831
E - 275937.760

196
6
28756
8760

CS 67161-55 pg 4/4