

GOVERNMENT CORNER RESTORATION FORM

FILED

TOWNSHIP 24S RANGE 3W SEC. 32 PLSS # 240140

Date: 12/11/25 By: ll
This survey consists of:

DOUGLAS COUNTY OREGON

DATE 12-10-25

Map: _____

Narrative: _____

Corner Rpt: CS 67/61-52

Corner Designation

C 1/4 532

DOUGLAS COUNTY
SURVEYOR

Monument(s) Found: (Condition and Source)

5/8" Iron Rod proj 1"

Condition report

Not Found

Renewed

Unrecorded

Surveyed In

Previous Renewals

Gee Set 1978 M 71-56

EDWARDS 2002 M 137-52

MONUMENT DETAIL

Accessories Found

21" X 1 FT SAWN D. FIR STUMP 572°E 12.6 FT
(REC 569°E 12.1 DIST TO FACE) Healed BLAZE
ADD 3 1/2" MAG NAIL TOP CENTER

19" X 2 1/2 FT SAWN D. FIR STUMP N41°W
11.2 FT (REC N146°W 9.5 FT DIST TO FACE)
Healed BLAZE ADD 3 1/2" MAG NAIL TOP
CENTER

New Accessories

8" D. FIR N20E 12.2 FT Scribed C 1/4 552
BT ON Double BLAZE 3 1/2" MAG NAIL
RIGHT Side Center

4" D. FIR S39E 8.7 FT Scribed X BT ON
HIGH-LOW BLAZE 3 1/2" MAG NAIL RIGHT
Side Center

Sketch of Monument, Accessories, and General Area

Location & Comments

Cor on moderate NNE
Slope in older D. FIR
Repro

WAD APPROX 140 FT
EAST OF GRAVE 1
ROAD

AREA BURNED

Trimble Geo XT Position

9-2020
Comp. Decline. 14 1/4° E
Agency DCSO
Party Chief S. F. Huse
Note keeper
Witnesses J. L. Orsany

43.43948107 N

123.07979323 W

CS 67141-52

pg 2/3

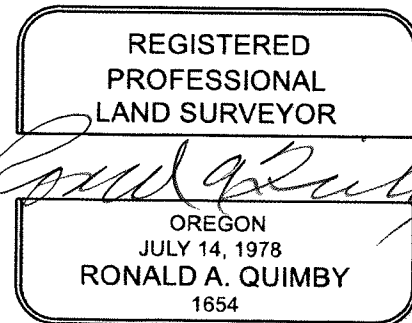

EXPIRES: 12/31/2026

TOWNSHIP 24 RANGE 03 POINT IDENTIFIER # 240100

PRIMARY CORNER DESCRIPTION Center 1/4 Cor. Sec. 32

Alias _____	Description _____
Alias _____	Description <u>TRIMBLE GEO XT POSITION</u>
Alias _____	Description _____
Alias _____	Description <u>43.43948107°N</u>

DECLINATION 14'14" E 123.07979323°W

R.H. Gee - For: Joe Cole & Stan Mohr - June 1978 - M 71-56

RENEWED 12/10/25

PRDT. 1"

MINI GIS

Set by proportionate measure

Set - 5/8" I. Rod ^{72°} ^{12.6}

21" x 1 FT SAWN STUMP 8" D. Fir, S. 69° E., 12.1 ft. HEALED BLAZE SCAR (RECORD DISTANCES) (ARE TO FACE)

19" x 2 1/2 FT SAWN STUMP 8" D. Fir, N. 46° W., 9.5 ft. " " " " " "

SET A 3 1/2" MAG NAIL TOP CENTER IN FOUND STUMPS

NEW REFERENCES:

8" DIA. D. FIR SCRIBED "C 1/4 S 32" "BT" ON A DOUBLE BLAZE; BEARS N 02° E, 12.2 FT. DIST.

4" DIA. D. FIR SCRIBED "X" "BT" ON A HIGH-LOW BLAZE; BEARS S 39° E, 8.7 FT. DIST.

BOTH NEW BT'S HAVE A 3 1/2" MAG NAIL SET R.S.C.

COR. IS ON MODERATE NNE SLOPE IN OLDER D. FIR REPROD.

COR. IS APPROX. 140 FT. EAST FROM GRAVEL ROAD.

M 137-52 EDWARDS

2002