

GOVERNMENT CORNER RESTORATION FORM

FILED

TOWNSHIP 24S RANGE 3W SEC. 21

PLSS # 466340

Date: 12/10/15 By: KE
This survey consists of:

DOUGLAS COUNTY OREGON

DATE 12-2-25

Map: _____

Narrative: _____

Corner Rpt: CS(07)161-5D

Corner Designation

1/4 COR 21/22

DOUGLAS COUNTY
SURVEYOR

Monument(s) Found: (Condition and Source)

2 1/2" BRASS CAP AT BASE
OF BOULDER CAP LEANS
S.E. 1/4 APPROX 0.4 FT

Previous Renewals

GLD 1983 Vol 17 pg 2996
Candler 1964 CS 51/51-5
Baker 1983 1190-48

- Condition report
- Not Found
- Renewed
- Unrecorded
- Surveyed In

MONUMENT DETAIL

T24S R3W
1/4
S21 & S22
PLS 1978
1983

Accessories Found

40" Tipped out D. Fir Root Hole Reasonable
TO RECORD N88°E 34.8 FT

1" Alum pipe set by Weyerhaeuser Co
IN 1964 BEARS N 83°E 13.0 FT (REC
N84°25'51" E 13.47 FT) Replumb 1" Pipe

New Accessories

4" Chinquapin N57°E 22 FT Scribed
 X BT ON HIGH-LOW BLAZE
 8" D Fir S44°E 7.8 FT Scribed 1/4 S22
 BT ON Double BLAZE
 8" D Fir S64°W 2.3 FT Scribed 1/4 S21
 BT ON Double BLAZE
 A 10" D. Fir N8°W 8.1 FT Scribed 1/4
 S21 BT ON Double BLAZE

ALL TREES HAVE 3 1/2" MAG NAILS RIGHT Side Center

Sketch of Monument, Accessories, and General Area

Location & Comments

MON. IS ON GENTLE EAST SLOPE
 AT TOE OF HILL FOR LOGGING
 SPUR ROADS. MON IN OLDER
 REPROD APPROX 40 FT EAST
 OF SHORT LOGGING SPUR NEAR
 ITS NORTH END

~~AREA BURNED~~
 9/2020

Trimble GEO XT Position

Comp. Decline 14 1/2° E
 Agency DCSO
 Party Chief S. Frouse
 Note keeper
 Witnesses J. Loring

42° 46' 45.549" N
 123° 05' 37.978" W

CS67161-50

pg 2/3

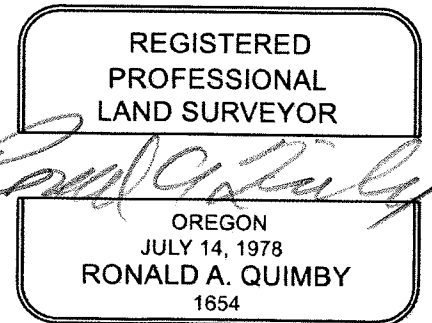

EXPIRES: 12/31/2026

TOWNSHIP 24 RANGE 03 POINT IDENTIFIER # 400340

PRIMARY CORNER DESCRIPTION 1/4 Cor., Secs. 21 & 22

Alias _____	Description _____
Alias _____	Description <u>TRIMBLE GEO XT POSITION</u>
Alias _____	Description _____
Alias _____	Description <u>43.46745549°N</u>
	<u>123.05137978°W</u>

MINI GIS
43.46753
123.05159

GL0 survey by W.H. Byars under contract #152, dated June 3, 1871 - (DCSO records Vol. 7 Page(s) 2954)

Set 1/4 sec. post from which
A fir, 6" dia., bears N.25°E., 11 lks.
A fir, 5" dia., bears S.60°W., 10 lks.

Fd. & used on GL0 survey by L.H. Wheeler under Contract No. 467 dated April 7, 1883 (DCSO records Vol. 7 Page(s) 2996)

WEYCO, Lester E. Calder - April 1964 - C.S. 51/31-5

GL0 survey rec. 1871 - Post - Gone
5" Fir, S.60°W., 10 lks. - Gone
6" Fir, N.25°E., 11 lks. - Gone
Set - 1" alum. pipe for corner by single proportionate method. Ref by Glen McChesney C.S. 53/111-24 (Weyerhaeuser method with disc. #2149, Decl. 20°)
22" Fir N.87°E., 22.0 ft.
16" Fir N.52°W., 41.6 ft.

DECLINATION 14 1/4°E RENEWED 12-09-25

Dan Baker, For: Weyerhaeuser Co. - Dec. 8, 1983 - M90-48

Set - 1 1/4 x 57 iron pipe with brass cap mkd. with standard markings & "PLS 1978"
40 TIPED OUT 30" D. Fir, N.88°E., 34.8 ft. ROOT HOLE REASONABLE BLZ NO LONGER VIS.
GONE - 22" Fir, N.34°W., 32.8 ft. N 83°E
Note - 1" al. pipe set by Weyer. Co. bears N.84°25'51"E., 13.47 ft. THIS PIPE WAS LEANING APPROX. 06 FT SE'LY
13.0 PIPE IS REPLUMBED

2 1/2" BRASS CAP ON PIPE AS DESCRIBED, CAP STAMPED "T24S R3W"
MONUMENT LEANS SE'LY APPROX 0 1/4 FT.
VERY LARGE IMMOVABLE ROCK ON NW EDGE
WEST 1/4 OF BRASS CAP IS BROKEN OFF.
USE WHAT WOULD BE PLUMB POSITION FOR MEASUREMENTS.

1/4
S21 & S22
PLS 1978
1983

NEW REFERENCES:

A 4" DIA. CHINQUAPIN SCRIBED "X" "BT" ON A HIGH-LOW BLAZE; BEARS N57°E, 22° FT. DIST.
AN 8" DIA. D. FIR SCRIBED "1/4 S22" "BT" ON A DOUBLE BLAZE; BEARS S44°E, 78 FT. DIST.
AN 8" DIA. D. FIR SCRIBED "1/4 S21" "BT" ON A DOUBLE BLAZE; BEARS S64°W, 23 FT. DIST.
A 10" DIA. D. FIR SCRIBED "1/4 S21" "BT" ON A DOUBLE BLAZE; BEARS N08°W, 8 FT. DIST.
(ALL NEW B.T.S HAVE A 3 1/2" MAGNAIL SET R.S.C.)
MONUMENT IS ON GENTLE EAST SLOPE AND AT TOE OF FILL FOR A LOGGING SPUR RD. MON. IS IN OLDER REPROD. FIR FOREST APPROX 40 FT. EAST A SHORT LOGGING SPUR RD. NEAR ITS NORTH END. CS 67/61-50 P93/3