

GOVERNMENT CORNER RESTORATION FORM

FILED

TOWNSHIP 24S RANGE 1W SEC. 31 PLSS # 100100

Date: 12-2-25 By: KQ
This survey consists of:

DOUGLAS COUNTY OREGON

DATE 11/20/25

Map: _____

Narrative: _____

Corner Rpt: CS 67161-39

Corner Designation

SW COR S 31

DOUGLAS COUNTY
SURVEYOR

Monument(s) Found: (Condition and Source)

3 1/4" BLM BRASS CAP
proj 4"

Condition report

Not Found

Renewed

Unrecorded

Surveyed In

Previous Renewals

BLM Resurvey 1951-1943

Vol 32 pg 13338

BLM Resurvey 1962 Vol 45 pg 17356

Johnstone 1985 CS 63/26-1

MONUMENT DETAIL

+24S
R1W
S31

+25S R2W

S1

1951

Accessories Found

SAWN BURNED Rotted 24" X 1 1/2 FT FIR STUMP

N 64 1/4° E 44.2 FT

BURNED 10" X 1 1/2 FT CHINGUNPIN STUB S 13 1/4° E

13.2 FT

BURNED DEAD 17" D. FIR S 45° W 102.3 FT Fully

Healed Single BLAZE

25" X 8 FT BURNED Broken So. PINE SPA9

S 80° W 105.9 FT

New Accessories

5/8" X 30" Iron Rod with DCSO plastic cap
N 76° E 8.6 FT proj 4"

5/8" X 30" Iron Rod with DCSO Plastic cap
S 51° W 8.9 FT proj 4"

Burnt. Dead 9" Fir N 87° W 15.7 FT 3 1/2"
Mag Nail Right Side Center

Burnt Dead 7" Fir N 52° W 19.4 FT 3 1/2"
Mag Nail Right Side Center

Sketch of Monument, Accessories, and General Area

Location & Comments

Trimble Geo XT Position
43° 26' 15.25" N
122° 52' 39.631" W

Area Badly
Burnt 9/2020

Comp. Decline. 14 1/4° E
Agency DCSO
Party Chief S. Fause
Note keeper
Witnesses J. Lorusung.

CS 07/01-39

pg 2/3

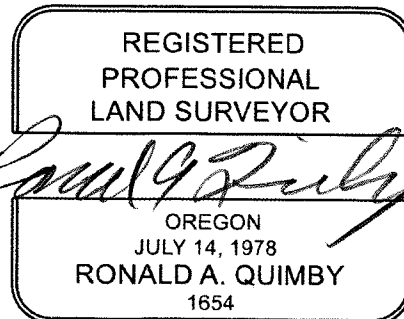

EXPIRES: 12/31/2026

TOWNSHIP 24 RANGE 01 POINT IDENTIFIER # 100100

PRIMARY CORNER DESCRIPTION SW Corner for Sec. 31

Alias	Description
Alias	Description TRIMBLE GEO XT POSITION
Alias	Description
Alias	Description 43° 26' 15.251" W R1
Alias	Description 122° 52' 39.631" N W

DECLINATION 14 1/4° E

RENEWED 11/20/25

Survey by Howard W. Johnstone, LS #498 - For: Roseburg Lumber Co. - Sept. 24, 1985 - C.S. File 63/26-1

SAWN ROTTED BURNED 24"x1 1/2" STUMP
TAKEN OUT BY ROAD WORK
BURNED STUB 10"x1 1/2" FT. 8"
HAS DEAD REGROWTH AT TOP

Found - 2 1/2" Fir N. 64 1/4° E, 44.2 ft. (OBT)

17" Fir N. 18 1/4° E., 27.1 ft. (1951 BIM)

8" Chinquapin S. 13 1/4° E, 13.2 ft. (OBT)

Landing construction eliminated these BTs after the corner was referenced out. Monument and BTs were in the middle of a proposed landing to be constructed in a logging clear cut unit. I referenced out the brass cap and after the landing was built and the unit logged:

I Reset the brass cap from my referenced and scribed 2 BTs to the West which is the only area with remaining timber. Brass cap mkd. by GLO in 1951. Cap was reset in large mound of rocks. 3 1/4" BC MARKED AS DESCRIBED IN 1963 PROT. 4 INCHES IN ROUGH MOUND OF STONE

BURNED DEAD 17"

New BTs - 9" D. Fir S. 45° W, 102.3 ft. scribed S1 L 28 T25S R2W BT. FHSB

BROKEN BURNED SNAG 25"x8 FT. 26"

S. Pine S. 80° W, 105.9 ft. scribed S1 L28 T25S R2W BT. BLAZE GONE, BURNED OUT

Corner sets on a step landing at end of spur road and at base of cut slope for landing. BTs are at toe of road fill slope.

NEW REF. S

A 5/8 INCH X 30 INCH IRON ROD / PC SO SET PROT 4"; BEARS N 76° E, 8 6/8 FT. DIST.
PLSTC. CAP

" " ; BEARS S 51° W, 8 9/8 FT. DIST.

A BURNED DEAD 9" FIR WITH A 3 1/2" MAG NAIL R.S.C.; BEARS N 87° W, 15 7/8 FT. DIST.

A BURNED DEAD 7" FIR WITH A 3 1/2" MAG NAIL R.S.C.; BEARS N 52° W, 14 4/8 FT. DIST.