

GOVERNMENT CORNER RESTORATION FORM

FILED

TOWNSHIP 26S RANGE 3W SEC. 35 PLSS # 540120

Date: 10-7-25 By: KL  
This survey consists of:

DOUGLAS COUNTY OREGON

DATE 9/30/25

Map: \_\_\_\_\_

Narrative: \_\_\_\_\_

Corner Rpt: CS 67161-30

Corner Designation

CS 1/16 S35

DOUGLAS COUNTY  
SURVEYOR

Monument(s) Found: (Condition and Source)

3/4" BLM BRASS CAP  
PROJ 3"

\_\_\_ Condition report

\_\_\_ Not Found

Renewed

\_\_\_ Unrecorded

\_\_\_ Surveyed In

Previous Renewals

BLS Set IN 1981  
Vol 45 pg 17439

MONUMENT DETAIL

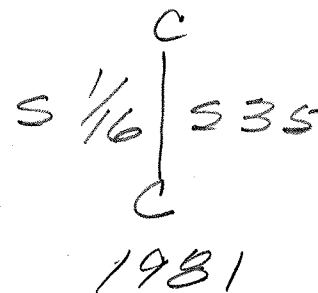

Accessories Found

SAWN Rotted 23" X 3 1/2 FT FIR STUMP N132°E  
6.0 (REC 8 1/2 LKS) TO 3 1/2" MAG NAIL  
RIGHT SIDE CENTER ILLEGIBLE SCRIBES  
ON UNHEATED SINGLE BLAZE

SAWN BURNT 25" X 2 1/2 FT D. FIR STUMP  
N56 1/2°W 19.0 E (REC 29 LKS) TO 3 1/2" MAG  
NAIL RIGHT SIDE CENTER ALL SCRIBES  
VISABLE ON UNHEATED SINGLE BLAZE

BOTH BTS HAVE GALV STEEL CAPS

Monument Set (Procedure and Description)

MONUMENT DETAIL

Horizontal lines for Monument Set description.

New Accessories

Horizontal lines for New Accessories description.

Sketch of Monument, Accessories, and General Area

Location & Comments

DCRS Cottage Grove to  
CANYONVILLE Zone Location

AREA BURNED  
9/2020

43°15'37.99150 N  
123°01'11.86653" W

Comp. Decline. 14'12" E

Agency DCSO

Party Chief S. F. HAUSE

Note keeper

Witnesses J. LORSUNY

CS 67/61-30

pg 2/3

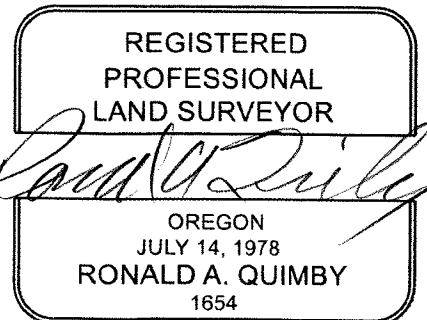

EXPIRES: 12/31/2026

from which bearing trees mkd. by Vernon R. Tracy, Deputy County Surveyor, in 1966

A pine, 20 ins. diam., bears N. 13 1/2° E., 106 lks. dist., with healed blaze. (Record, N. 12° E.)

A cedar, 12 ins. diam., bears N. 2° W., 27 lks. dist., with healed blaze.

The corner is located at intersection of wire fences, extending N., S., and W.

Land, mountainous.  
Soil, rocky clay.  
Timber, pine, cedar, fir, oak, madrone, yew, alder, ash, maple, and hemlock; undergrowth, poison oak, vine maple, blackberry, salmonberry, huckleberry, wild rose, wild plum, arrowwood, manzanita, rhododendron, hazel, Oregon grape, fern, and young timber.

Subdivision of Section 35,  
T. 26 S., R. 3 W., Willamette Meridian, Oregon

From the 1/4 sec. cor. of secs. 2 and 35, on the S. bdy. of the Tp.

N. 0° 02' E., on the N. and S. center line of sec. 35.

Descend 100 ft. over NW. slope, across open logged area.

3.30

Creek, 5 lks. wide, course S. 25° W.; asc. 285 ft. over broken S. slope.

7.15

Enter moderate timber and undergrowth, edge bears N. 70° W. and S. 70° E.

19.95

Point for the center S 1/16 sec. cor. of sec. 35.

Set an iron post, 28 ins. long, 2 1/2 ins. diam., 24 ins. in the ground, with brass cap mkd.

3 1/4" B.C.

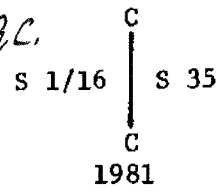

PROT 3"

from which

ROTTED SAWN STAMP 23" x 3 FT

A fir, ~~28~~ ins. diam., bears N. 32° E., 8 1/2 lks. dist., mkd. C-S 1/16 S 35 BT. ILLEGIBLE

SAWN BURNED 25" x 2 1/2 FT

A fir, 25 ins. diam., bears N. 56 1/2° W., 29 lks. dist., mkd. C S 1/16 S 35 BT. ALL VISIBLE UHEALED SB

BOTH END BT'S HAVE GALV. STEEL CAPS

Ascend 40 ft. over SW. slope.

OCRS CANYONVILLE COTTAGE GROVE POS

43° 15' 37.99150" N

123° 01' 11.80653" W

26-3-540120

RENEWED 9/30/25

5/8" 6" TO 3 1/2" MAG NAIL R.S.C.

1 1/4" 19" TO 3 1/2" MAG NAIL R.S.C.

CS 67161-30