

TOWNSHIP 26S RANGE 3W SEC. 12

PLSS # 700503

Date: 10/7/25 By: KL
This survey consists of:

DOUGLAS COUNTY OREGON

DATE 9/25/25

Map: _____

Narrative: _____

Corner Rpt: CS 67161-29

Corner Designation

R3W R2W

DOUGLAS COUNTY
SURVEYOR

SEC 60E 12/7
13/18

Monument(s) Found: (Condition and Source)

___ Condition report

3 1/2" 1959 BLM BRASS

___ Not Found

CAP Proj 6"

Renewed

___ Unrecorded

Previous Renewals

___ Surveyed In

GLD 1879 Vol 10 pg 4383

GLD 1913 Vol 10 pg 4251-52

BLM Survey 1959 Vol 30 pg 1272-23

DCSO 1978 CS 59/46-15

DCSO 2007 CS 67/24-47

BLM Resurvey 2015 V 58 pg 23487

MONUMENT DETAIL

T26S
R3W R2W
512/57
513/518
1959

Accessories Found

Burnt 53" X 70 FT D. FIR SNA9 N169 1/4 E

73.3 FT WITH HEATED BLAZE

Burnt SAWN 32" M/L CEDAR STUMP S69 1/2 E

39.9 FT BLAZE BURNT AWAY

Burnt 26" X 16" TALL CEDAR SNA9 S70 1/4 W

31.7 FT BLAZE BURNT AWAY

Burnt 34" X 75" TALL CEDAR SNA9 N57 W 32.3

FT HEATED BLAZE

Add 3 1/2" MAG NAIL RIGHT SIDE CENTER TO

SNA9 BT'S

2 1/2" steel post with BRASS CAP S32°43'48"W

20.40 FT FOR REF MON. MARKED RM1 S13 T26S

R3W 20.4 FT TO CORNER 2015 ARROW POINTING

TO CORNER

2 1/2" steel post with BRASS CAP N70°38'34"W

41.6 FT MARKED RM2 T26S R3W S12 41.6 FT TO

CORNER 2015 WITH ARROW POINTING TO CORNER

New Accessories

Sketch of Monument, Accessories, and General Area

Location & Comments

OCRS Cottage Grove To
 Canyonville zone position
 43° 18' 52.61354 N
 122° 59' 28.63791 W

MORON Gentle NAIN
 Slope Clear Cut
 IN NW & SE QUADS
 Very old BURCH
 Forest REST
 AREA BURN +
 9/2020
 Comp. Decline. 14 1/4" E
 Agency DLSD
 Party Chief S. F. ANSC
 Note keeper
 Witnesses J. L. SULLIVAN

CS 67161-29

pg 2/4

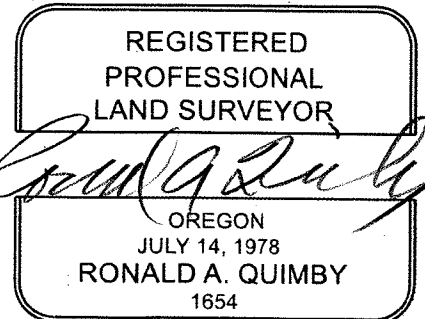

EXPIRES: 12/31/2026

TOWNSHIP 26 RANGE 03 POINT IDENTIFIER # 700500

PRIMARY CORNER DESCRIPTION Sec. Cor. for 12 & 13; 7 & 18 of T26-2

Alias _____ Description _____
 Alias _____ Description OCCRS CANYONVILLE COTTAGE GROVE POSITION
 Alias _____ Description _____
 Alias _____ Description 43°18'52.61354"N
122°59'28.63791"W

A rotted cedar snag, 44" dia., bears N.60°E., 23 lks., with no marks remaining.
 A Hemlock 26" dia., bears N.40°W., 16 lks., with illegible scribe marks visible on a partially opened and rotted blaze.
 At the corner point: set an iron post, 28" long, 2½" dia., 20" in the ground, and in a mound of stone, 1½ ft. base, to top, with brass cap mkd:

T 26 S			
3¼" B.C.	R 3	W R 2	W
	S 12	S 7	✓
	S 13	S 18	PROT 6"

1959 from which

A Fir 50" dia. bears N.59¼°E., 111 lks mkd. T26S R2W S7 BT
 A Cedar 24" dia., bears S.69½°E., 60½ lks., mkd. T26S R2W S18 BT.
 A Cedar 16" dia., bears S.70½°W., 48 lks., mkd. T26S R3W S13 BT.
 A Cedar 16" dia., bears N.57°W., 49 lks., mkd. T26S R3W S12 BT.

Doug. County Surveyors Office - Condition report of corner, Found brass cap 6 accessories. Jan. 10, 1978 - C.S. 59/46-15.

Douglas Co. Surveyors Office - Stephen J. Flause - John Pike - 11/28/2007 - C.S. File 67/24-47

Found ok, all BTs from 1959 BLM renewal are fd. as per record. OBTs now gone.

BLM dependent resurvey by Joel R Herzberg, Cadastral Surveyor under Group No. 2817, surveyed Oct./Nov. 2015 - (DCSO records Vol. 58 Page(s) 23487 & Plat T26-2 2017-1)

The cor. of secs. 7, 12, 13, & 18, on the W. bdy. of the Tp., monumented with an iron post, 2½" dia., firmly set, projecting 8" above the ground (alongside of which is the stone set by Collier in 1913-14, 14x10x6" with no marks visible), in a mound of stone, 3 ft. base, to the top, with brass cap (properly) mkd. SEE ABOVE EAST SIDE

from which the remains of the BTs mkd by Zirpel & Glenn in 1959

70 FT. TALL 53" A burnt fir snag, 56" dia., bears N.59¼°E., 73.3 ft., with a healed blaze ✓ 32" M/L x 3 FT TALL

A burnt sawed cedar stump size indeterminate, bears S.69½°E., 39.9 ft., with illegible scribe marks visible on a partially opened blaze. BLAZE GONE BURNED AWAY

16 FT TALL 26" A burnt cedar snag, 29" dia., bears S.70½°W., 31.7 ft., with a healed blaze. continued next page

BLAZE GONE BURNED AWAY

70 FT. TALL

16 FT TALL

TOWNSHIP 26 RANGE 03 POINT IDENTIFIER # 700500

PRIMARY CORNER DESCRIPTION Sec. Cor. for 12 & 13; 7 & 18 of T26-2

Alias _____	Description _____
Alias _____	Description _____
Alias _____	Description _____
Alias _____	Description _____

*ADD 3 1/2" MAG NAILS (GET AT RECORD DIST) R.S.C.
TO SNAG B.T.S*

75 FT TALL burnt cedar snag *3 1/2"* dia., bears N.57°W, 32.3 ft., with a healed blaze and new reference monuments

A stainless steel post, 28" long, 2 1/2" dia., set 22" in the ground in a mound of stone, 2 ft. base ~~to the top~~, for a reference monument, bears S.32°43'48"W, 20.40 ft., with brass cap mkd. RM1 S13 T26S R3W 20.4 FT TO COR 2015 and an arrow pointing to the cor. *PROT 2"*

A stainless steel post, 28" long, 2 1/2" dia., set 22" in the ground, in a mound of stone, 2 ft. base ~~to the top~~, for a reference monument, bears N.70°38'34"W, 41.6 ft., with brass cap mkd. RM2 T26S R3W S12 41.6 FT TO COR 2015 and an arrow pointing to the cor. *PROT 2"*

Drive an ~~aluminum~~ *GALV. STEEL* angle iron, 5 ft. long, alongside the cor. *NORTH EDGE*

Latitude 43°18'52.60"N. Longitude 122°59'28.57"W.

*ON VERY GENTLE NNW SLOPE
NEWER CLEARCUT IN NW & SE QUADRANTS; REST VERY OLD, NOW
BURNED FOREST.*